

Important Safety Instructions

When using this product, basic precautions should always be followed:

- Use of a power supply or charger not recommended or sold by the product manufacturer may result in a risk of fire or personal injury.
- Operating temperature should be between 5°C to 35°C / 41°F to 95°F.
- It is recommended to supply the product in an environment with a temperature that ranges from 41°F-77°F/5°C-25°C.
- When supplying, place the device in an environment that has a normal room temperature and good ventilation.
- Do not disassemble this product. Take it to a qualified service person when service or repair is required. Incorrect reassembly may result in a risk of fire or personal injury.
- CAUTION: Risk of explosion if the battery is replaced by an incorrect type.
- To reduce the risk of injury, close supervision is necessary when the product is used near children.
- Do not expose product to rain or snow.
- Do not use the product that is damaged or modified. Damaged or modified batteries may exhibit unpredictable behavior resulting in fire, explosion or risk of injury.
- Do not expose the product to fire or excessive temperature. Do not use the product in an environment where the temperature is too high or too low. Never expose the product to strong sunshine or wet environments.
- Switch off the product when not in use.
- CAUTION: Risk of Fire and Burns. Do Not Open, Crush

9

or incinerate. Follow Manufacturer's Instructions.

Warning:

- Replacement of a battery with an incorrect type that can defeat a safeguard;
- Disposal of a battery into fire or a hot oven, or mechanically crushing or cutting of a battery, that can result in an explosion;
- Leaving a battery in an extremely high temperature surrounding environment that can result in an explosion or the leakage of flammable liquid or gas; and
- A battery subjected to extremely low air pressure that may result in an explosion or the leakage of flammable liquid or gas.

Attention:

- Remplacement d'une batterie par un type incorrect pouvant supprimer une protection;
- Mise au rebut d'une batterie dans un feu ou dans un four chaud, ou écrasement mécanique ou coupure d'une batterie, susceptible de provoquer une explosion;
- Maintien d'une batterie dans un environnement à très haute température pouvant provoquer une explosion ou la fuite de liquide ou de gaz inflammables; et
- Batterie soumise à une pression de l'air extrêmement faible pouvant provoquer une explosion ou la fuite de liquide ou de gaz inflammables.



CAUTION: RISK OF EXPLOSION IF BATTERY IS REPLACED BY AN INCORRECT TYPE. DISPOSE OF USED BATTERIES ACCORDING TO THE INSTRUCTIONS.

10



ATTEN
BATTERIE
INCORRETE
SELON

Notice (Europe)

This product is CE marked.

Declaration of

Hereby, Anker device is in conformance with CE and other relevant standards. For the Declaration of Conformity, please visit: <https://support.anker.com/declaration-of-conformity>

The suitability of accessories is not guaranteed.

The following for EU matters: Anker Innovations GmbH, Georg-Mueller-Str. 14, 70639 Stuttgart, Germany



Your product is made with recycled materials.



This symbol indicates that the product is not for recycling and should be disposed of according to local regulations.

At a Glance

1. Front View

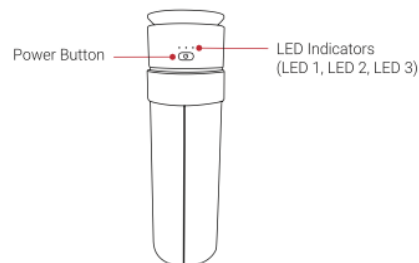

- Power Button: Press to check the battery level
- LED Indicators: Display the battery level and charging status

2. Rear View

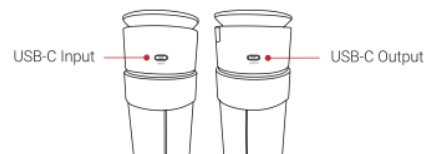

1

3. Top View

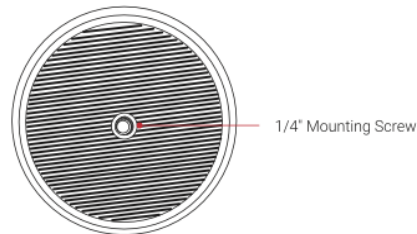

4. Bottom View

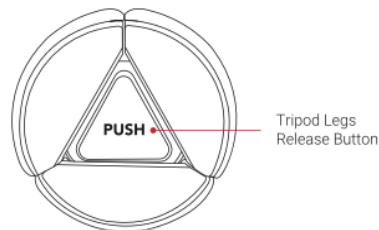

2

How to Use

Bank

Set Up

- Press the power button.



- Push the legs.



ATTENTION RISQUE D'EXPLOSION SI LA BATTERIE EST REMPLACÉE PAR UN TYPE DIFFÉRENT. ÉLIMINER LES BATTERIES USÉES SELON LES INSTRUCTIONS.

United Kingdom

This product complies with the radio interference requirements of the European Community.

CE Conformity

Innovations Limited declares that this product complies with the essential requirements of the EMC Directive 2014/53/EU. For more information on Declaration of Conformity, visit the Web site: <http://www.seenebula.com/s/articleRecommend?ad&secondType=doc>.

Operating temperature range for the product and its accessories is 5°C-35°C.

The importer is the responsible party (contract details):
 Innovations Deutschland GmbH |
 -Strasse 3, 80807 Munich, Germany

This product is designed and manufactured using high quality materials and components, and can be recycled and reused.

The recycling symbol means the product must not be disposed of as household waste, and should be taken to an appropriate collection facility for recycling. Proper disposal and recycling help protect natural resources, human

health, and the environment. For more information on disposal and recycling of this product, contact your local municipality, disposal service, or the shop where you bought this product.

Notice (United States of America) FCC Statement

This device complies with Part 15 of the FCC Rules. Operation is subject to the following two conditions: (1) this device may not cause harmful interference, and (2) this device must accept any interference received, including interference that may cause undesired operation.

Warning: Changes or modifications not expressly approved by the party responsible for compliance could void the user's authority to operate the equipment.

Note: This equipment has been tested and found to comply with the limits for a Class B digital device, pursuant to Part 15 of the FCC Rules. These limits are designed to provide reasonable protection against harmful interference in a residential installation.

This equipment generates uses and can radiate radio frequency energy and, if not installed and used in accordance with the instructions, may cause harmful interference to radio communications. However, there is no guarantee that interference will not occur in a particular installation. If this equipment does cause harmful interference to radio or television reception, which can be determined by turning the equipment off and on, the user is encouraged to try to correct the interference by one or more of the following measures: (1) Reorient or relocate the receiving antenna. (2) Increase the separation between the equipment and receiver. (3) Connect the equipment into an outlet on a circuit different from that to which the receiver is

connected. (4) Consult the dealer or an experienced radio/TV technician for help.

Notice: Shielded cables

All connections to other computing devices made using shielded cables to maintain conformance with FCC regulations.

The following importer is the responsible party:
 Company Name: Fantasia Trading LLC
 Address: 5350 Ontario Mills Pkwy, Suite 100 91764
 Telephone: 1-800-988-7973

Notice (Canada) IC Statement

This device complies with Industry Canada licence-exempt RSS standard(s). Operation is subject to the following two conditions:

- 1) this device may not cause interference, and
- 2) this device must accept any interference, including interference that may cause undesired operation.

L'exploitation est autorisée aux deux conditions suivantes:

- 1) l'appareil ne doit pas produire de brouillage
- 2) l'utilisateur de l'appareil doit accepter tout brouillage radioélectrique subi, même si le brouillage est susceptible d'en compromettre le fonctionnement.

This Class B digital apparatus complies with ICES-003.

Cet appareil numérique de la classe B est conforme de la norme NMB-003 du Canada.

How to Use the Power Tripod

How to Use the Tripod

Press the release button to unfold the tripod



Slide the lever outwards to fully extend the

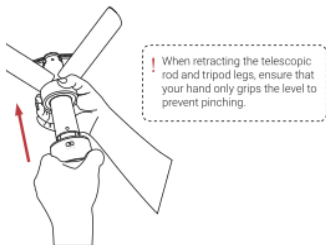

- Place the tripod on a flat and level surface. You can also adjust the telescopic rod to the desired height by gently pulling it upwards.

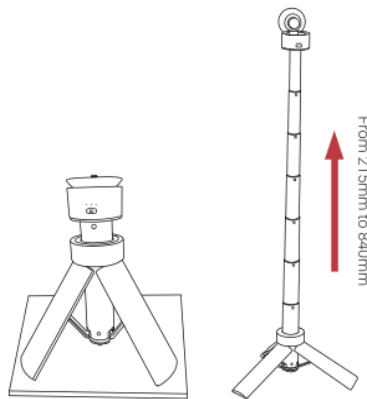

- Lift up the tilt-adjustable mounting plate. Align the projector's tripod socket with the mounting screw, then tighten the lock knob to secure the projector.

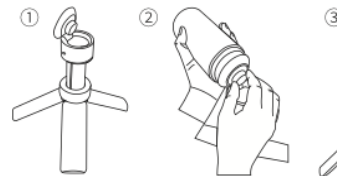

Tips

- The tilt angle of the mounting plate can be adjusted from 0 to 90 degrees.

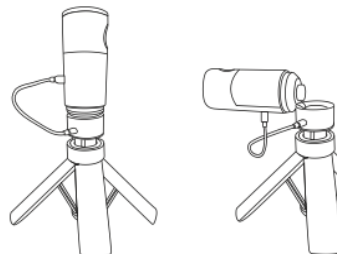

erenced

must be
pliance

arty.

, Ontario, CA

is subject to

nd
including
ation of the

ons

ie, et
t brouillage
:st
ement.

h Canadian

onforme à la

13

SPECS

Lithium Battery Energy	4800mAh 7.2V DC / 34Wh (2 cells in series)
Cell Capacity	9600mAh
USB-C Input	20V=2.25A 45W
USB-C Output	5V = 3A, 9V = 3A, 12V = 2.5A, 20V = 1.5A 30W MAX (Bypass with adapter 20V/2.25A 45W minimum)
Protection	OCP/OVP/OTP/ESD
Applicable Ambient Temperature	5°C ~ 35°C (Room Ambient)
Product Size	66.5x66.5x216mm
Height	216mm-840mm (Max.)
Compatible Model	Nebula Capsule Air/Capsule 3 /Capsule 3 Laser
Tripod Legs Extension	Length of Telescopic Rod: 297mm Length of Tripod Leg Spreaders: 447mm
Weight	916g
Tilt Degree	0°-90°
Weight Load	<1.5Kg

Battery Life

Play Mode	Nebula Capsule Air	Nebula Capsule 3	Nebula Capsule 3 Laser
Standard	+1.5 hours	+1.0 hours	+1.0 hours
ECO	+2.0 hours	+1.5 hours	+1.2 hours

14

LED Indication

	Battery C (%)	LED 1	LED 2	LED 3
When Being Charged	Full	○	○	○
	67% ≤ C < 100%	○	○	◐
	33% ≤ C < 66%	○	◐	●
	C < 33%	◐	●	●
When Charging the Projector	C ≥ 67%	○	○	○
	33% ≤ C < 67%	○	○	●
	3% ≤ C < 33%	○	●	●
	0% ≤ C < 3%	◐	●	●
	C = 0%	●	●	●

Note: ○ stands for light on; ◐ stands for light flashing; ● stands for light off

Support

Please scan the QR code below for more support information.



P
Rac

plate.
with the
ocking

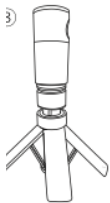

ranges



5

- For additional stability on uneven terrain, or when using the tripod with heavier devices like Nebula Capsule 3 and Nebula Capsule 3 Laser, you can extend the tripod leg spreaders for a firmer grip on the ground.

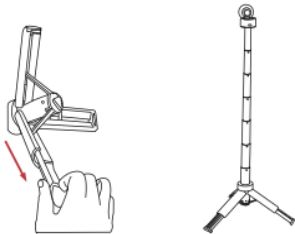

Power the Projector

- Use the provided C-C Cable to connect the projector with the power bank tripod.

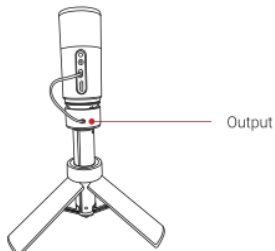

6

- When the projector is connected to the power bank tripod, you can simultaneously connect the power bank tripod to an electronic outlet using an adapter (not included). **This setup allows for simultaneous use and charging of both the projector and the power bank tripod.**

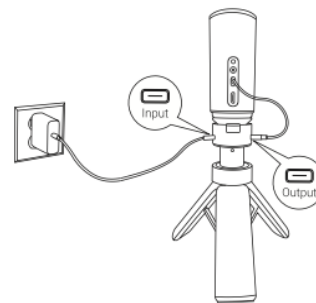

7

Ch
To
• |



NEBULA

by Anker

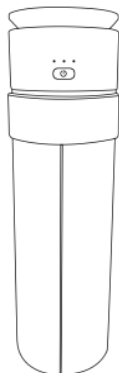

Nebula Power Bank Tripod Quick Start Guide

AP 22
ccolta Carta



FR
Cet appareil,
ses accessoires,
piles et cordons
se recyclent

A DÉPOSER
EN MAGASIN

A DÉPOSER
EN DÉCHÈTERIE

Points de collecte sur
www.quefairedemesdechets.fr

Charge the Power Bank Tripod

Charge the power bank tripod:
Fold up the tripod.

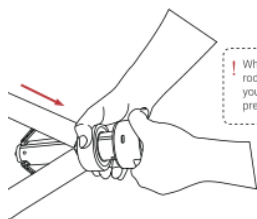

! When retracting the telescopic rod and tripod legs, ensure that your hand only grips the level to prevent pinching.

Use an adapter to connect the power bank tripod with an electronic outlet.

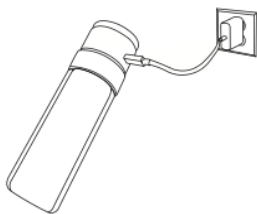

8

NEBULA

by Anker

✉ support@seenebula.com
support@anker.com (日本)
support.mea@seenebula.com
(For Middle East and Africa Only)
ced-cn@anker.com (中国)

☎ +1 (800) 988 7973 (US/Canada)
+44 (0) 1604 936200 (UK)
+49 (0) 69 9579 7960 (DE)
+971 529750842 (Middle East & Africa)
+971 8000320817 (UAE)
+966 8008500030 (KSA)
+965 22069086 (Kuwait)
+20 8000000826 (Egypt)
+61 3 8331 4800 (AU)
+90 (850) 460 14 14 (TR)
+8 (800) 511-86-23 (RU)
+86 400 0550 036 (中国)
03 4455 7823 (日本)
+82 02-1661-9246 (한국)
+91 18003138831 (India)
+886 801 491310 (中国台湾)

© Anker Innovations Limited. All rights reserved.
NEBULA and the NEBULA logo are trademarks of Anker Innovations Limited, registered in the United States and other countries.
Model: D4112

For a detailed user manual and more information, scan the QR code or visit:

support.seenebula.com/s



51005004850 V01