

**Shark™**  
**FlexBreeze™**  
**Pro Mist Fan**  
**FA300 Series**

**OWNER'S GUIDE**

---



# IMPORTANT SAFETY INSTRUCTIONS

SUITABLE FOR OUTDOOR USE & HOUSEHOLD USE ONLY.

**NOTE:** Before every use, empty and rinse the misting hose and water tank to prevent stagnant water from being misted.

## WARNING

**TO REDUCE THE RISK OF FIRE, ELECTRIC SHOCK, OR INJURY: READ ALL THESE INSTRUCTIONS BEFORE USE.**

 **The misting accessory is suitable for OUTDOOR USE ONLY.**

**DO NOT attempt to mist indoors as this could cause slippery conditions or water damage.**

1. This appliance is operated by a rechargeable battery. ONLY recharge the battery with the charger supplied with the unit, battery charger for use only with model GQ36-120300-AUO power supply from Dongguan Gangqi Electronics Co., Ltd. or with model AJJ3-1 from Anlian. A charger that may be suitable for one type of battery may create a risk of fire when used with another battery.
2. **Do not** attempt to destroy, remove, or disassemble the battery pack from the machine. Do not incinerate battery cells. Consult your local waste authority for information regarding available recycling and/or disposal options.
3. To reduce the risk of an electric shock, connect only to an outlet provided with a ground fault circuit interrupting (GFCI) device.
4. The fan should be used on a stable and level surface.
5. Never use this fan near pools, bathtubs, showers, basins, or other vessels containing water.
6. **Do not** operate any unit with a damaged power supply wire or battery charger. Discard the unit or return to an authorized service facility for examination and/or repair.
7. **Do not** run cord under carpeting. Do not cover charge cord with throw rugs, runners, or similar coverings. Do not route charger cord under furniture or appliances. Keep charger cord away from high-traffic areas. Place charger in an area where the cord will not be tripped over.
8. If the charger cord is damaged, it should be replaced.
9. This appliance is not intended for use by anyone (including children) with reduced physical, sensory, or mental capabilities, or lack of experience and knowledge, unless they have been given supervision or instruction concerning use of the appliance by a person responsible for their safety.
10. Children should be supervised to ensure that they do not play with the appliance.
11. Cleaning and user maintenance shall not be made by children without supervision.
12. Prior to cleaning or other maintenance, the appliance must be unplugged from the electrical outlet.
13. Only use Shark branded accessories.
14. **Do not** use if appliance is not working as it should, or has been dropped, damaged, left outdoors for extended periods of time in poor weather without the protective cover applied or dropped into water.
15. Turn off all controls before plugging in or unplugging the appliance.
16. Unplug from electrical outlet when not in use and before any maintenance or cleaning.
17. Hand wash exterior/hard plastic/non-electronic parts with water only. **Do not** immerse. Cleaning with chemicals could damage the unit.
18. **Do not** attempt to repair or adjust any electrical or mechanical functions of this appliance, as this may cause danger and void the warranty.
19. Remove and immediately recycle or dispose of used batteries according to local regulations and keep away from children. **Do not** dispose of batteries in household waste or incinerate.
20. Even used batteries may cause severe injury or death.
21. Call a local poison control center for treatment information.
22. Non-rechargeable batteries are not to be recharged.
23. **Do not** force discharge, recharge, disassemble, heat above 140°F (60°C) or incinerate. Doing so may result in injury due to venting, leakage, or explosion resulting in chemical burns.
24. Ensure the batteries are installed correctly according to polarity (+ and -).
25. **Do not** mix old and new batteries, different brands or types of batteries, such as alkaline, carbon-zinc, or rechargeable batteries.
26. Remove and immediately recycle or dispose of batteries from equipment not used for an extended period of time according to local regulations.
27. Always completely secure the battery compartment. If the battery compartment does not close securely, stop using the product, remove the batteries, and keep them away from children.
28. Never attempt to mist substances other than filtered or clean tap water. **Do not** use warm or hot water. Only use cold or room temperature water.
29. **Do not** handle live electrical products while in range of the misting stream.
30. Keep non-waterproof electronic equipment and appliances out of the misting stream.
31. **WARNING: CHOKING HAZARD.** Always keep nozzles and any other small parts out of the reach of children.
32. **Do not** apply any fragrance or scented products onto any part of the fan during use or maintenance.
33. Always follow the warning information on the batteries and in the manuals of devices.
34. Only use the recommended battery types.

35. Keep batteries away from children.
36. Unpacked batteries shall not lie about in bulk.
37. In case of battery change always replace all batteries with new ones of identical type and brand.
38. **Do not** swallow batteries.
39. **Do not** throw batteries into water.
40. **Do not** throw batteries into fire.
41. Avoid deep discharge.
42. **Do not** short-circuit batteries.
43. Use recommended charging time and current.
44. **Do not** open or disassemble batteries.
45. **Do not** expose the remote to long periods of rain or moisture.
46. **Do not** direct mist toward electrical wiring or devices.

### COIN CELL BATTERY REMOTE MODELS

1. This appliance comes with a remote control which contains a coin cell battery. Dispose of batteries properly. Always keep batteries away from children (choke hazard). Even used batteries can cause injury.
2. Compatible battery type is CR2025.
3. The nominal battery voltage is 3V.

### AAA BATTERY REMOTE MODELS

1. This appliance comes with a remote control which is suitable for 2 AAA batteries. Dispose of batteries properly. Always keep batteries away from children (choke hazard). Even used batteries can cause injury.
2. Compatible battery type is AAA.
3. The nominal battery voltage is 1.5V.

 **WARNING: Not suitable for use with solid-state speed controls.**

### LITHIUM BATTERY SAFETY WARNINGS

LITHIUM BATTERIES STORE A LARGE AMOUNT OF ENERGY AND WILL VENT FIRE OR EXPLODE IF MISTREATED.

1. DO NOT DO ANY OF THE FOLLOWING TO THE BATTERY PACK:
  - a. Open
  - b. Drop
  - c. Short-circuit
  - d. Puncture
  - e. Incinerate
  - f. Expose to temperatures
2. Keep battery pack dry.
3. Charge battery pack only according to its charger's instructions.
4. Inspect battery pack before every use: do not use or charge if damaged.

### BATTERY REMOVAL AND DISPOSAL

This product contains an integral lithium battery (not replaceable), and the remote control uses a lithium coin battery (replaceable) or 2 AAA batteries (replaceable). When the remote batteries no longer have charge, they should be removed from the remote and recycled. DO NOT incinerate or compost the product with its integral battery or the remote batteries. When your remote battery needs to be replaced, dispose of it or recycle it in accordance with local ordinances or regulations. In some areas, it is illegal to place spent lithium batteries in the rubbish or in a municipal solid waste stream. Return spent batteries to an authorized recycling center or to retailer for recycling. Contact your local recycling center for information on where to drop off the spent battery.

### POWER SUPPLY SAFETY

1. Read and follow all instructions that are on the product or provided with the product.
2. Do not use an extension cord.
3. Do not use within 10 feet of pool and do not use in a bathroom.
4. **WARNING: Risk of Electric Shock.** When used outdoors, install only to a covered Class A GFCI protected receptacle that is weatherproof with the power unit connected to the receptacle. If one is not provided, contact a qualified electrician for proper installation. Ensure that the power unit and cord do not interfere with closing the receptacle cover.

### FCC WARNINGS

**Note:** This equipment has been tested and complies with the limits for a Class B digital device - pursuant to part 15 of the FCC Rules. These limits are designed to provide reasonable protection against harmful interference in a residential installation. This equipment generates, uses, and can radiate radio frequency energy, and if not installed and used in accordance with the instructions, may cause harmful interference to radio communications.

To see if this equipment interferes with radio or television reception, try turning the equipment off and on.

To correct any interference:

- Reorient or relocate the receiving antenna.
- Increase the distance between the equipment and the receiver.
- Connect the equipment to a different outlet than the receiver.
- Consult the dealer or an experienced technician for help.

This device complies with Part 15 of the FCC Rules. Operation is subject to two conditions:

1. This device may not cause harmful interference, and
2. this device must accept any interference received, including interference that may cause undesired operation.

**Caution:** Any changes or modifications to this unit not expressly approved by the party responsible for compliance could void the user's authority to operate the equipment.

### IC statement:

This device contains licence-exempt transmitter(s)/receiver(s) that comply with Innovation, Science and Economic Development Canada's licence-exempt RSS(s). Operation is subject to the following two conditions:

1. This device may not cause interference.
2. This device must accept any interference, including interference that may cause undesired operation of the device.

## WARNING

- **INGESTION HAZARD:** This product contains a button cell or coin battery.
- **DEATH** or serious injury can occur if ingested.
- A swallowed button cell or coin battery can cause **Internal Chemical Burns** in as little as **2 hours**.
- **KEEP** new and used batteries **OUT OF REACH OF CHILDREN**.
- **Seek immediate medical attention** if a battery is suspected to be swallowed or inserted inside any part of the body.



**READ AND SAVE THESE INSTRUCTIONS**

## CAR CHARGER

### INSTRUCTIONS FOR USE:

1. Firmly insert the car charger plug into a 12-volt outlet in your vehicle.
2. Insert the charger connector into the charging port on the underside of the fan head, between the 4 support legs.

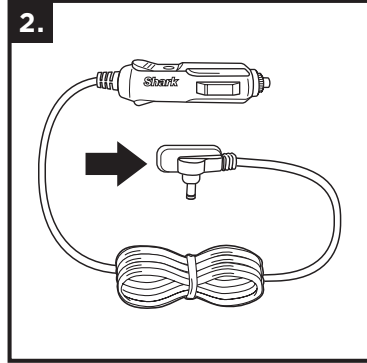
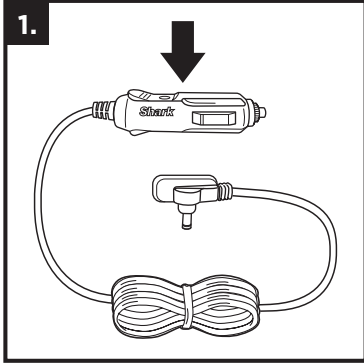

### ⚠ IMPORTANT SAFETY INSTRUCTIONS

#### READ ALL INSTRUCTIONS BEFORE USE

1. **SAVE THESE INSTRUCTIONS.** This manual contains important safety and operating instructions for battery charger model FA20XCAR from Dongguan City Gangqi Electronics Co., Ltd.
2. Before using this battery charger, read all instructions and cautionary markings on the battery charger, battery, and product using battery.
3. **CAUTION:** To reduce risk of injury, charge only the provided rechargeable battery. Other types of batteries may burst, causing injury to persons and damage.
4. **Do not** expose charger to rain, moisture, or snow.
5. Use of an attachment not recommended or sold by the battery charger manufacturer may result in a risk of fire, electric shock, or injury to persons.
6. To reduce risk of damage to cigarette lighter connector and cord, pull by cigarette lighter connector rather than cord when disconnecting charger.
7. To reduce risk of electric shock, unplug charger before attempting any maintenance or cleaning. Turning off controls will not reduce this risk.
8. **Do not** operate charger with damaged cord or cigarette lighter connector. Replace it immediately.
9. The car charger may be wiped clean with water once removed from the power socket. Allow car charger to fully dry prior to use.
10. The car charger contains a 5-amp replaceable fuse. Only replace the fuse with a 5-amp fuse, no higher. To do so, unscrew the chrome knob at the top end of the car charging port to access the fuse.

#### READ AND SAVE THESE INSTRUCTIONS

## FAN COVER

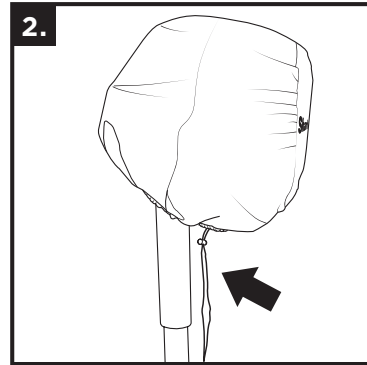
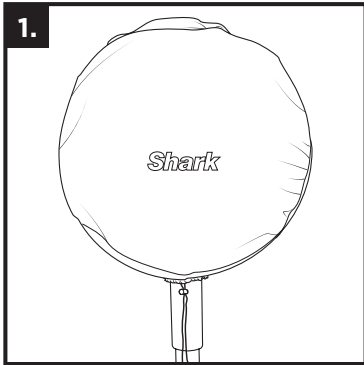

### INSTRUCTIONS FOR USE:

1. Position the cover over fan head, then slide it on until the fan is completely covered.
2. Cinch the drawstring on the bottom of the cover to secure it in place.

### ⚠ IMPORTANT SAFETY INSTRUCTIONS

#### READ ALL INSTRUCTIONS BEFORE USE

1. **WARNING: CHOKING HAZARD.** The fan cover is not a toy. Always keep small parts out of reach of children.
2. Children should be supervised to ensure that they **DO NOT** play with the fan cover as it may become unsanitary during outdoor use.

## WHAT'S INCLUDED



**Base**



**Fan Head**  
(already assembled)



**Water Tank**



**Pole**

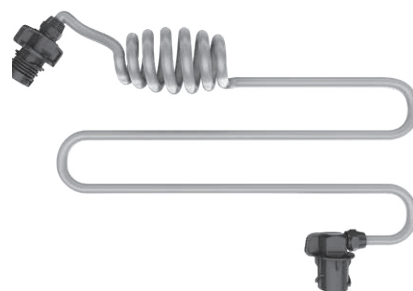

**Misting Hose**



**Remote**



**Allen Wrench**



**Bolt**

**Note:** Images enlarged for clarity.



**Charger**  
(reference image only)

## ACCESSORIES AVAILABLE FOR PURCHASE

Different fan models come with different accessories. To purchase an accessory that was not included, go to [sharkclean.com](http://sharkclean.com).



**Car Charger**



**Fan Cover**



**Travel Bag**



**Base Cover**



**Garden Hose Adapter**



**Travel Tank**



**Bucket Filter Adapter**



# ASSEMBLING YOUR FAN

## COIN CELL BATTERY REMOTE MODELS

Remove the battery saver paper from the remote.

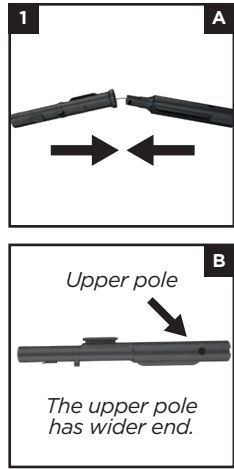

1. Align and insert the **Upper Pole** into the **Lower Pole** until it clicks into place.



2. Align the yellow dot on the assembled pole with the yellow arrow on the **Base**, then slide the pole down onto the base. Ensure that the pole is fully against the base before proceeding.

## AAA BATTERY REMOTE MODELS

- Slide the battery cover off the rear side of the remote.
- Place the 2 AAA batteries in the remote - ensure that the batteries are placed in the remote with the correct polarity (+ and -).
- Replace the battery cover by sliding it into the remote.

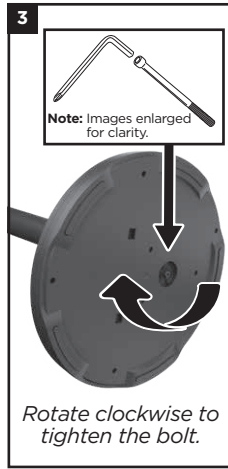
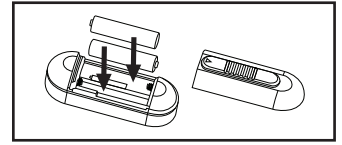

3. Turn the base on its side, then insert the **Bolt** in the bottom of the base. Use the **Allen Wrench** to turn the bolt clockwise to fasten it to the assembled pole.

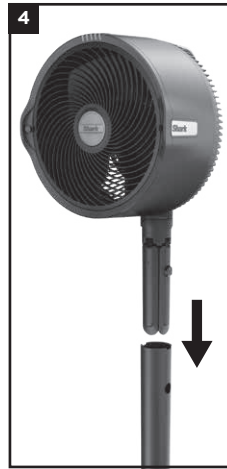

4. **CAUTION:** finger pinch risk. Holding the **Fan Head** by the handle, insert the legs into the top of the assembled pole until they click into place.

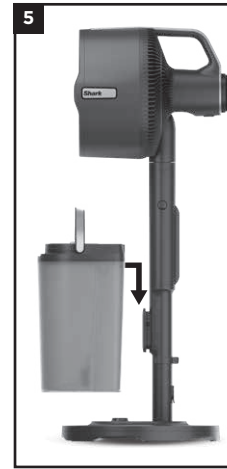

5. Holding the **Water Tank** by the handle, align the rear of the tank against the pole and slide down to latch into place.

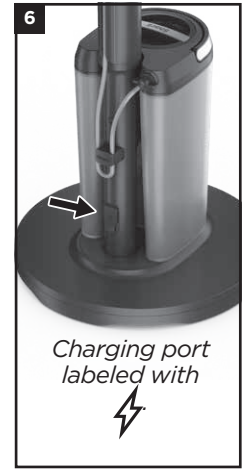

6. **Charge fan to 100% battery power** before use without the cord. **First use:** before using remote control, press **Power Button** on fan. Fan is operable while charging.



7. Connect the **Misting Hose** to the back of the water tank and rotate clockwise to lock it in place.

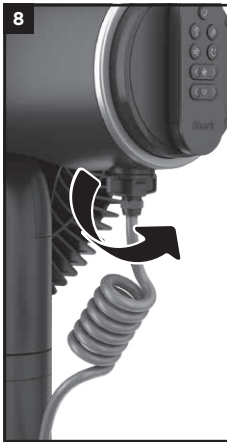

8. Connect the other end of the misting hose to the back of the fan head and rotate counterclockwise to lock it in place.



9. Tuck the rest of the misting hose into the channel and clamp it onto the back of the pole.

## FEATURES

CORDLESS	OUTDOORS
This is a 2-in-1 fan that can be used with or without the cord.	This fan can be enjoyed indoors or outdoors. <b>DO NOT CHARGE OR USE IN THE RAIN</b>
BREEZEBOOST™ & NATURALBREEZE	OUTDOOR MISTING
Activate the extra-powerful BreezeBoost for maximum-strength airflow, or use one of the NaturalBreeze modes to simulate wind conditions.	Integrated misting enabled through a portable water tank, 2 misting nozzles, and 3 misting modes. The misting feature is suitable for <b>OUTDOOR USE ONLY</b> .
OSCILLATION & TILT	REMOTE STORAGE
Direct the airflow by choosing between 3 electronic oscillation angles and manually adjusting the vertical tilt up to 55° degrees.	You can store the remote on the convenient magnetic mount on back of the fan head.

## CHARGING THE FAN



**PEDESTAL MODE:** To charge the fan in pedestal mode, insert the **CHARGER** into the charging port near the bottom of the **POLE**.



**TABLETOP MODE:** To charge the fan in tabletop mode, insert the charger into the charging port under the center shaft of the fan, between the 4 support legs. **DO NOT CHARGE OR USE IN THE RAIN.**

## BATTERY LIFE - FAN ONLY

Settings	Approx. Runtime
Fan Speed 1	24 hours
Fan Speed 1 + Oscillation	10 hours
Fan Speed 2	14 hours
Fan Speed 2 + Oscillation	8.5 hours
Fan Speed 3	6 hours
Fan Speed 3 + Oscillation	4.5 hours
Fan Speed 4	3 hours
Fan Speed 4 + Oscillation	2.5 hours









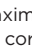
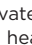

Settings	Approx. Runtime
Fan Speed 5	2 hours
Fan Speed 5 + Oscillation	1.5 hours
BreezeBoost™ Mode	1.5 hours
BreezeBoost Mode + Oscillation	1.25 hours
Strong Breeze	3 hours
Strong Breeze + Oscillation	2.5 hours
Gentle Breeze	12 hours
Gentle Breeze + Oscillation	8 hours

## BATTERY LIFE - FAN + MIST

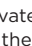
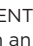
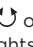
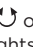
Settings	Approx. Runtime
Fan Speed 1	12 hours
Fan Speed 1 + Oscillation	8.5 hours
Fan Speed 2	8.5 hours
Fan Speed 2 + Oscillation	6 hours
Fan Speed 3	4.5 hours
Fan Speed 3 + Oscillation	4 hours
Fan Speed 4	2.5 hours
Fan Speed 4 + Oscillation	2.5 hours

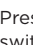
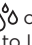
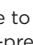
Settings	Approx. Runtime
Fan Speed 5	1.5 hours
Fan Speed 5 + Oscillation	1.5 hours
BreezeBoost™ Mode	1.25 hours
BreezeBoost Mode + Oscillation	1.25 hours
Strong Breeze	2.5 hours
Strong Breeze + Oscillation	2.5 hours
Gentle Breeze	8 hours
Gentle Breeze + Oscillation	6.5 hours

## HOW TO USE YOUR FAN

<b>Fan Speeds</b>	Press  on the fan head or <  > arrows on the remote to switch between fan speeds. LED lights will indicate selected fan speed.	
	BreezeBoost™ Mode	For maximum-strength airflow, press  on the remote or  on the fan head again. During cordless use, fan speed will automatically decrease after 20 minutes to save battery power.
	NaturalBreeze Modes	To activate STRONG breeze mode, press  once on the REMOTE, or press  on the fan head an additional time. To activate GENTLE breeze mode, press  a second time on the REMOTE, or press  on the fan an additional time.
<b>Oscillation Settings</b>	Press  on the fan head or <  > arrows on the remote to toggle between oscillation settings. LED lights will indicate which setting is selected.	
<b>Horizontal Angle Adjust</b>	Press the <  > arrows on the remote to change the horizontal angle of the fan in 18° increments.	
<b>Misting Settings</b>	1-3	Press  once to turn on high-pressure consistent mist. Press  a second time to switch to low-pressure consistent mist. Press  a third time to switch to low-pressure interval mist.
<b>Runtime</b>	Fan ONLY	<b>MAXIMUM CORDLESS RUNTIME:</b> 24 hours on fan speed 1. <b>AVERAGE CORDLESS RUNTIME:</b> 6.0 hours on fan speed 3. <b>MAXIMUM CORDLESS PERFORMANCE:</b> 2.0 hours on fan speed 5. <b>PLUGGED IN:</b> Indefinite runtime; fan will charge while operating.
	Fan + Misting	<b>MAXIMUM MISTING RUNTIME:</b> 16-hour high-pressure consistent misting on fan speed 1 (refilling the water tank every hour). <b>AVERAGE MISTING RUNTIME:</b> 4-hour high-pressure consistent misting on fan speed 3 (refilling the water tank every hour). <b>MAXIMUM MISTING PERFORMANCE:</b> 1-hour high-pressure consistent misting on fan speed 5.
<b>Charge Time</b>	<b>FROM 0% TO FULLY CHARGED BATTERY:</b> 5 to 6 hours	
<b>Battery Indicator</b>	 70%-100%: green light.  6%-29%: red light steady.  30%-69%: amber light.  5% and below: red light blinking.	



To preserve battery life, the fan will enter IDLE mode if left unplugged and powered off for 24 hours. In IDLE mode, the remote cannot be used to turn on the fan. To turn off IDLE mode, press the power button on top of the fan head.

## TABLETOP MODE

To convert the fan to portable, tabletop mode:



To detach the fan head from the pole, press the Lift-Away button, then slide the fan head off the pole.



Spread out the four support legs until they are fully extended, then place the fan head on a flat, level surface to use.



Connect the misting hose to the water tank and fan head while in tabletop mode for misting on the go.

**Note:** To avoid accidental damage to your fan, ensure the misting hose is disconnected from the back of the fan head before converting to tabletop mode.

## HOW TO CARRY YOUR FAN

- For short distances, carry the entire fan by placing one hand on the handle and the other on the pole.  
**Note:** If the water tank is full, remove it before carrying the fan to avoid potential injury or accidental damage.
- For longer distances, disassemble the fan. Carry the fan head in tabletop mode separately from the base, pole, and empty water tank. **Note:** Ensure you remove the misting hose from the back of the fan head before converting the fan to tabletop mode to prevent accidental damage.

## VERTICAL ADJUSTMENT

To adjust the vertical height of the fan head, use the handle to manually tilt the head up or down. The fan has a vertical range of 55° degrees.



Fan head tilted UP



Fan head tilted DOWN

## DISASSEMBLY

If grill screw, bolt, or Allen wrench have been lost, see Hardware Specs section for information on how to replace any hardware.

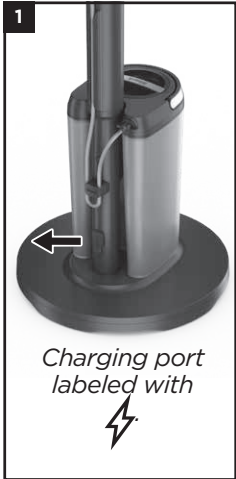

- 1.** Ensure your fan is unplugged before disassembly. To avoid accidental damage, **DO NOT** remove the charger at an angle.

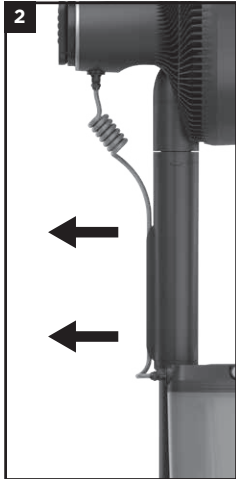

- 2.** Gently remove the **Misting Hose** from the channel located on the back of the **Pole**.



- 3.** To detach the misting hose from the **Fan Head**, rotate the connector clockwise.



- 4.** To detach the other end of the misting hose from the **Water Tank**, rotate the connector counterclockwise.



- 5.** With the misting hose fully removed, press the Lift-Away button on the side of the pole, then lift the **Fan Head** off the pole.

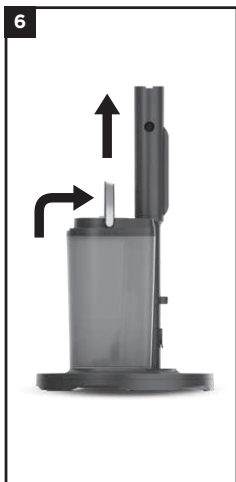

- 6.** Using the handle located on the lid, carefully lift the **Water Tank** to remove it from the base.

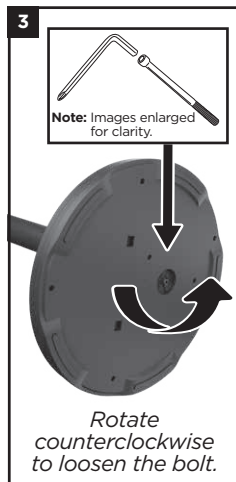

- 7.** Turn the pedestal **Base** on its side to access the **Bolt** on the bottom. Use the included **Allen Wrench** to rotate the bolt counterclockwise, then remove the bolt.

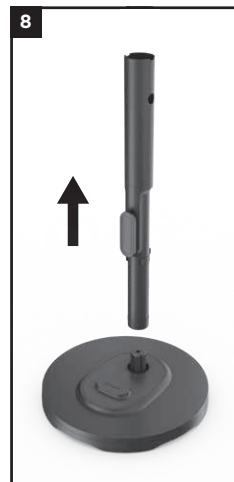

- 8.** Carefully lift the pole to remove it from the base.

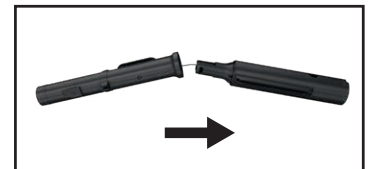
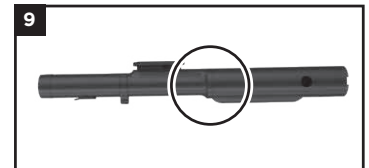

- 9.** Press the small button on the **Lower Pole** to detach the poles. Carefully fold as needed for storage. **DO NOT** strain the cord.

## STORAGE

STORAGE TYPE	INSTRUCTIONS
<b>Short-term storage (less than 24 hours)</b>	Remove, empty, and dry the misting hose and water tank. With the misting hose and tank disconnected from the fan, run the misting system for 20 seconds to clear out any stagnant water remaining in the internal hose. Carefully place the fan in the desired storage location. Ensure it is out of reach of children and pets. Bring the fan indoors if inclement weather is predicted.
<b>Long-term storage (more than 24 hours)</b>	Remove, empty, and dry the misting hose and water tank. With the misting hose and tank disconnected from the fan, run the misting system for 20 seconds to clear out any stagnant water remaining in the internal hose. Carefully place the fan in the desired storage location. Store the fan indoors when not in use for long periods. Always make sure to keep the fan out of reach of children and pets.



## SETTINGS

- Before first use, pull out the plastic tab from the battery compartment of the remote control.
- To preserve battery life, the fan will enter IDLE mode if left unplugged and powered off for 24 hours. In IDLE mode, the remote cannot be used to turn on the fan. To turn off IDLE mode and turn on the power, press the power button on top of the fan head.
- The LED lights on the fan head display will only remain illuminated for 20 seconds after a setting adjustment is made before turning off to save battery.
- For information on how to activate or deactivate **LOCK MODE** for fan maintenance, please see the Maintenance section.
- Remote may be less effective when used outdoors.

## REMOTE PAIRING INSTRUCTIONS

Turn the unit on by pressing the power button on top of the fan head and check if the remote functions properly.

If the remote is not functioning, try the following:

1. Check to ensure the battery saver paper is removed from the remote (coin cell battery remote models). Check to ensure the 2 AAA batteries are placed in the remote in the correct orientation (AAA battery remote models).
2. Try connecting the remote to the fan by pressing and holding the power button on the fan head for 5 seconds. While the LEDs are flashing, press the fan speed up button on the remote.

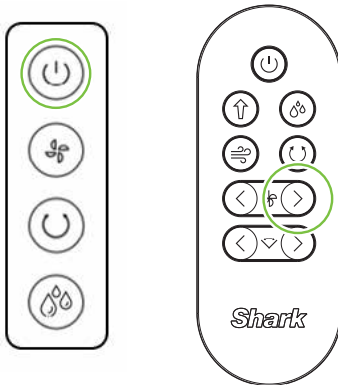

3. If the remote still doesn't work, then try replacing the batteries in the remote and repeat the connection process above.

## POWER ON/OFF

To turn the fan on or off, press the **POWER** button on the remote or the **POWER** button on the fan head.

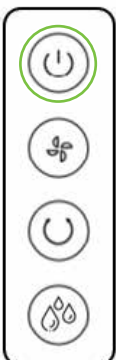
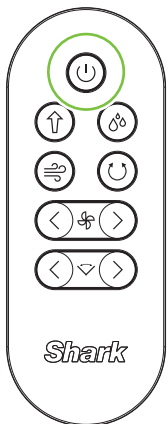





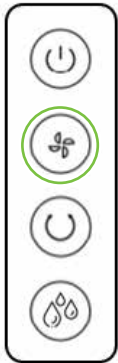
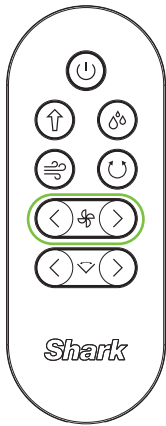

POWER	DISPLAY
ON	<p>LED animations will play once (LEDs will turn on from left to right, then turn off from right to left)</p>
OFF	<p>LED animation will play once (LEDs will turn off from right to left)</p>

## FAN SPEEDS

Changing the **FAN SPEED** will increase or decrease the airflow of the fan. The number of fan speeds varies by model, see chart below for more details.

To change the speed, press  on the fan head to cycle through the different speeds. With the **REMOTE**, press the left and right arrows to change speeds. The **LEFT ARROW** will **DECREASE** the speed of the fan and the **RIGHT ARROW** will **INCREASE** the speed of the fan.





SPEED	DISPLAY	BEST FOR
1		Quiet operation
2		Moderate cooling
3		Balance of noise level and fan power
4		Air circulation
5		High power cooling

## BREEZEBOOST™ MODE

Turn on BreezeBoost for maximum-power airflow. When operating cordlessly, BreezeBoost will automatically turn off after 20 minutes to save battery. BreezeBoost will run indefinitely when the fan is plugged in.

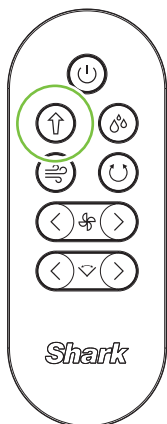
To activate BreezeBoost, press the  icon on the **REMOTE** or press the  icon on the fan head 5 times. To deactivate BreezeBoost press either of the buttons again.



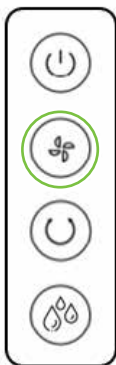

DISPLAY	SETTING	BEST FOR
 <p>LED animation will repeat 5 times (LEDs will turn on from left to right)</p>	BreezeBoost	Maximizing fan power



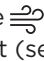

## NATURALBREEZE MODES

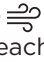

Turn on either of the NaturalBreeze modes to simulate natural wind conditions.

To activate STRONG NaturalBreeze, press the  icon on the **REMOTE** or press the  icon on the fan head until the corresponding LEDs are displayed on the unit (see table below for LED patterns).

To transition from STRONG NaturalBreeze to GENTLE NaturalBreeze press the  icon on the **REMOTE** again, or press the  icon on the fan head again.

To deactivate NaturalBreeze, press the  icon on the **REMOTE** to return to your previously selected fan speed or press the  icon on the fan head until you reach your desired fan speed setting.



DISPLAY	SETTING	BEST FOR
	STRONG NaturalBreeze	Simulating strong wind conditions
	GENTLE NaturalBreeze	Simulating gentle wind conditions

NATURALBREEZE WIND PATTERNS	
STRONG NaturalBreeze Mode	GENTLE NaturalBreeze Mode
<ul style="list-style-type: none"> <li>• 6 seconds in Speed 3</li> <li>• 5 seconds in Speed 4</li> <li>• 4 seconds in Speed 5</li> <li>• 5 seconds in Speed 4</li> <li>• The sequence will repeat</li> </ul>	<ul style="list-style-type: none"> <li>• 6 seconds in Speed 1</li> <li>• 5 seconds in Speed 2</li> <li>• 4 seconds in Speed 3</li> <li>• 5 seconds in Speed 2</li> <li>• The sequence will repeat</li> </ul>







## OSCILLATION

Choose one of the 3 oscillation angles.

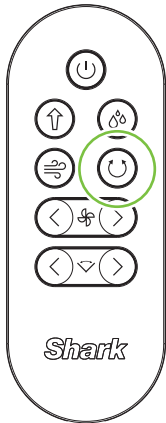
To change the oscillation settings, press the Oscillation  icon on the **REMOTE** or the fan head.

To turn off oscillation, press the same Oscillation  icon on the **REMOTE** or the fan head until no LEDs are illuminated.



DISPLAY	ANGLE	BEST FOR
	45°	Circulating air in small area, 1-2 people
	90°	Circulating air in moderate area, 3-4 people
	180°	Circulating air in large area, 5+ people

## HORIZONTAL ANGLE ADJUST

You can use the remote control to change the horizontal angle of the fan from a distance. Press the left or right arrows on the remote to adjust the horizontal angle.

**NOTE:** The LEDs on the fan head will not illuminate when you use this feature.

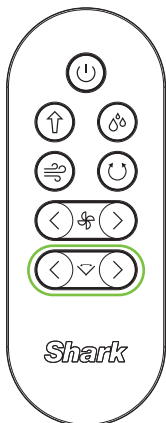

# OUTDOOR MISTING

The misting feature is suitable for **OUTDOOR USE ONLY**.

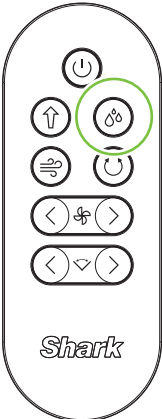

Choose between 3 misting settings to best suit your needs. To change the misting settings, press the Misting  icon on the remote or the fan head to cycle through the settings.

To turn off misting, press the Misting  icon on the remote or the fan head until no LEDs are illuminated.





*Shark*



DISPLAY	SETTING	BEST FOR
	High-Pressure Consistent	Maximum cooling power
	Low-Pressure Consistent	Balance of cooling power and misting duration
	Low-Pressure Interval	Longest misting duration

## TROUBLESHOOTING AND FREQUENTLY ASKED QUESTIONS

<b>GENERAL USE</b>	<b>Why is the mist too wet?</b>	<p>The misting feature is suitable for <b>OUTDOOR USE ONLY</b>. Do not attempt to mist indoors as this could cause slippery conditions or water damage.</p> <p>The fan is equipped with 3 mist settings designed to provide varying amounts of mist density. Press the misting  icon on either the remote or fan head until you reach your desired setting.</p> <p>Adjusting the speed of the fan can affect the intensity of the mist. Try lowering the speed if the mist feels too wet.</p> <p>Sometimes, standing too close to the fan can make the mist feel wetter than it should. Try moving a few feet back and check if it improves the mist experience.</p>
	<b>Why is the remote not working?</b>	<p>When using the remote control, make sure it is pointed directly at the LEDs on the front of the fan.</p> <p>The fan may have entered IDLE mode. To preserve battery life, the fan will enter IDLE mode if left unplugged and powered off for 24 hours. In IDLE mode, the remote cannot be used to turn on the fan. To turn off IDLE mode and turn on the power, press the power button on top of the fan head.</p> <p>If your remote has lost its connection to the fan, you can easily reconnect it. Press and hold the power button on the fan head for 5 seconds, then press the right fan speed button on the remote while the LEDs on the fan head are flashing.</p> <p>If the remote still doesn't work, then try replacing the batteries in the remote.</p>
	<b>Why are the remote and UI buttons not working?</b>	<p>Make sure the fan has battery power by pressing the Power button. If the Battery LED indicator blinks red, then the fan needs to be charged. When the fan is charging, the battery LED will blink green. See the Battery Life and How To Use Your Fan sections for more detailed information on runtimes and battery indicators.</p> <p>If all the LEDs are flashing, the fan may be in Lock mode, which deactivates the fan to allow you to safely maintain it. To turn off Lock mode, press the Oscillation  icon on the fan and hold it down for 8 seconds. When Lock mode is successfully deactivated, the LEDs will display the Power On pattern. See the Maintenance section for more information.</p>
	<b>Why is the battery light flashing red when I am trying to turn on BreezeBoost™ mode?</b>	<p>If the battery level is low, BreezeBoost mode cannot be activated. Charge the fan battery to use BreezeBoost.</p>
	<b>Can I leave the fan outdoors?</b>	<p>This fan is water-resistant and will not be damaged by light rain. However, it is not suitable to withstand heavy rain or water submersion. <b>Do not charge or use your fan in the rain.</b></p>
	<b>Why is the fan rattling?</b>	<p>Ensure that the fan blade cap is fully installed before operating the fan. Please see the Maintenance section for more details.</p>
	<b>The second LED indicator and the Battery LED (in amber) are flashing. What is wrong?</b>	<p>This error state indicates an issue with the voltage of the charger. Please be sure to only use the provided Shark™ charging cable and power supply.</p>
	<b>MAINTENANCE</b>	<b>Why do I have to activate Lock mode before maintenance?</b>
<b>How often should I clean the fan?</b>		<p>We recommend cleaning the fan every 6 months or as needed.</p>
<b>How do I maintain the misting hose?</b>		<p>Every 12 months, use a damp cloth to clean the rubber seals on both ends of the misting hose to prevent buildup.</p>
<b>How often should I clean the misting nozzles?</b>		<p>Clean the misting nozzles every 12 months or as needed. Using harder water will require more frequent cleaning. See Maintenance section for more information on cleaning misting nozzles.</p>
<b>Why isn't my fan misting effectively?</b>		<p>Ensure the misting hose is securely connected to the water tank and fan head. See the Assembling Your Fan section for more information. The misting hose and nozzles may clog if not maintained properly. See the Maintenance section for details on cleaning instructions. If the issue persists, the water tank filter may be clogged. Visit <a href="http://sharkclean.com">sharkclean.com</a> to order a replacement water tank filter.</p>

## MAINTENANCE

- We recommend cleaning the water tank and misting hose with unscented soap and water every 3 months or as needed. Ensure you empty and dry the water tank and misting hose after every use.
- We recommend cleaning the misting nozzles every 12 months or as needed. Using harder water will require more frequent cleaning. To clean the misting nozzles:
  1. Carefully remove each brass nozzle. **CAUTION:** Residual pressure may remain in the misting system.
  2. To remove a nozzle, twist it counterclockwise. **DO NOT** use a wrench or any other tool. **WARNING: CHOKING HAZARD.** Keep nozzles out of the reach of children.
  3. Soak the nozzles in a solution of undiluted distilled white vinegar (5% acetic acid by volume) to loosen debris that may be clogging or restricting water flow. **DO NOT** soak the nozzles for more than 2 hours.
  4. After soaking the nozzles in the solution, rinse them thoroughly with water.
  5. Carefully reinstall each nozzle by twisting clockwise until you feel resistance.
- We recommend cleaning the fan every 6 months or as needed. If the grill screw, bolt, or Allen wrench have been lost, see the Hardware Specs section for more information on how to replace any hardware.

- **LOCK MODE** must be activated prior to performing maintenance. This will temporarily block all fan functions until deactivated. Lock mode prevents the fan from accidentally powering on.

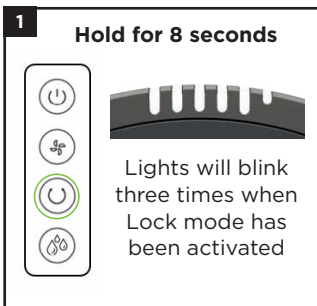

1. Turn on Lock mode before performing maintenance for safety. To activate, hold down the **OSCILLATION** icon on the **Fan Head** for 8 seconds until the LEDs flash three times.



2. Place the fan upright on a flat, level surface in tabletop mode. Use the Phillips-head end of the **Allen wrench** to remove the screw at the bottom of the **Fan Grill**. Set screw aside.



3. Rotate the fan grill counterclockwise to remove it from the fan head. Set grill aside.



4. Remove the **Fan Blade Cap**. Hold the **Fan Blades** in place while rotating the fan blade cap clockwise to remove it from the shaft.



5. Remove the fan blades by gently pulling them out. With a slightly damp cloth, wipe down the interior parts of the fan.

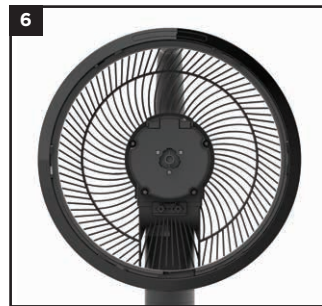

6. Carefully replace the fan blades onto the center shaft.

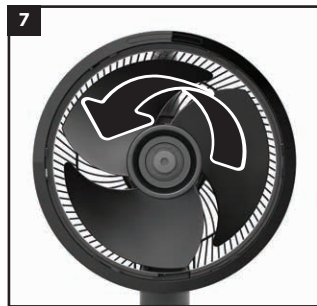

7. Reinstall the fan blade cap. Hold the fan blades in place while rotating the fan blade cap counterclockwise to reinstall it to the shaft.



8. Rotate the fan grill clockwise to secure it to the fan head.

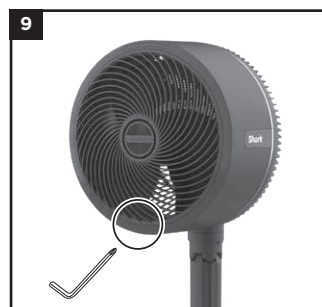

9. Place the fan upright on a flat, level surface. Use the Phillips-head of your Allen wrench to replace and tighten the screw at the bottom of the fan grill.

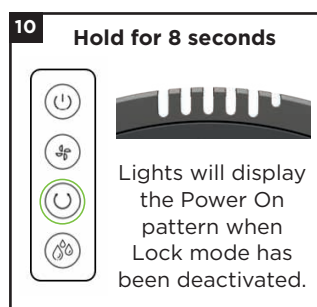

10. Turn off Lock mode by holding down the **OSCILLATION** icon on the fan head for 8 seconds until the LEDs display the Power On pattern.



## HARDWARE SPECS

### Grill Screw

For securing the grill to the fan

<b>Drive Type</b>	Phillips
<b>Thread Size / Pitch</b>	M3 x 0.5mm
<b>Length</b>	16mm

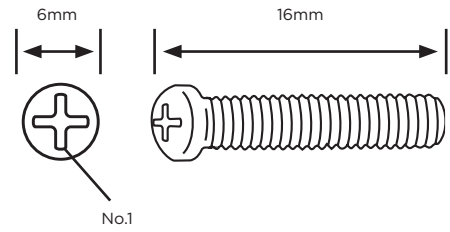

### Screwdriver

For driving the screw

<b>Drive Type</b>	Phillips
<b>Size</b>	No. 1

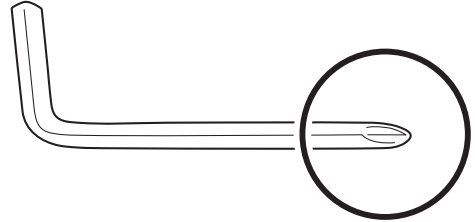

### Bolt

For securing base to pole

<b>Drive Type</b>	Hex
<b>Thread Size / Pitch</b>	M6 x 1mm
<b>Length</b>	85mm

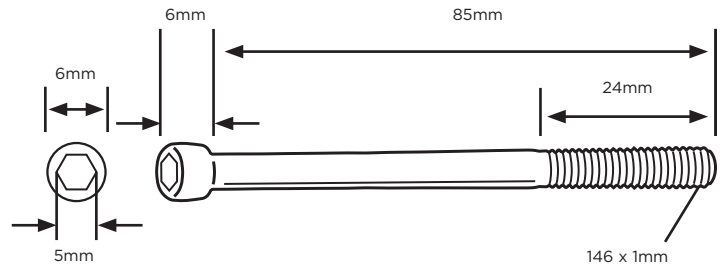

### Allen Wrench

For driving the bolt

<b>Drive Type</b>	Hex
<b>Size</b>	5mm

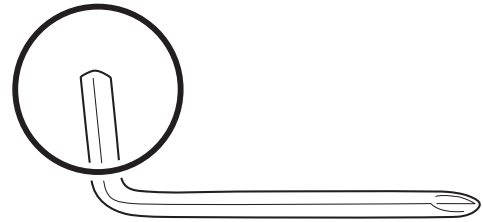

## TWO (2) YEAR LIMITED WARRANTY

The Two (2) Year Limited Warranty applies to purchases made from authorized retailers of **SharkNinja Operating LLC**. Warranty coverage applies to the original owner and to the original product only and is not transferable.

SharkNinja warrants that the unit shall be free from defects in material and workmanship for a period of two (2) years from the date of purchase when it is used under normal household conditions and maintained according to the requirements outlined in the Owner's Guide, subject to the following conditions and exclusions:

### What is covered by this warranty?

1. The original unit and/or non-wearable parts deemed defective, in SharkNinja's sole discretion, will be repaired or replaced up to two (2) years from the original purchase date.
2. In the event a replacement unit is issued, the warranty coverage ends six (6) months following the receipt date of the replacement unit or the remainder of the existing warranty, whichever is later. SharkNinja reserves the right to replace the unit with one of equal or greater value.

### What is not covered by this warranty?

1. Normal wear and tear of wearable parts (such as batteries, etc.) which require regular maintenance and/or replacement to ensure the proper functioning of your unit, are not covered by this warranty. Replacement parts are available for purchase at [sharkaccessories.com](http://sharkaccessories.com).
2. Any unit that has been tampered with or used for commercial purposes.
3. Damage caused by misuse, abuse, negligent handling, failure to perform required maintenance (e.g., not replacing the filters), or damage due to mishandling in transit.
4. Consequential and incidental damages.

5. Defects caused by repair persons not authorized by SharkNinja. These defects include damages caused in the process of shipping, altering, or repairing the SharkNinja product (or any of its parts) when the repair is performed by a repair person not authorized by SharkNinja.
6. Products purchased, used, or operated outside North America.

### How to get service

If your appliance fails to operate properly while in use under normal household conditions within the warranty period, visit [sharkclean.com/support](http://sharkclean.com/support) for product care and maintenance self-help. Our Customer Service Specialists are also available at **1-855-523-4061** to assist with product support and warranty service options, including the possibility of upgrading to our VIP warranty service options for select product categories. So we may better assist you, please register your product online at [registryyourshark.com](http://registryyourshark.com) and have the product on hand when you call.

SharkNinja will cover the cost for the customer to send in the unit to us for repair or replacement. A fee of \$25.95 (subject to change) will be charged when SharkNinja ships the repaired or replacement unit.

### How to initiate a warranty claim

You must call **1-855-523-4061** to initiate a warranty claim. You will need the receipt as proof of purchase. We also ask that you register your product online at [registryyourshark.com](http://registryyourshark.com) and have the product on hand when you call, so we may better assist you. A Customer Service Specialist will provide you with return and packing instruction information.

### How state law applies

This warranty gives you specific legal rights, and you also may have other rights that vary from state to state. Some states do not permit the exclusion or limitation of incidental or consequential damages, so the above may not apply to you.

## IMPORTANT INFORMATION

### REGISTER YOUR PURCHASE



[registryyourshark.com](http://registryyourshark.com)



Scan QR code using mobile device



### RECORD THIS INFORMATION

Model Number: \_\_\_\_\_

Serial Number: \_\_\_\_\_

Date of Purchase: \_\_\_\_\_  
(Keep receipt)

Store of Purchase: \_\_\_\_\_

### TECHNICAL SPECIFICATIONS

Voltage: 120V~ 60Hz / 3A  
Watts: 36W  
4000 mAh

Benefits of registering your product and creating an account:

- Get easier, faster product support and access to warranty information
- Access troubleshooting and product care instructions
- Be among the first to know about exclusive product promotions

**TIP:** You can find the model and serial numbers on the QR code label on the underside of the fan head.

### BATTERY REMOVAL AND DISPOSAL

This product contains an integral lithium battery (not replaceable), and the remote control uses a lithium coin battery (replaceable) or 2 AAA batteries (replaceable). When the remote batteries no longer have charge, they should be removed from the remote and recycled. **DO NOT** incinerate or compost the product with its integral battery or the remote batteries. When your remote battery needs to be replaced, dispose of it or recycle it in accordance with local ordinances or regulations. In some areas, it is illegal to place spent lithium batteries in the rubbish or in a municipal solid waste stream. Return spent batteries to an authorized recycling center or to retailer for recycling. Contact your local recycling center for information on where to drop off the spent battery.



### FCC WARNINGS

Note: This unit has been tested and found to comply with FCC limits for Class B digital devices. These limits are designed to provide reasonable protection against harmful interference in a residential installation. This unit generates, uses, and can radiate radio frequency energy, and if not installed and used in accordance with the instructions, may cause harmful interference to radio communications.

This device complies with part 15 of the FCC Rules. Operation is subject to the following two conditions: (1) this device may not cause harmful interference, and (2) this device must accept any interference received, including interference that may cause undesired operation.

To see if this unit interferes with radio or television reception, try turning it off and on.

To correct any interference:

- Reorient or relocate the receiving antenna.
- Increase the distance between the unit and the receiver.
- Connect the unit to a different outlet than the receiver.
- Consult the dealer or an experienced technician for help.

Caution: Any changes or modifications to this unit not expressly approved by the party responsible for compliance could void the user's authority to operate it.

### IC statement:

This device contains licence-exempt transmitter(s)/receiver(s) that comply with Innovation, Science and Economic Development Canada's licence-exempt RSS(s). Operation is subject to the following two conditions:

1. This device may not cause interference.
2. This device must accept any interference, including interference that may cause undesired operation of the device.

### PLEASE READ CAREFULLY AND KEEP FOR FUTURE REFERENCE.

This Owner's Guide is designed to help you get a complete understanding of your new Shark™ fan.

SharkNinja Operating LLC  
US: Needham, MA 02494  
CAN: Ville St-Laurent, QC H4S 1A7  
1-800-798-7398  
[sharkclean.com](http://sharkclean.com)

Illustrations may differ from actual product. We are constantly striving to improve our products; therefore the specifications contained herein are subject to change without notice.

This product may be covered by one or more U.S. patents. See [sharkninja.com/patents](http://sharkninja.com/patents) for more information.