

QUICK START GUIDE GUIDE DE DÉMARRAGE RAPIDE

IMPORTANT READ BEFORE USING

IMPORTANT LIRE AVANT UTILISATION

CERTIFICATION MODEL:
RECON 70P, RECON 70X

SETUP FOR PS5® | CONFIGURATION POUR PS5®

EN

- Go to Settings > Sound > Audio Output > Output Device
- Select Headset Connected To Controller for Output Device
- Set Output to Headphones to All Audio
- Go to Settings > Sound > Volume > Headphones
- Set Volume Control (headphones) level to Maximum
- Adjust your microphone levels by going to Settings > Sound > Microphone > Adjust Mic Level > Microphone Level

ES

- Ve a Configuración > Sonido > Salida de sonido > Dispositivo de salida.
- Selecciona los auriculares conectados al mando como dispositivo de salida.
- Establece los auriculares como salida para todo el sonido.
- Ve a Configuración > Sonido > Volumen > Auriculares.
- Establece el nivel de control del volumen [auriculares] al máximo.
- Ajusta los niveles del micrófono desde Configuración > Sonido > Micrófono > Ajustar nivel de micrófono > Nivel de micrófono.

JP

- [設定] > [サウンド] > [オーディオ出力] > [出力デバイス] の順に移動します。
- コントローラーに接続されている出力機器用のヘッドセットを選択します。
- [ヘッドホンへの出力] を [すべてのオーディオ] に設定します。
- [設定] > [サウンド] > [音量] > [ヘッドホン] の順に移動します。
- [ボリュームコントロール] (ヘッドホン) を最大に設定します。
- [設定] > [サウンド] > [マイク] > [マイクレベルを調整する] > [マイクレベル] からマイクレベルを調整します。

For PS4 setup search "Recon 70 PS Setup" at www.turtlebeach.com/support

Pour la configuration de la PS4, cherchez „Recon 70 PS Configuration" sur www.turtlebeach.com/support

PACKAGE CONTENTS | CONTENU

- Recon™ 70 Gaming Headset
- Quick Start Guide
- Casque de jeu Recon™ 70
- Guide d'installation rapide

HEADSET CONTROLS | COMMANDES DU CASQUE

CAUTION:

Over Rotating Mic
Turning the mic past positions 1 & 3 may cause damage to the mic.

AVERTIR :

Positionnement du microphone
Orienter le microphone au-delà des positions 1 et 3 risque de l'endommager.

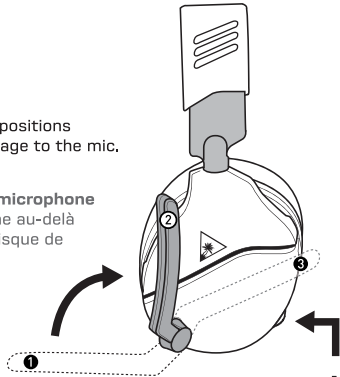

Mic Mute

Flip up mic to mute (see position 2).

Microphone muet

Relever le microphone pour le couper (voir position 2).

Master Volume Adjusts the master volume of the incoming game and chat audio.

Volume principal Règle le volume principal du jeu et du chat vocal entrant.

SETUP FOR XBOX® | CONFIGURATION POUR XBOX®

EN

- Press the Xbox Button on your controller
- Go to the Audio & music settings [🔊]
- Set Headset Volume to maximum
- Set Headset Chat Mixer to the middle setting
- Set Mic Monitoring to your preferred level

ES

- Pulsa el botón Xbox de tu mando.
- Ve a la configuración de Audio y música. [🔊]
- Ajusta el Volumen de los auriculares al máximo.
- Ajusta el mezclador de chat de los auriculares a la mitad.
- Ajusta Supervisión del micrófono al nivel que prefieras.

JP

- コントローラーの Xbox ボタンを押します
- [オーディオ & ミュージック] を選択します。 [🔊]
- [ヘッドセット音量] を最大にします。
- [ヘッドセット チャットミキサー] を中程度に設定にします。
- [ヘッドセット側の音量調節] をお好みのレベルに調整します

ADDITIONAL SETUPS CONFIGURATIONS SUPPLÉMENTAIRES



Works with devices with a 3.5mm audio jack.
Compatible avec les appareils munis d'une prise audio jack 3,5 mm.

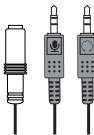

Note: If your PC uses separate Green/Pink connectors for audio, you will need a PC Splitter Cable. This adapter is included with the PC version of Recon™ 70, or can be purchased separately at turtlebeach.com

Remarque: Si votre PC utilise des connecteurs vert/rose séparés pour l'audio, vous aurez besoin d'un câble séparateur PC. Cet adaptateur est inclus dans la version PC du Recon™ 70 ou peut être acheté séparément sur turtlebeach.com

SETUP | CONFIGURATION

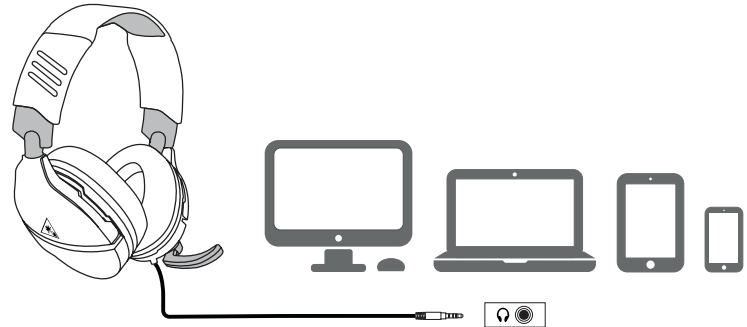
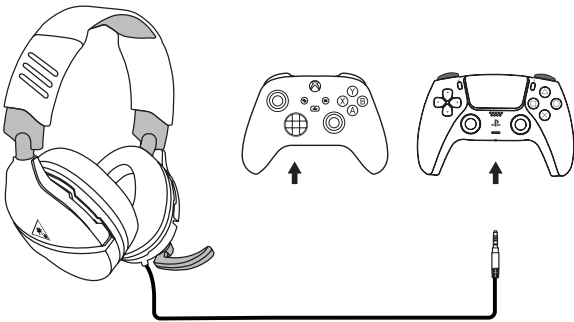

Regulatory Compliance Statements for the RECON 70 (Certification model: Recon 70P, Recon 70X) Federal Communications Commission (FCC) Compliance Notices Class B Interference Statement

This equipment has been tested and found to comply with the limits for a Class B digital device, pursuant to Part 15, Subpart B of the FCC Rules. These limits are designed to provide reasonable protection against harmful interference in a residential installation. This equipment generates, uses, and can radiate radio frequency energy and, if not installed and used in accordance with the instructions, may cause harmful interference to radio communications. However, there is no guarantee that interference will not occur in a particular installation. If this equipment does cause harmful interference to radio or television reception, which can be determined by turning the equipment off and on, the user is encouraged to try to correct the interference by one or more of the following measures:

- Reorient or relocate the receiving antenna.
- Increase the separation between the equipment and receiver.
- Connect the equipment into an outlet on a circuit different from that to which the receiver is connected.
- Consult the dealer or an experienced radio/TV technician for help.

FCC Caution:

This device complies with Part 15 of the FCC Rules. Operation is subject to the following two conditions: (1) This device may not cause harmful interference, and (2) this device must accept any interference received, including interference that may cause undesired operation. This product is compliant with the Consumer Product Safety Improvement Act of 2008, Public Law 110–314 (CPSIA)

CANADA-statement

This device complies with Innovation, Science and Economic Development Canada's licence-exempt RSS(s). Operation is subject to the following two conditions:

- This device may not cause interference; and
- This device must accept any interference, including interference that may cause undesired operation of the device.

Le présent appareil est conforme aux CNR d'Innovation, Sciences et Développement économique Canada exempt(s) de licence(s) applicables aux appareils radio exempts de licence. L'exploitation est autorisée aux deux conditions suivantes:

- l'appareil ne doit pas produire de brouillage;
- l'utilisateur de l'appareil doit accepter tout brouillage radioélectrique subi, même si le brouillage est susceptible d'en compromettre le fonctionnement.

For warranty information and service, please visit www.turtlebeach.com/warranty

WARRANTY SERVICE FOR PURCHASES IN AUSTRALIA

Our goods come with guarantees that cannot be excluded under the Australian Consumer Law. For complete details please visit www.turtlebeach.com/warranty.

To make a warranty claim in Australia during the Warranty Period, Purchaser should contact the VTB repair centre: Teoworks International Pty Ltd, 13 Distribution Place, Seven Hills NSW 2147, Tel: 1300 074 512



TURTLE BEACH™

Any questions? Des questions?
www.turtlebeach.com/support

Please register your product to receive important updates.
Enregistrez votre produit pour recevoir les mises à jour importantes.
www.turtlebeach.com/productregistration

For warranty, visit:
Concernant la garantie, visitez :
www.turtlebeach.com/warranty

European Union and European Fair Trade Association (EFTA) Regulatory Compliance

Declaration of Conformity

Marking by this symbol:

Hereby, Voyetra Turtle Beach Inc. declares that **Recon 70P, Recon 70X** is in compliance with Directive 2014/30/EU(EMC), 2014/35/EU(Safety), 2015/863 amending Annex II to 2011/65/EC(RoHS), 2012/19/EU (WEEE), 2006/1907/EU (REACH), 94/62/EC (PACKAGING), Electromagnetic Compatibility Regulations 2016(EMC), Electrical Equipment Regulations 2016(Safety), The Restriction of the Use of Certain Hazardous Substances in Electrical and Electronic Equipment Regulations 2012.

The full text of the EU/UK declaration of conformity is available at the following internet address:
<http://www.turtlebeach.com/homologation>



This symbol on the product or its packaging indicates that this product must not be disposed of with your other household waste. Instead it is your responsibility to dispose of your waste equipment by handing it over to a designated collection point for the recycling of waste electrical and electronic equipment. The separate collection and recycling of your waste equipment at the time of disposal will help conserve natural resources and ensure that it is recycled in a manner that protects human health and the environment. For more information about where you can drop off your waste for recycling, please contact your local authority, or where you purchased your product.

Turtle Beach Europe Ltd is obligated as a producer with a main activity of selling under The Producer Responsibility Obligations (Packaging Waste) Regulations 2007. To fulfill our obligation we are registered with Comply Direct and their Recycling Room. Here you will find advice and information on packaging waste management, recycling symbols and the waste hierarchy principles of reduce, reuse and recycle.

<https://www.complydirect.com/the-recycling-room/>

For instructions in other languages, please visit <http://www.turtlebeach.com/homologation>

Copyright © 2024, Voyetra Turtle Beach, Inc. All rights reserved. No part of this document may be reproduced without permission. Turtle Beach and the Turtle Beach logo are registered trademarks of VTB.

この装置は、クラスB機器です。この装置は、住宅環境で使用することを目的としていますが、この装置がラジオやテレビジョン受信機に近接して使用されると、受信障害を引き起こすことがあります。 取扱説明書に従って正しい取り扱いをして下さい。	VCCI — B
--	----------

	Warning: To prevent possible hearing damage, do not listen at high volume levels for long periods.
--	---

