



HS35 v3 WIRELESS

GAMING HEADSET

REVIEWER'S GUIDE



HS35 v3 WIRELESS

GAMING HEADSET

TABLE OF CONTENTS

PREFACE	3
Imagery and Downloads	3
Additional Information	3
INTRODUCTION TO THE HS35 v3 WIRELESS	5
Feature Overview	6
Technical Specifications	6
Updating the HS35 v3's Firmware	8
Setting Up Dolby Atmos	13
Package Contents	16
Getting To Know the HS35 v3 Wireless Gaming Headset	17
Setting Up the HS35 v3 Wireless Headset	18
Listening to Music	20
Microphone Control	20
Charging Before First Use	20
LED Indicator Guide	20
PRICING	21
CONTACTS	21



HS35 v3 WIRELESS

GAMING HEADSET

PREFACE

This reviewer's guide will introduce you to the HS35 v3 WIRELESS gaming headset, which features 50mm drivers, tri-mode connectivity, wide multiplatform support, and an enhanced floating headband design.



Imagery and Downloads

CORSAIR Logo Usage Guidelines	https://www.corsair.com/press
Product Images	LINK
CORSAIR iCUE Software	NA

Additional Information

Please do not hesitate to reach out to your local CORSAIR PR representative if you:

- Require any additional information about the product
- Encounter any issues during the testing and evaluation process



HS35 v3 WIRELESS

GAMING HEADSET

- Have any questions regarding results or conclusions

Please see the [CONTACTS](#) section to find your local CORSAIR PR representative.



HS35 v3 WIRELESS

GAMING HEADSET

INTRODUCING THE HS35 v3 WIRELESS



An Icon, Reborn.

Fire up game-changing sound with the HS35 v3 Wireless gaming headset. 50mm neodymium drivers backed by Dolby Atmos* deliver another dimension of audio immersion. Easily connect to PC, PlayStation, Nintendo Switch, Mac, and more with versatile tri-mode connectivity for great sound wherever you play, whatever you listen to. Comfortably power through gaming marathons with the new adjustable floating headband and breathable soft fabric earpads, with up to 30 hours** of battery life to keep you gaming for days. Chat with friends and enjoy crystal-clear comms with the omnidirectional mic. Quickly adjust volume and mute the mic with convenient earcup controls.

*Dolby Atmos® available on PC only. Requires Dolby Access app.

**Up to 30 hours of battery life at 50% volume.



HS35 v3 WIRELESS

GAMING HEADSET

Feature Overview

1. **Dolby Atmos® Spatial Audio***: Experience dynamic and directional audio that gives your audio another layer of immersion. Hear every footstep, explosion, and movement with incredible directional accuracy.
2. **Tri-mode Connectivity**: Connect however and wherever you want. 2.4GHz, Bluetooth®, and wired connectivity options for PC, PlayStation, Nintendo Switch, Mac, mobile, and more.
3. **Enhanced comfort**: The new adjustable floating headband design and soft fabric earpads provide enhanced long-lasting comfort that's perfect for gaming marathons.
4. **50mm neodymium drivers**: Enjoy detailed, immersive audio delivered via custom-tuned 50mm neodymium drivers.
5. **Clear omnidirectional mic**: Get better teamwork and enjoy chatting with friends thanks to the crystal-clear communication from the detachable omnidirectional mic.
 - a. **Up to 30-hour battery life**: Queue up for one more, you've got plenty of juice. With more than a full day of battery life, enjoy up to 30 hours** of gaming audio and wireless freedom.
6. **Convenient volume and mic mute**: Mute your mic and quickly adjust the volume with convenient controls on the earcup.

*Dolby Atmos® available on PC only. Requires Dolby Access app.

**Up to 30 hours of battery life at 50% volume.

Technical Specifications

FEATURE	DESCRIPTION
Audio Driver	Custom 50mm Neodymium
Frequency Response	20Hz - 20 kHz
Impedance	32 Ohms @ 1kHz
Sensitivity	117dB (± 3dB)
Mic Type	Omni-directional
Mic Impedance	2.2k Ohms



HS35 v3 WIRELESS

GAMING HEADSET

Mic Frequency Response	100Hz - 10kHz
Mic Sensitivity	-42dB (± 2dB)
Compatibility	PC, PlayStation, Nintendo Switch, Mac, mobile
Dimensions	83(L) x 184(W) x 201.9(H) mm
Weight	250g
Warranty	2 years

Commenté [CC1]: Can we have a compatibility row here?

Commenté [AH2R1]: Ok, added.



HS35 v3 WIRELESS

GAMING HEADSET

Updating the HS35 v3's Firmware

1. Connect HS35 v3 wireless to PC via USB cable and wireless USB transmitter. Make sure the USB Type-C wireless USB transmitter is properly connected to the USB Type-A USB transmitter.



Commenté [CC3]: Can we also include a picture of what it looks like when correctly attached?

Commenté [AH4R3]: Ok, added!

2. Visit the Firmware Update Utility: Go to corsair.com/firmware-updater

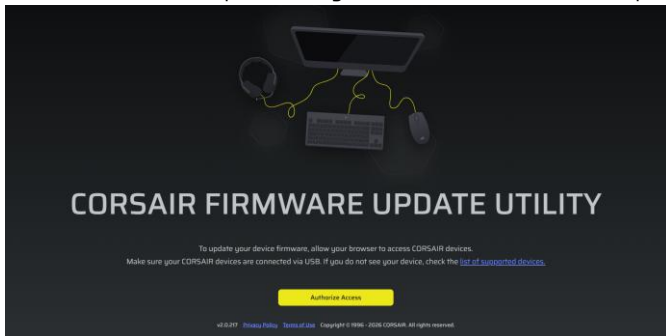

3. Click 'Authorize Access'.



HS35 v3 WIRELESS

GAMING HEADSET



- b. Choose 'HS35 v3 Wireless Gaming Headset' and click the 'Connect' button in the pop-up window.

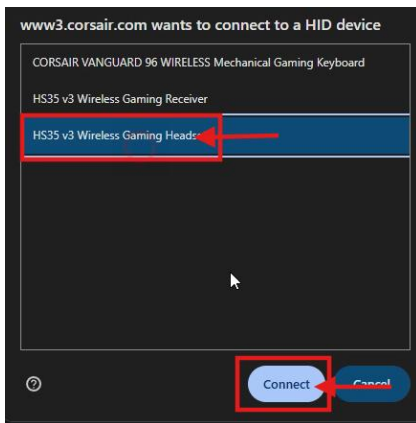

- c. The page will automatically go back to Corsair Firmware Update Utility. Click the 'Add device' button, choose 'HS35 v3 WL' and click the 'Connect' button in the pop-up window.



HS35 v3 WIRELESS

GAMING HEADSET

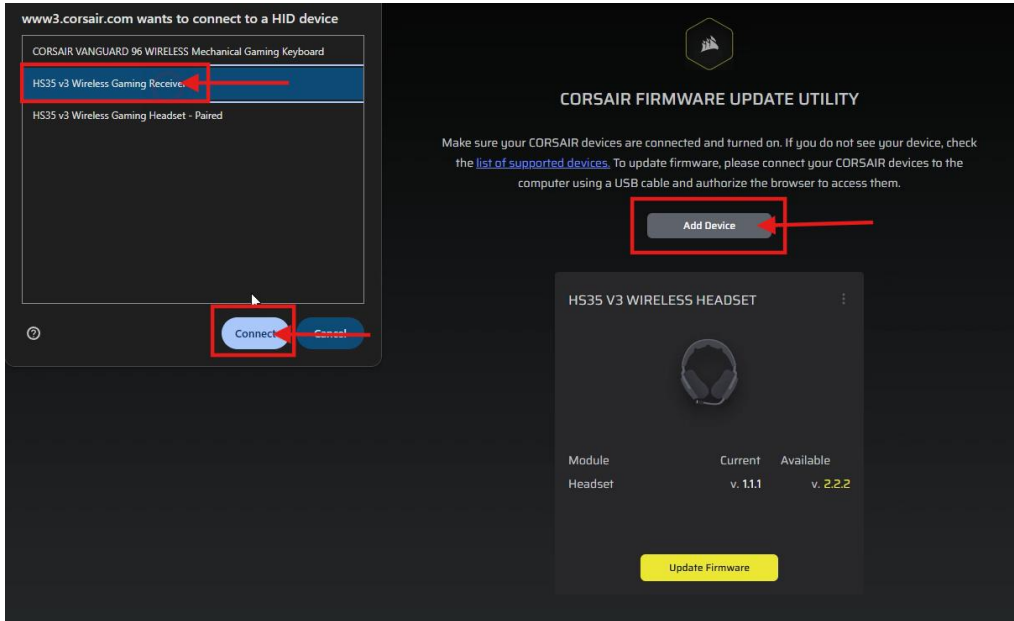

- d. Check the Firmware version and click the 'Update Firmware' button.



HS35 v3 WIRELESS

GAMING HEADSET

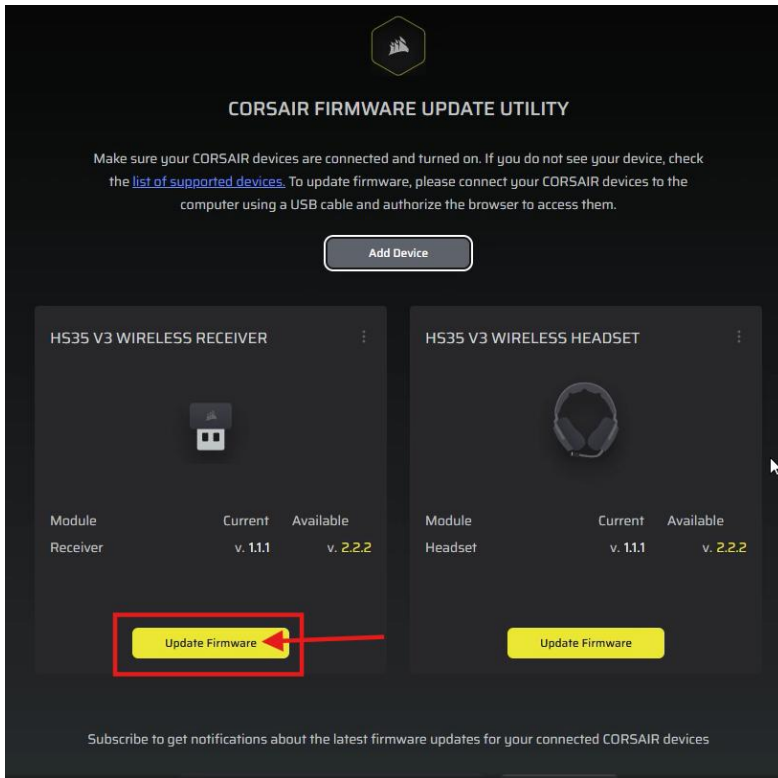

- e. Click the 'Proceed' button, then click the 'Update' button to start updating the firmware once you have read and followed the directions.

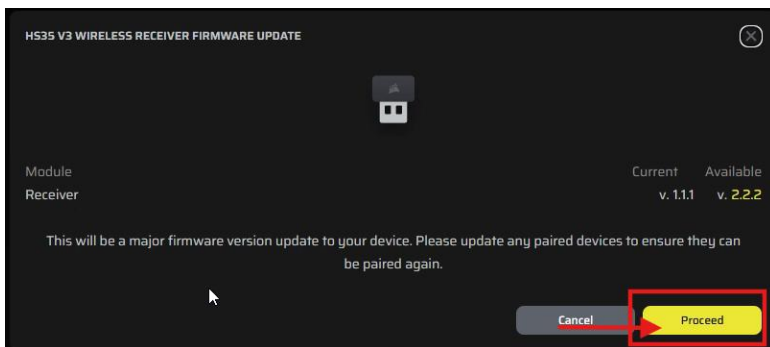



HS35 v3 WIRELESS

GAMING HEADSET

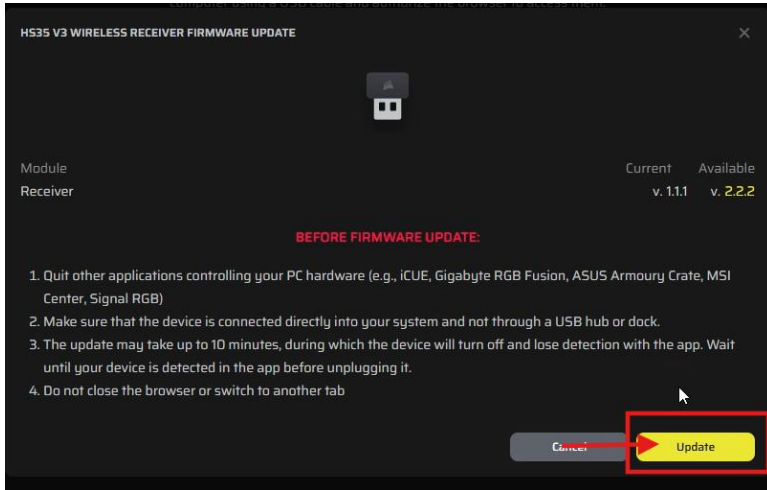

- f. There will be a pop-up window showing the firmware is updated successfully, click the 'Done' button to finish the firmware updating process.

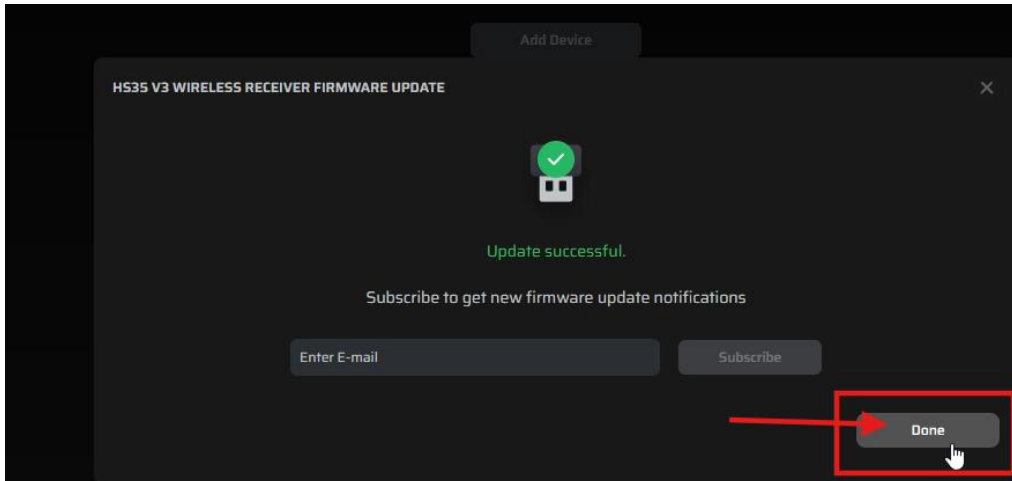

- g. Follow steps 6-8 to update the headset's firmware.



HS35 v3 WIRELESS

GAMING HEADSET

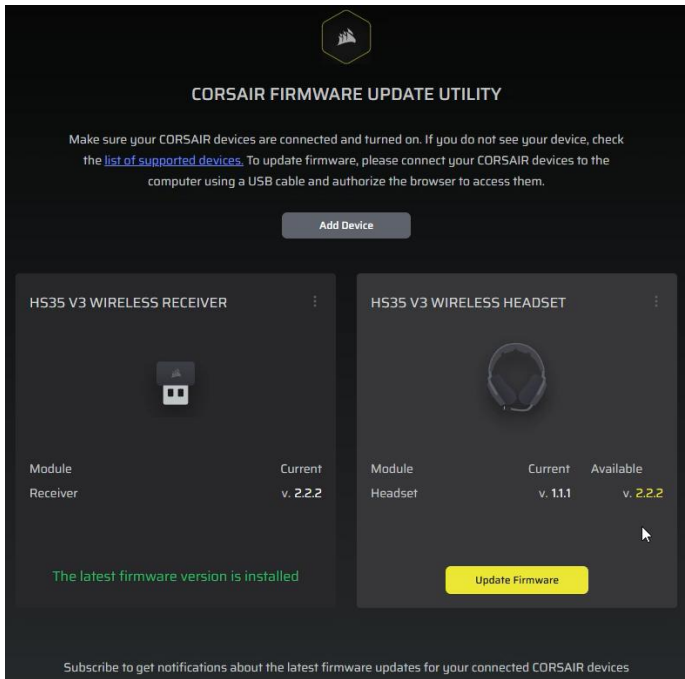

Setting Up Dolby Atmos

Dolby Atmos Spatial Audio can be activated via the Dolby Access app. Download the Dolby Access app via the Microsoft Store. In Dolby Access, it will auto detect the headset if the dongle is connected. The Dolby Access app allows you to choose preset audios modes as well as creating your own custom EQs. You can enable Dolby Atmos for the headset through the Spatial Audio menu in the Windows Sound settings.



HS35 v3 WIRELESS

GAMING HEADSET

1. Click "Get" to download and install Dolby Access.

Dolby Access
Dolby Laboratories

Get ←

+ Offers in-app purchases

Play specified types of media with this extension for Windows 10.

4.6 ★ Average | 814 Ratings

Screenshots

Description

Download Dolby Access to start your free trial of Dolby Atmos for Headphones or set up a Dolby A precision, and realism in your games, movies, and shows with sound that flows all around you — e

Dolby Access also allows you to personalize your audio with custom profiles and discover exclusive

2. Click Open to launch Dolby Access.

Dolby Access
Dolby Laboratories

Open ←

+ Offers in-app purchases

Play specified types of media with this extension for Windows 10.

4.6 ★ Average | 814 Ratings



HS35 v3 WIRELESS

GAMING HEADSET

3. Dolby Access will auto-detect your headset and will be ready to use

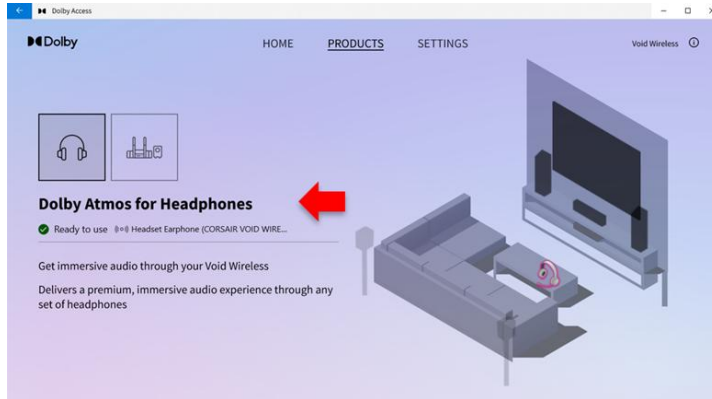

4. To enable Dolby Atmos for your Spatial audio, right-click the speaker icon in your System Tray in the bottom right-hand corner. Select Spatial sound and then choose Dolby Atmos for Headphones for it to be applied.

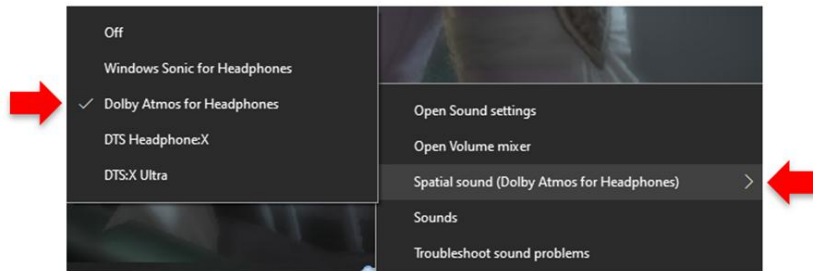



HS35 v3 WIRELESS

GAMING HEADSET

Package Contents



HS35 V3 Wireless Headset



Wireless USB Transmitter



USB cable



HS35 v3 WIRELESS

GAMING HEADSET

Getting To Know the HS35 v3 Wireless Gaming Headset



- A. MULTIFUNCTION BUTTON (MFB)
- B. HEADSET LED
- C. USB CHARGING / DATA PORT
- D. VOLUME WHEEL
- E. HEADSET MICROPHONE LED
- F. WIRELESS USB TRANSMITTER LED

A	MFB	<ul style="list-style-type: none"> a. Press and hold for Power On (2 secs)/ Off (2 secs) b. Short press 1 time for Play/ Pause music c. Short press 2 times to swap between 2.4GHz mode/ Bluetooth Mode
B	Headset LED	<ul style="list-style-type: none"> a. 2.4GHz mode: Static green b. Bluetooth Mode: Static blue c. USB wired Mode: Static white d. Battery charging: Static red
C	USB charging/ data port	<ul style="list-style-type: none"> a. Plug in included USB cable for charging or USB wired Mode
D	Volume wheel	<ul style="list-style-type: none"> a. Press and hold for Bluetooth Pairing (5 secs) b. Short press 1 time for Microphone Mute/ Unmute

Commenté [CC5]: Please replace this with the new image from the QSG that has "Multifunction Button (MFB)".

Commenté [AH6R5]: Updated!



HS35 v3 WIRELESS

GAMING HEADSET

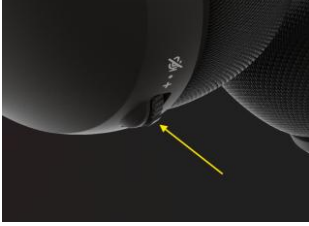
		
		c. Slide up for volume increase, slide down for volume decrease
E	Headset microphone LED	a. Microphone unmute: LED off b. Microphone mute: Static red
F	Wireless USB transmitter LED	a. Headset in 2.4GHz mode and wireless USB transmitter is connected successfully: Static green

Setting Up the HS35 v3 Wireless Headset

2.4GHz mode (PC/MAC/Nintendo Switch/Mobile/PlayStation)

Connect the wireless USB transmitter to any USB (type-A) or USB (type-C) port on your platform.

- h. Press the MFB on the headset for 2 seconds to turn on the headset.
- i. If the headset LED and wireless USB transmitter LED are static green, then you can start to use the headset via 2.4GHz mode.
- j. If the headset LED is static blue, it means the headset is in Bluetooth Mode, short press the MFB 2 times to change mode to 2.4GHz mode. The headset LED and wireless USB transmitter LED will turn to static green, then you can start to use the headset via 2.4GHz mode.

*When using 2.4GHz mode via the USB Type-A wireless USB transmitter, ensure the USB Type-C wireless USB transmitter is properly connected to the USB Type-A USB transmitter.



** The headset is designed to operate at a range of up to 60 feet (20m) from the wireless USB transmitter, but other wireless devices, electronics, and obstructions such as walls may impact the connection range.

Bluetooth Mode (PC/MAC/Nintendo Switch/Mobile)



HS35 v3 WIRELESS

GAMING HEADSET

Press the MFB on the headset for 2 seconds to turn on the headset.

- k. If the headset LED is static blue, then you can start to use the headset via Bluetooth Mode.
- l. If the headset LED is static green, it means the headset is in 2.4GHz mode, short press the MFB 2 times to change mode to Bluetooth Mode. The headset LED will turn to static blue, then you can start to use the headset via Bluetooth Mode.

Bluetooth Pairing Mode

- m. The very first time you turn on your headset and enter Bluetooth Mode, Bluetooth pairing mode is automatically enabled for you to help you easily connect your Bluetooth device.
- n. To manually enable pairing mode for your Bluetooth device at a later time, set the headset to Bluetooth Mode, press the volume wheel for 5 seconds until the Headset LED blinks blue. Upon pairing a Bluetooth device to your headset, powering on the headset will now also automatically turn on Bluetooth and connect to the paired device in the background. Powering off the headset will turn off all wireless connections.

USB Wired Mode(PC/MAC/Nintendo Switch/Mobile/PlayStation)

Connect the headset with the bundled USB cable on your platform. The headset will automatically enter USB wired mode.

- o. The headset LED will be static white if it is fully charged in USB wired mode. The headset LED will be static red if the headset is charging, will turn static white when the headset is fully charged.

*When the headset in 2.4GHz mode or Bluetooth mode, connecting a USB cable automatically switches audio to the USB-connected device.

NOTES:

- p. When using the headset in 2.4GHz mode or Bluetooth mode, please ensure the connected device's audio output is set to HS35 v3 Wireless.
- q. When using the headset on PlayStation console, we recommend using the PlayStation UI to set "Output to Headphones" to "All Audio". Adjust volume control (Headphones) to maximum level. Then adjust volume with the headset volume control.
- r. Prolonged listening at high volumes may adversely affect your hearing. Take breaks between sessions and always begin with the volume at a low level before increasing.

For Optimal Wireless Performance

- Place the USB wireless transmitter in an open, unobstructed area.



HS35 v3 WIRELESS

GAMING HEADSET

- Make sure the battery is fully charged before initial use.
- Do not leave the battery fully discharged for long periods. Battery life is maximized by keeping the battery in a partially charged state.
- Keep the headset at room temperature (20-30 °C or 68-86 °F).

Listening to Music

To play a track, short press the MFB. To pause playback, short press the MFB again.

Microphone Control

- Short press volume wheel 1 time for Microphone Mute/Unmute.
- Microphone LED will be static red when microphone is muted. Microphone LED off when microphone unmute in a call.
- The headset will sound when the microphone is muted or unmuted.

Charging Before First Use

The headset must be fully charged before its first use. Connect the USB charging cable to any working USB port on your PC, then connect the other end of the USB charging cable to the headset.

LED Indicator Guide

	Headset LED	Microphone LED	Wireless USB transmitter LED
Power on	Green light for 1 second	X	X
2.4GHz mode	Static green	<ul style="list-style-type: none"> • Static red when microphone mute is muted. • LED off when microphone is unmuted. *The headset will play a sound when the microphone is muted or unmuted.	Static green
Bluetooth Mode/Bluetooth pairing successfully	Static blue		X
USB wired Mode	<ul style="list-style-type: none"> • Static white if the headset is fully charged. • Static red if the headset is charging, will turn static white when the headset is fully charged. 		X
Low battery reminder	Breathes red when battery is below 20%		<ul style="list-style-type: none"> • Static green in 2.4GHz mode. • LED off in Bluetooth Mode.
Low power shutdown	Red light flashes 1 time	X	X
Bluetooth Pairing Mode	Blinking blue		



HS35 v3 WIRELESS

GAMING HEADSET

Manufactured under license from Dolby Laboratories. Dolby, Dolby Atmos® and the double-D symbol are trademarks of Dolby Laboratories Licensing Corporation.



PRICING

REGION	MSRP	REGION	MSRP
United States	\$79.99	Australia / New Zealand	AUD 99
Canada	CAD \$79.99	Japan	¥9,980
Europe	€79.99	South Korea	₩99,000
United Kingdom	£69.99	Southeast Asia	\$79.99
Nordic	SEK \$890		

CONTACTS

REGION	REPRESENTATIVE	CONTACT INFORMATION
USA and Canada	Andrew Williams	andrew.r.williams@corsair.com
UK and Nordics	Jordan Winslow	Jordan.Winslow@corsair.com
EMEA	Stefan Quiring	stefan.quiring@corsair.com
Iberia and Italy	Andre Ribeiro Henriques	andre.henriques@corsair.com
Latin America	Juan Pablo Kempster	juanpablo.kempster@corsair.com
APAC	Oscar Tseng	oscar.tseng@corsair.com
Korea	Jin Hyuk Kim	jin.kim@corsair.com
Vietnam	Phuong Doan	phuong.doan@corsair.com
Product Manager	Amber Hung	Amber.Hung@corsair.com



HS35 v3 WIRELESS

GAMING HEADSET