

COMMAND SERIES KB7 – QSG

1

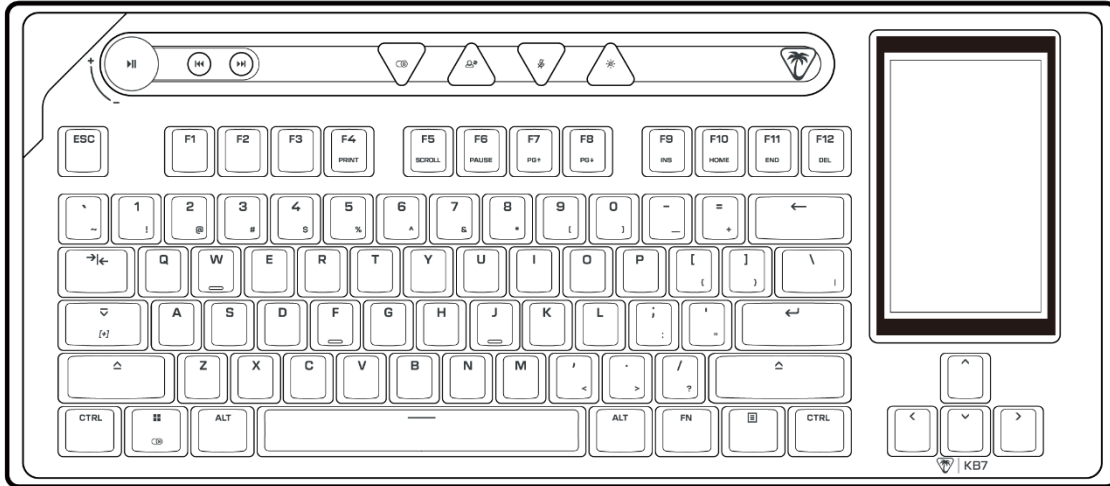

4

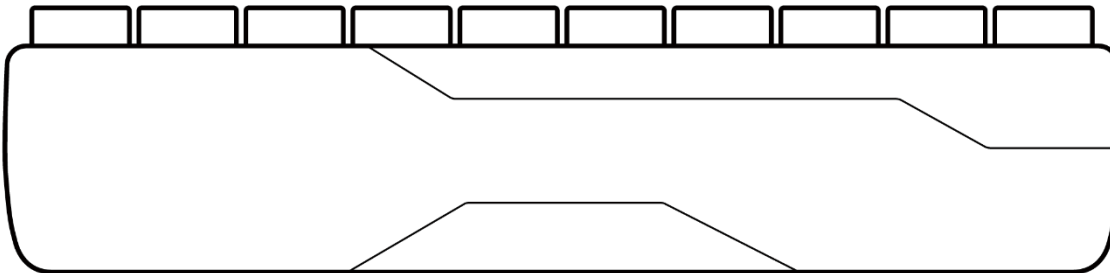

2

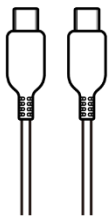

3

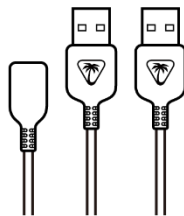

5

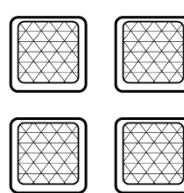

6



PACKAGE CONTENTS

1. Turtle Beach® Command Series KB7
2. USB-C to USB-C Cable
3. USB-C to 2x USB-A Adapter
4. Illuminated Wrist Rest
5. Extra grippy WASD Textured Keycap
6. Keycap Puller

SETUP

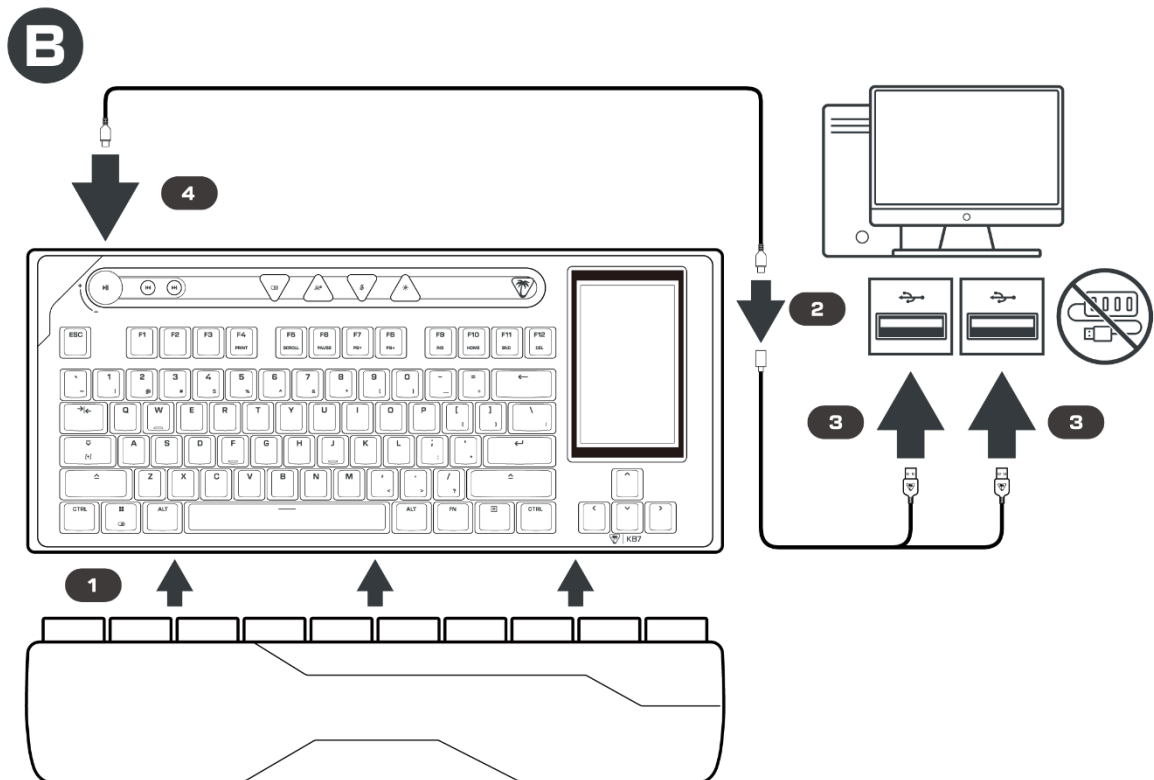
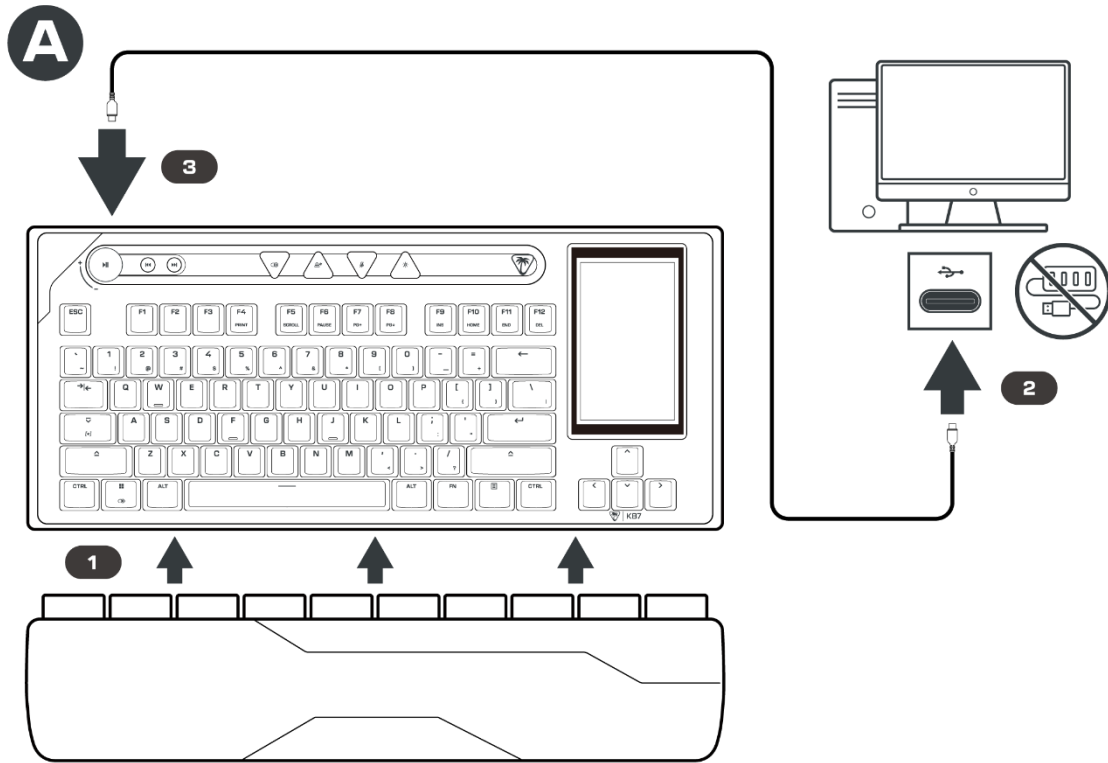

A. USB-C connection

1. For a more ergonomic position, fold out the stands on the base of the keyboard and install the palm rest by inserting it on the front palm rest port. **ATTENTION:** Make sure the palm rest is fully slot into the keyboard for the best RGB experience.
2. Connect the USB-C cable directly to the USB-C plug of your PC, skip to step 5.
ATTENTION: do not use a USB hub, the power output might not be enough to power the keyboard resulting on screen, RGB or input malfunction.
3. Connect the USB-C cable to the Keyboard

B. 2 x USB-A connection

1. For a more ergonomic position, fold out the stands on the base of the keyboard and install the palm rest. Make sure the palm rest is fully slot into the keyboard for the best RGB experience
2. Connect the USB-C cable to the USB-C plug of the 2 x USB-A adapter cable.
3. Connect both 2 x USB-A cable directly to the USB-A plug of your PC.
ATTENTION: do not use a USB hub, the power output might not be enough to power the keyboard resulting on screen, RGB or input malfunction.
4. Connect the USB-C cable to the Keyboard

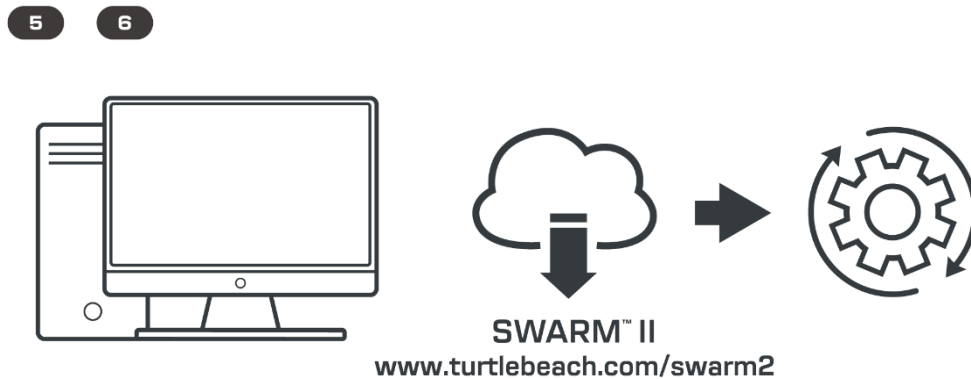

Driver installation

5. Navigate to www.turtlebeach.com/swarm2 and download the latest driver software.
6. Complete the installation to get access to all display, software features and setup.

KEYBOARD CONNECTIVITY

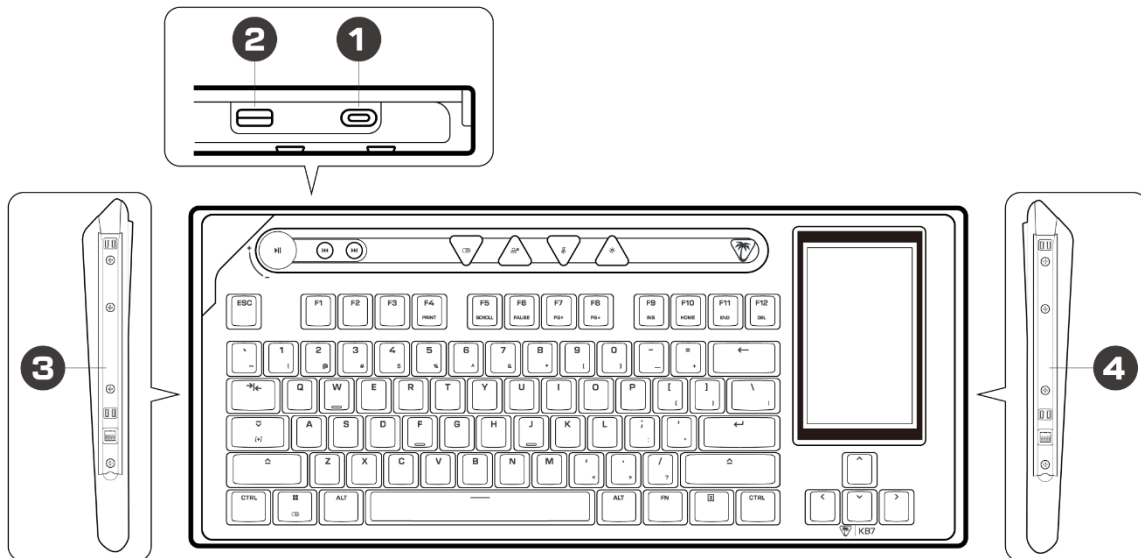

1. USB-C Power port
2. USB-A Pass-through
3. Left rail module power connection
4. Right rail module power connection

ACTION BAR DEFAULTS BINDING

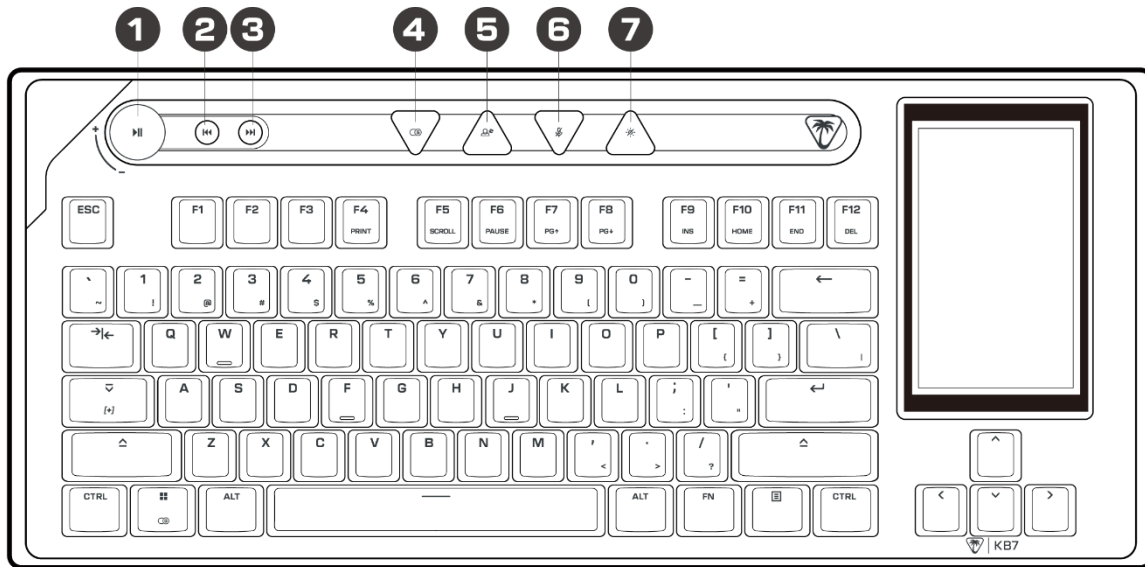

ITEM	DEFAULT BINDING
1	<ul style="list-style-type: none"> • Wheel rotate clockwise volume up • Wheel rotate counterclockwise volume down • Push – Play/Pause
2	Previous Track
3	Next track
4	Profile Cycle
5	Game mode toggle
6	Microphone off (Swarm II required)
7	RGB On/Off

ADDITIONAL FN FUNCTIONALITY

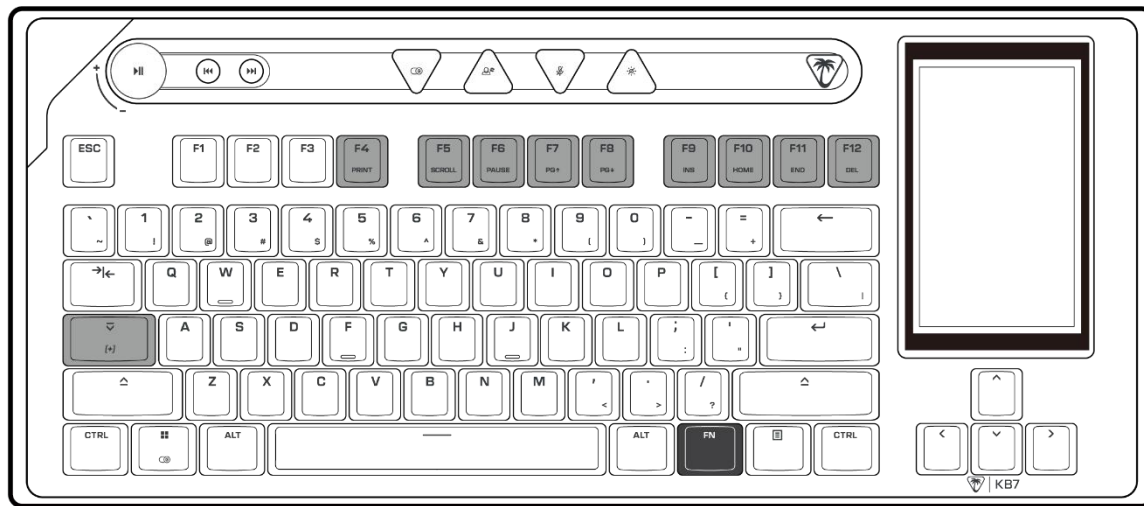

STANDARD

SHORTCUT	BINDINGS
FN + F4	Print Scr
FN + F5	Scroll
FN + F6	Pause
FN + F7	PG up
FN + F8	PG down
FN + F9	Ins
FN + F10	Home
FN + F11	End
FN + F12	Del

LED CONTROL KEYS

FN + SHORTCUT	BINDINGS
FN + CURSOR LEFT	Previous RGB effect
FN + CURSUR RIGHT	Next RGB effect
FN + CURSOR DOWN	RGB brightness down
FN + CURSOR UP	RGB brightness up
FN + ALT right	Color Cycle

AI

SHORTCUT	BINDINGS
FN + MENU	Copilot shortcut

COMMAND DISPLAY MAP CLIP ART OF SCREEN UI

Located above the arrow keys, the 4.3" Command Touch Display combines keyboard inputs, hotkeys, launching apps and advanced function such as multimedia, advance volume control, 3rd party software integration. Each of the 5 on-board profiles has 3 dedicated pages, each with up to 12 virtual buttons, for a total of 36 customizable input, a volume management page and a setting menu for control setting on-the fly.

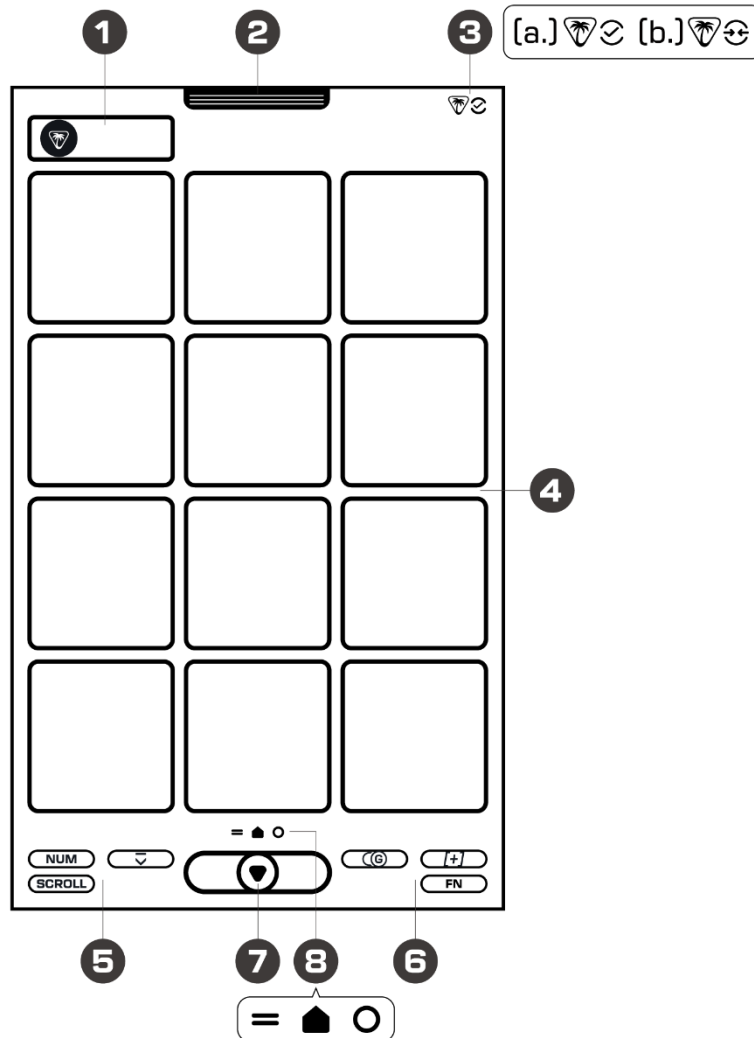

ATTENTION: Some of the widgets will be available only after SWARM II Software installation and to work properly they will need the software to be open in the background and connected (connection status 3 a.). Images for explanation purpose only, actual screen appearance might differ from imagery according to feature availability or FW version.

1. Tap to cycle across profile 1 to 5
2. Tap setting menu button to access on-board setting pages
3. Swarm II connection sync status
 - o a. Connected
 - o b. Disconnected

4. Widget area grid
5. Keyboard status indicators:
 - Caps lock
 - Num lock
 - Scroll Lock
6. Layer indicators:
 - FN
 - Game mode
 - Easy-shift
7. Tap to home page button to quick access home page
8. Breadcrumbs page navigation pattern

COMMAND DISPLAY SETTING CLIP ART OF SCREEN UI

ATTENTION: Some of the widgets will be available only after SWARM II Software installation and to work properly they will need the software to be open in the background and connected (connection status 3 a.) Images for explanation purpose only, actual screen appearance might differ from imagery according to feature availability or FW version.

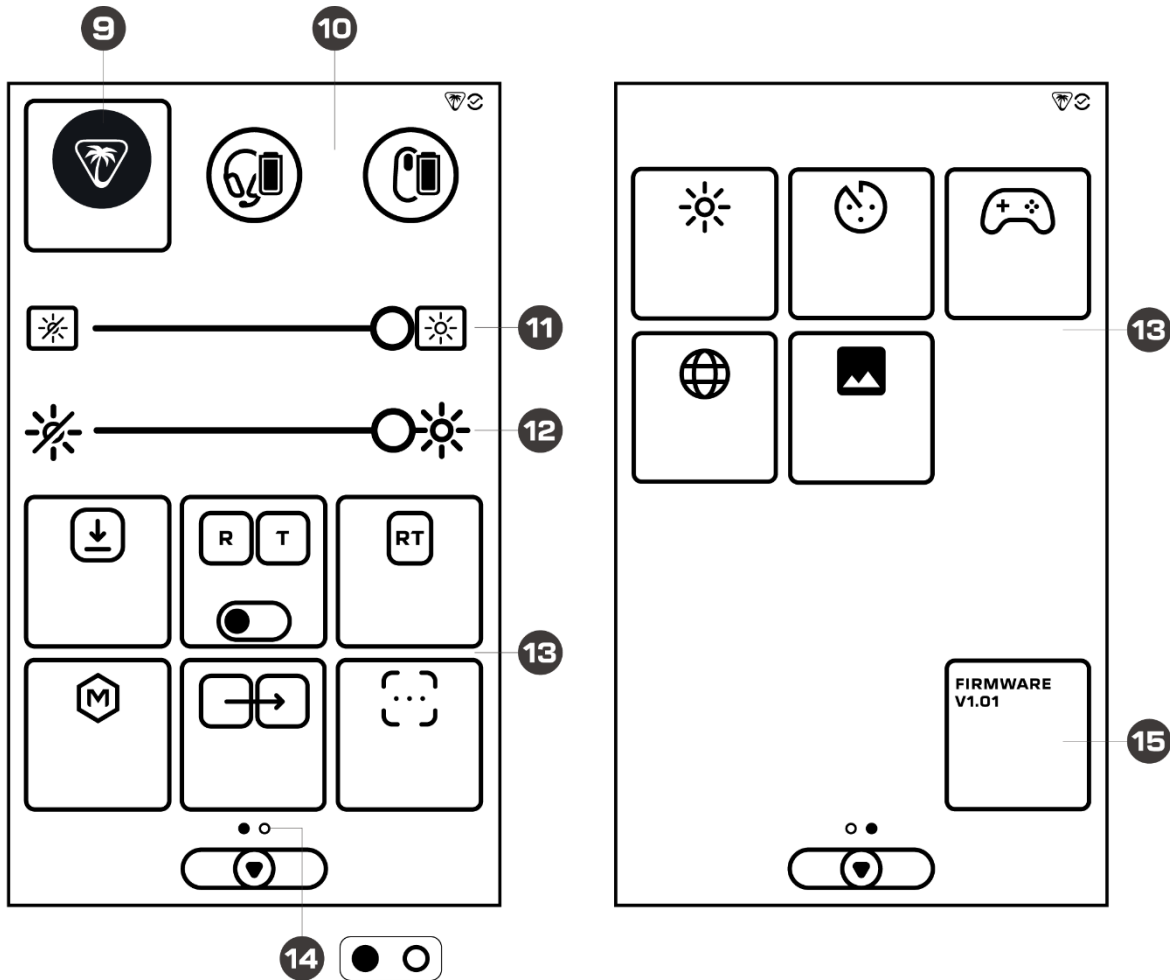

9. Tap to cycle across profile 1 to 5
10. Wireless device battery status
ATTENTION: Work only with other Turtle Beach compatible devices.
11. Display brightness slider
12. Keyboard RGB brightness slider
13. Setting widget area, tap to access each dedicated-on board setting page such as actuation point, react tap, rapid trigger, macro recording, hotkey assignment and more.
14. Breadcrumbs setting navigation pattern
15. FW version

COMMAND DISPLAY AUDIO MIXER CLIP ART OF SCREEN UI

ATTENTION: The Audio mixer will work only after SWARM II Software installation and to work properly the software needs to be open in the background and connected (connection status 3 a.). Images for explanation purpose only, actual screen appearance might differ from imagery according to feature availability or FW version.

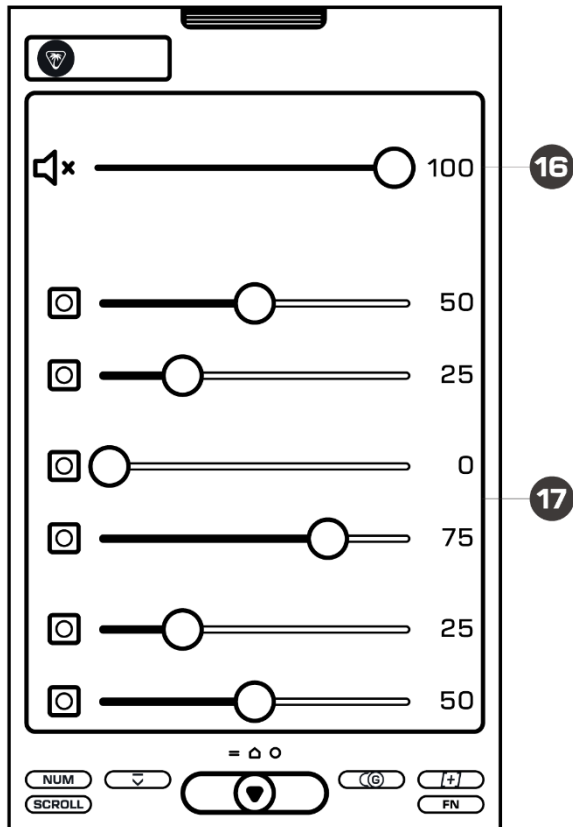

16. System volume slider

17. Windows volume mixer channel's sliders.

COMMAND DISPLAY NAVIGATION CLIP ART OF SCREEN UI

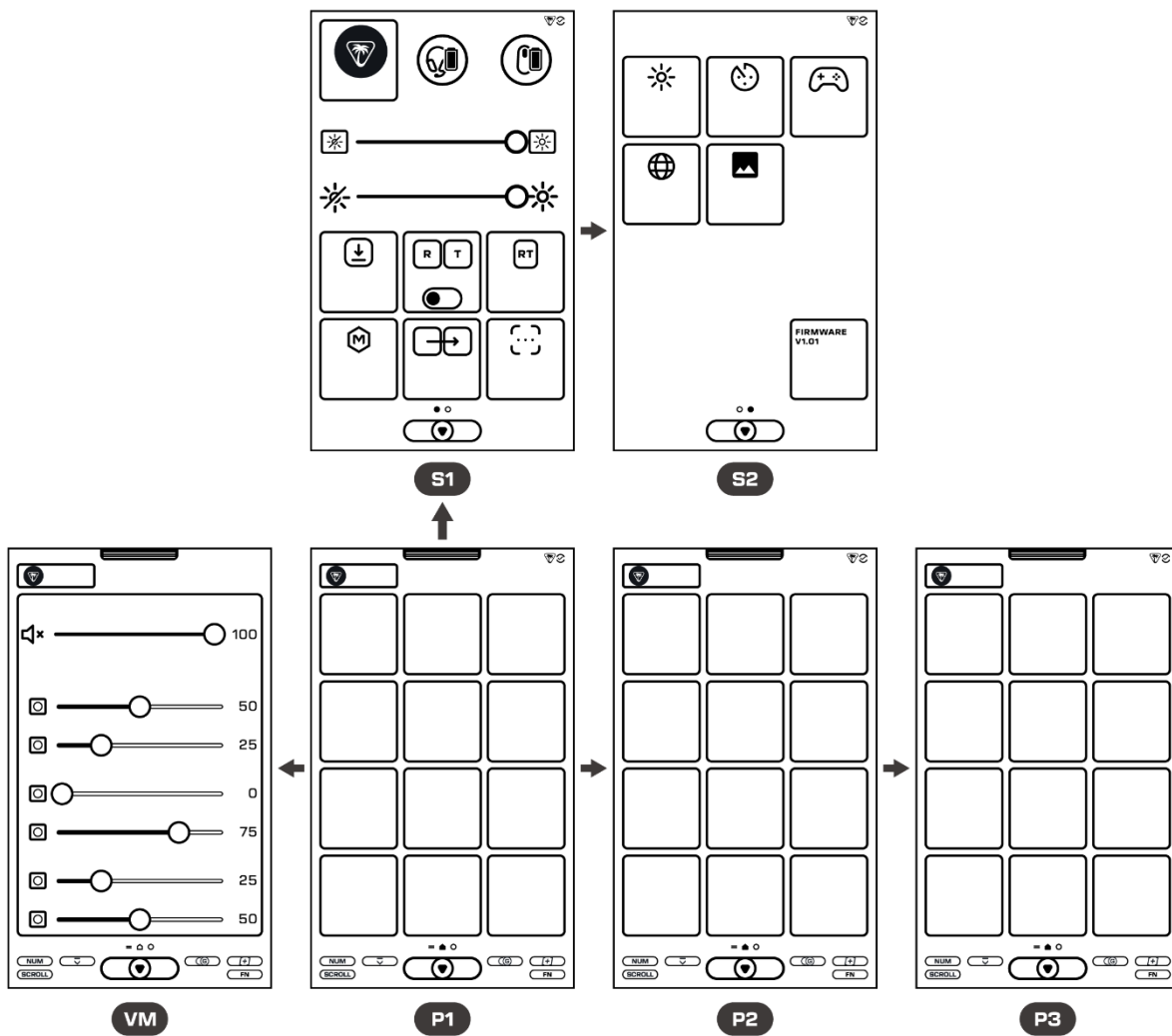

VM – Volume Mixer Page

P1 – Widget Page 1 (Home)

P2 – Widget Page 2

P3 – Widget Page 3

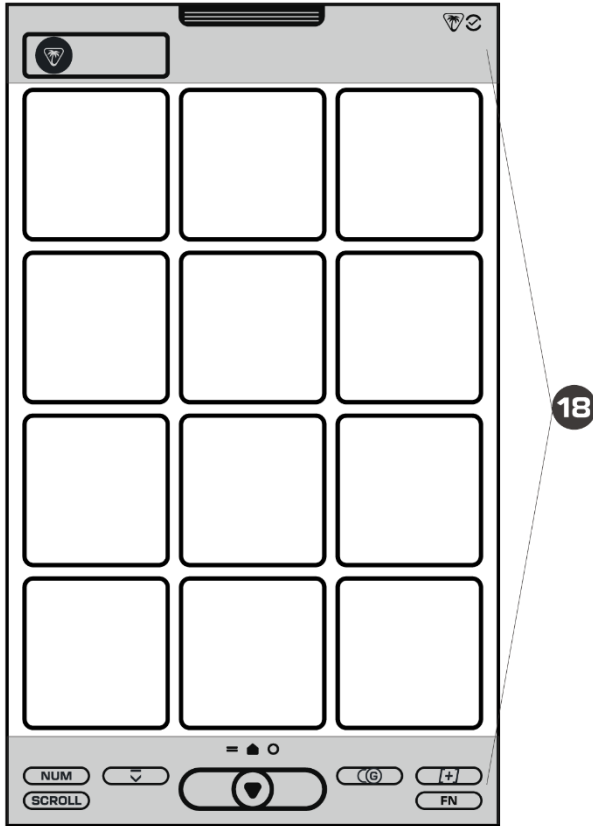

S1 – Setting Page 1

S2 – Setting Page 2



18. Swipe active navigation areas.

NAVIGATION INSTRUCTIONS

- By default, the first page on the display is P1 the HOME and main page: you can always return to the HOME page and quickly access it by tapping on 7  HOME PAGE BUTTON.
- To navigate the Command Touch Display pages VM, P1 -3 simply swipe left or right on the highlighted area on top and bottom of the screen 18, breadcrumbs patterns 8 will show your current location on the widget page VM, P1 – 3 and pattern 14 the setting pages S1-2.
ATTENTION: Swiping on area outside the 18, will be registered but it might involve involuntary trigger of the widget input.
- To access the on-board setting menu, press 2  SETTING PAGE BUTTON; to exit the setting menu or a setting widget tap on 7  HOME PAGE BUTTON.

TECHNICAL SPECIFICATIONS

- **Form Factor:** TKL
- **Connectivity:** USB-C or 2 x USB-A Wired
- **Cable:** 1.8m / 5.9ft Detachable USB-C + 0.2m 2 x USB-A Adapter Cable
- **Lighting:** RGB Per-Key Illumination + Palm Rest
- **Switches:** Low Profile Hall Effect Magnetic Switches
- **Actuation Point:** Adjustable 0.1 - 3.2mm
- **Switch Lifecycle:** 100M Keystrokes
- **Processors:** Dual Core 32-bit ARM Cortex M3 and 32-bit ARM Cortex M4
- **Screen:** 4.3" Colors Touchscreen Display
- **Polling Rate:** 8000 Hz
- **Adjustable Height:** Yes, Double Kickstand
- **Keyboard Rollover:** Full Key, Anti-Ghosting
- **On-Board Memory:** 32MB
- **Software:** Swarm™ II
- **Product Weight:** 858g/1120g (with palm rest)
- **Product Dimensions:** 399x256x31 mm (with palm rest)

SYSTEM REQUIREMENTS

- Windows 10 and above (software support)
- Direct PC connection USB-C 3.0 (or higher) or 2 x USB-A 2.0 (or higher). **USB hubs not supported.**
- Internet Connection (for driver software)