

QUICK START GUIDE

PARTYBOX ENCORE ESSENTIAL2

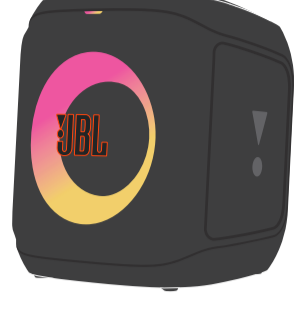

WHAT'S IN THE BOX



*Power cord quantity and plug type vary by regions.

BLUETOOTH PAIRING

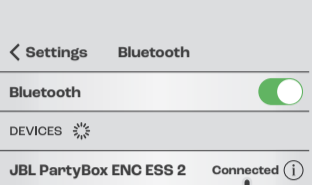

PLAY

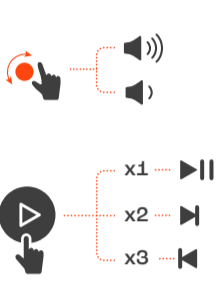

LIGHTSHOW

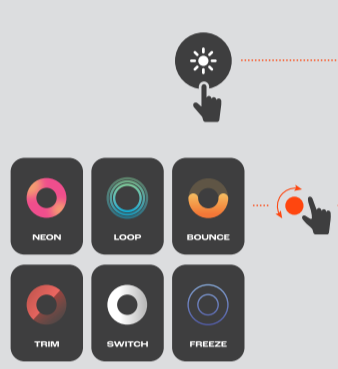

Apply lightshow presets and more with the JBL PARTYBOX app.

APP



Download and install the JBL PARTYBOX app to get more from the product.



JBL PARTYBOX

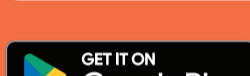

MICROPHONE



GUITAR

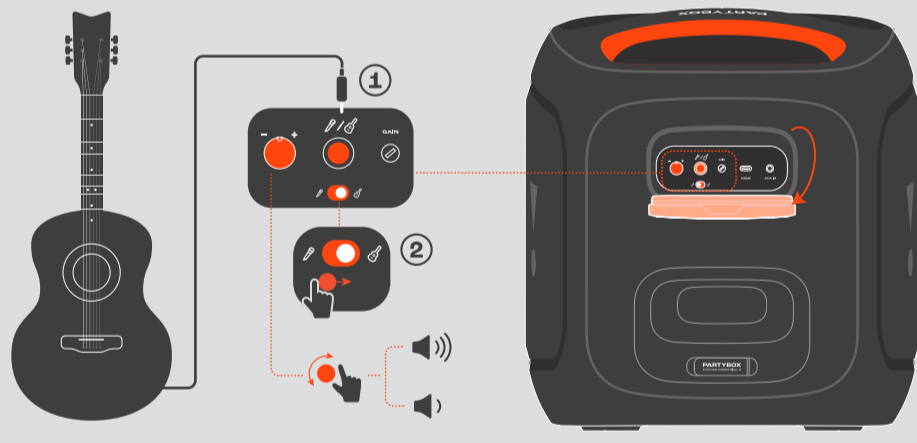

MULTI-SPEAKER CONNECTION

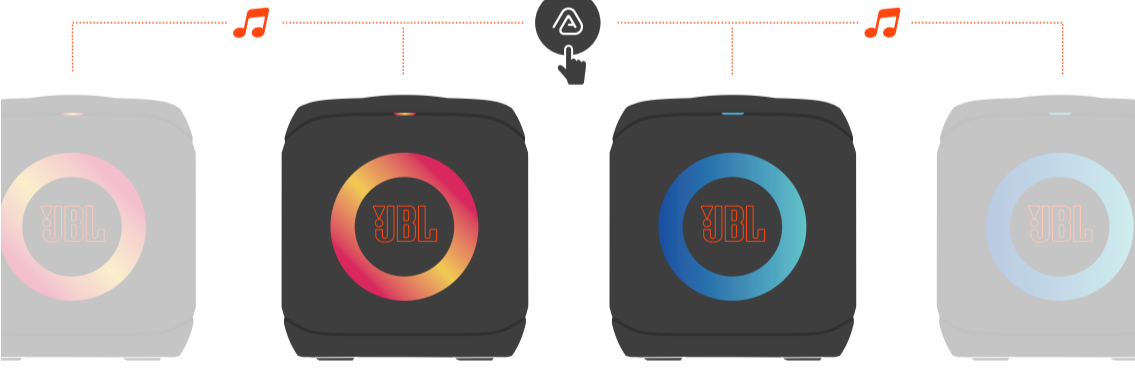

CHARGING



BATTERY REPLACEMENT

1 Remove the Old Battery

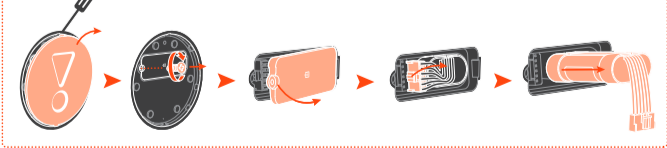

2 Insert the New Battery



Replacement batteries can be purchased from the JBL Customer Service Center.

SPLASH PROOF IPX4



Do not charge your speaker until it is completely dry and clean.

