

∅ = 

∅ =  20-42 mm

0079

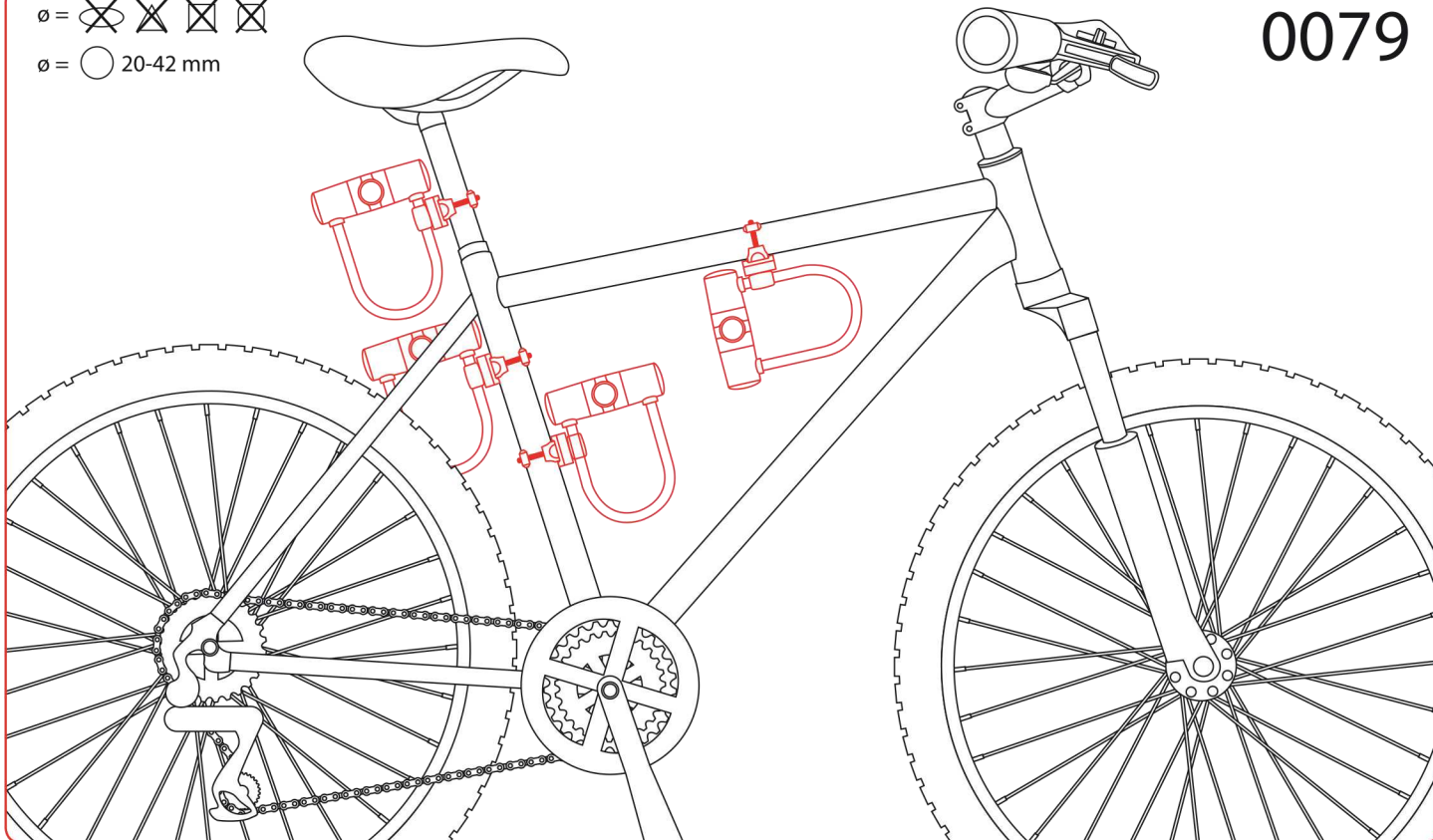

MOUNTING THE BRACKET

Rubber end protector*

35 mm
 $\varnothing = 20-30$ mm

50 mm
 $\varnothing = 30-42$ mm

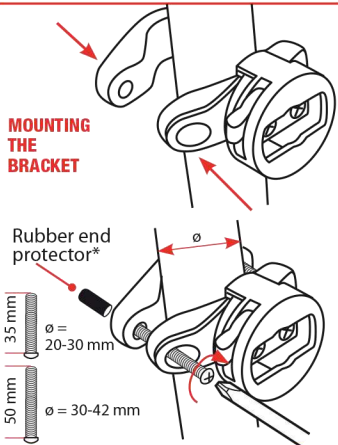

BRACKET ANGLE ADJUSTMENT

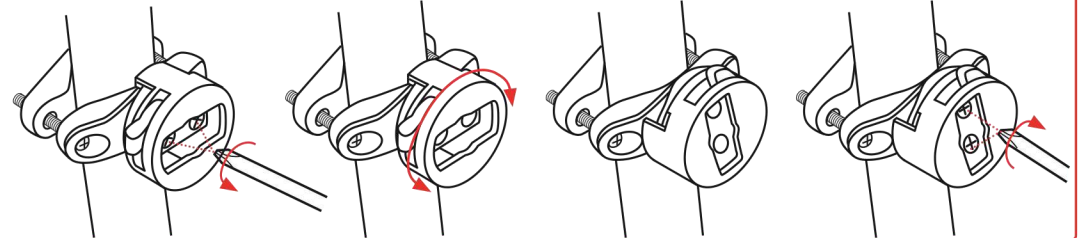

SECURING LOCK ON THE BRACKET

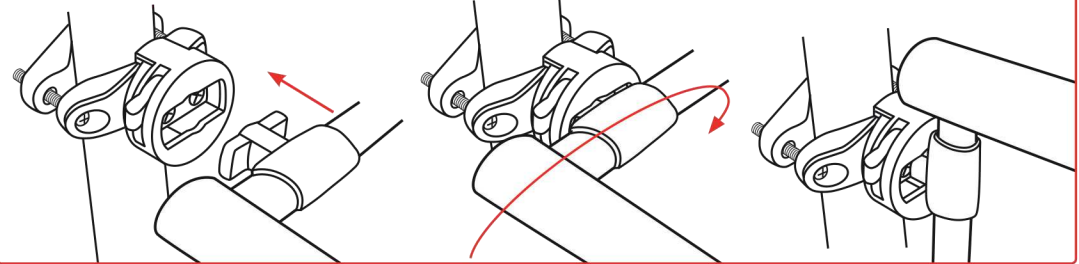

SPLINE ADJUSTMENT

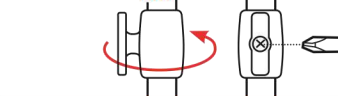

⚠ Please check before riding correct mounting and function of the product!
 Avant chaque sortie vérifier si le montage est correct et si le produit fonctionne!
 Bitte prüfen Sie vor jeder Fahrt die korrekte Montage und die Funktion des Produktes!
 Antes de cada salida verifi car si el montaje es correcto y si el producto funciona!
 Prima di iniziare un viaggio controllare sempre la correttezza di montaggio e di funzionamento del prodotto!
 Antes de cada saída, verifi car se a montagem está correcta e se o produto funciona!
 Test u voor de rit de juiste montage!

REMOVING LOCK FROM THE BRACKET

