

# LISTO

## Congélateur Armoire CAL145-55hob4

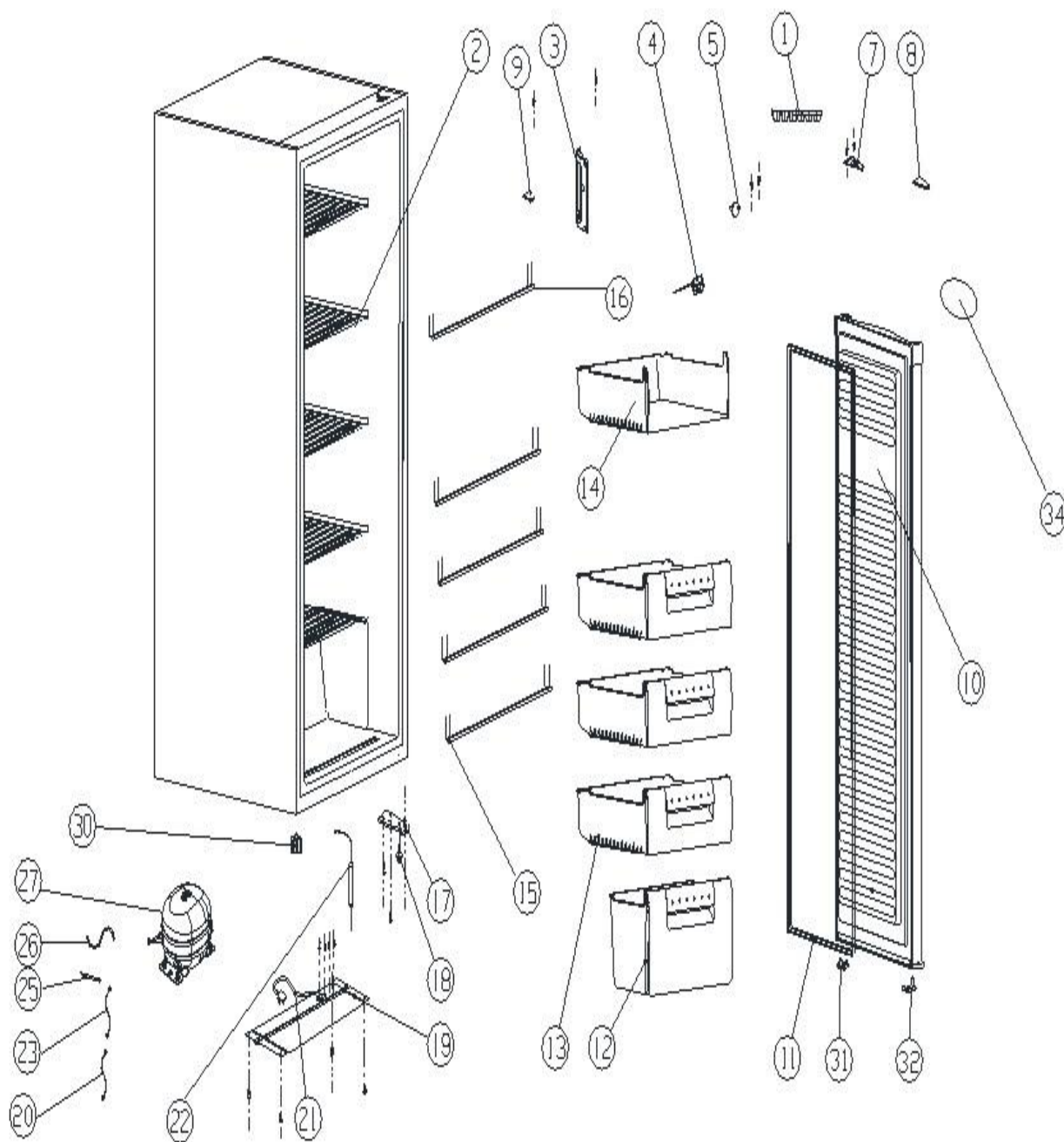



## Congélateur Armoire CAL145-55hob4

N° VUE	REF PIECE	DESIGNATION (FR)	DESIGNATION (ENG)	INFORMATION
1	9011615	bac a glaçon	Ice tray	
5	9011991	Bouton (thermostat)	Thermostat knob	
7	9014952	CHARNIERE (PORTE CONGELATEUR)	Upper door hinge assembly	
8	9014951	CACHE (CHARNIERE PORTE CONGELATEUR)	Door hinge cover	
9	9009221	Cache vis (top)	Screw cover of door hinge	
10	9015945	PORTE (CONGELATEUR)	Door	
11	9015946	JOINT (PORTE CONGELATEUR)	Door gasket	
12	9015947	BAC INFERIEUR	Lower Drawer	
13	9015948	BAC INTERMEDIAIRE	Middle Drawer	
14	9015949	BAC SUPERIEUR	Upper Drawer	
15	9015950	BAGUETTE (EVAPORATEUR)	Shelf breaker	
16	9015951	BAGUETTE SUPERIEURE (EVAPORATEUR)	Top shelf breaker	
17	9007476	CHARNIERE INFERIEURE (PORTE)	Lower door hinge assembly	
18	9007480	PIED	Short adjust foot	
19	9007478	BASE (COMPRESSEUR)	Compressor base support	
21	9007479	CABLE ALIMENTATION	Power supply cord with plug	
22	9015952	DESHYDRATEUR	Drier filter	
23	9005164	Filerie mise a la terre (compresseur)	Grounding wire of compressor	
25	9005167	Joint tuyau echappement	Process tube	
26	9005166	Tube de liaison	Connecting tube	
27	9015953	COMPRESSEUR	Compressor	
30	9007477	PIED AJUSTABLE	Long adjust foot	
31	9007468	AIDE FERMETURE DROIT (PORTE)	Lower door right aid-closer	
32	9007469	AIDE FERMETURE GAUCHE (PORTE)	Lower door left aid-closer	

### Diagram of circuit

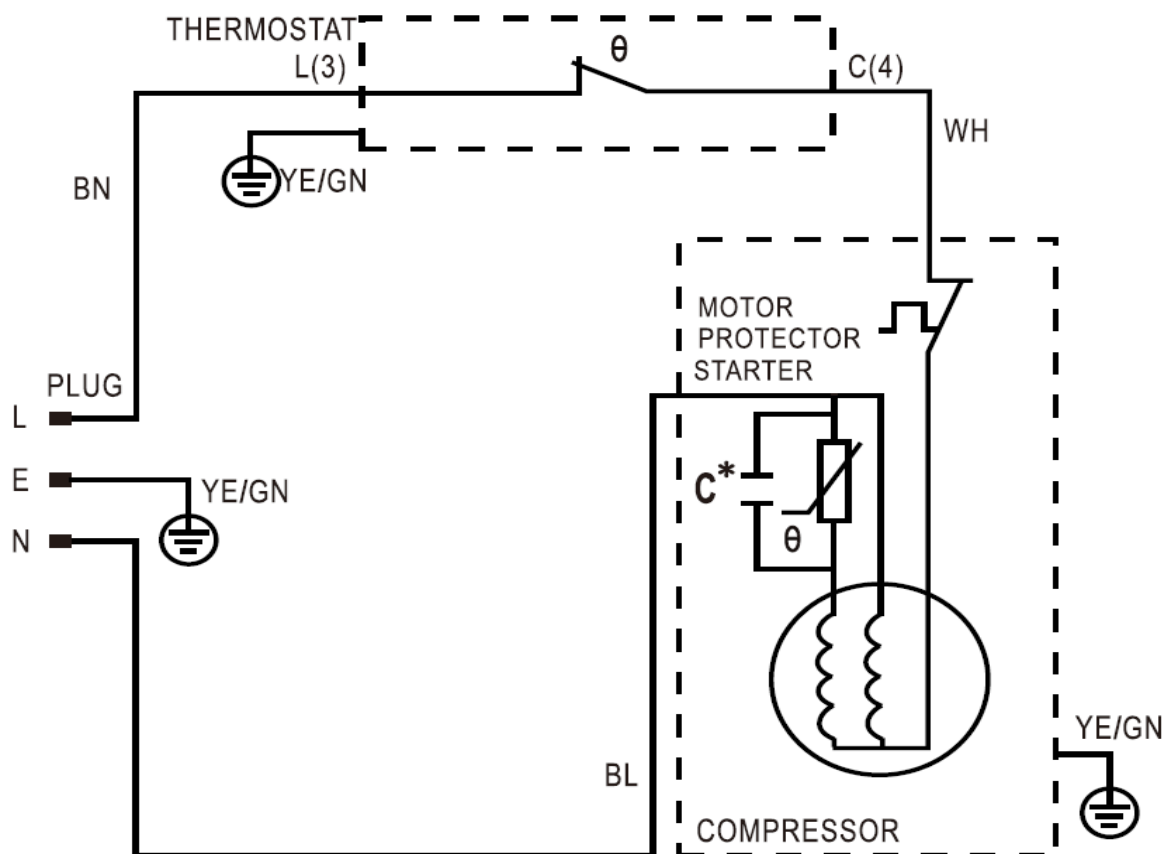

**C\***: The capacitor is optional according to different compressor model

# LISTO

## Congélateur Armoire CAL145-55hob4

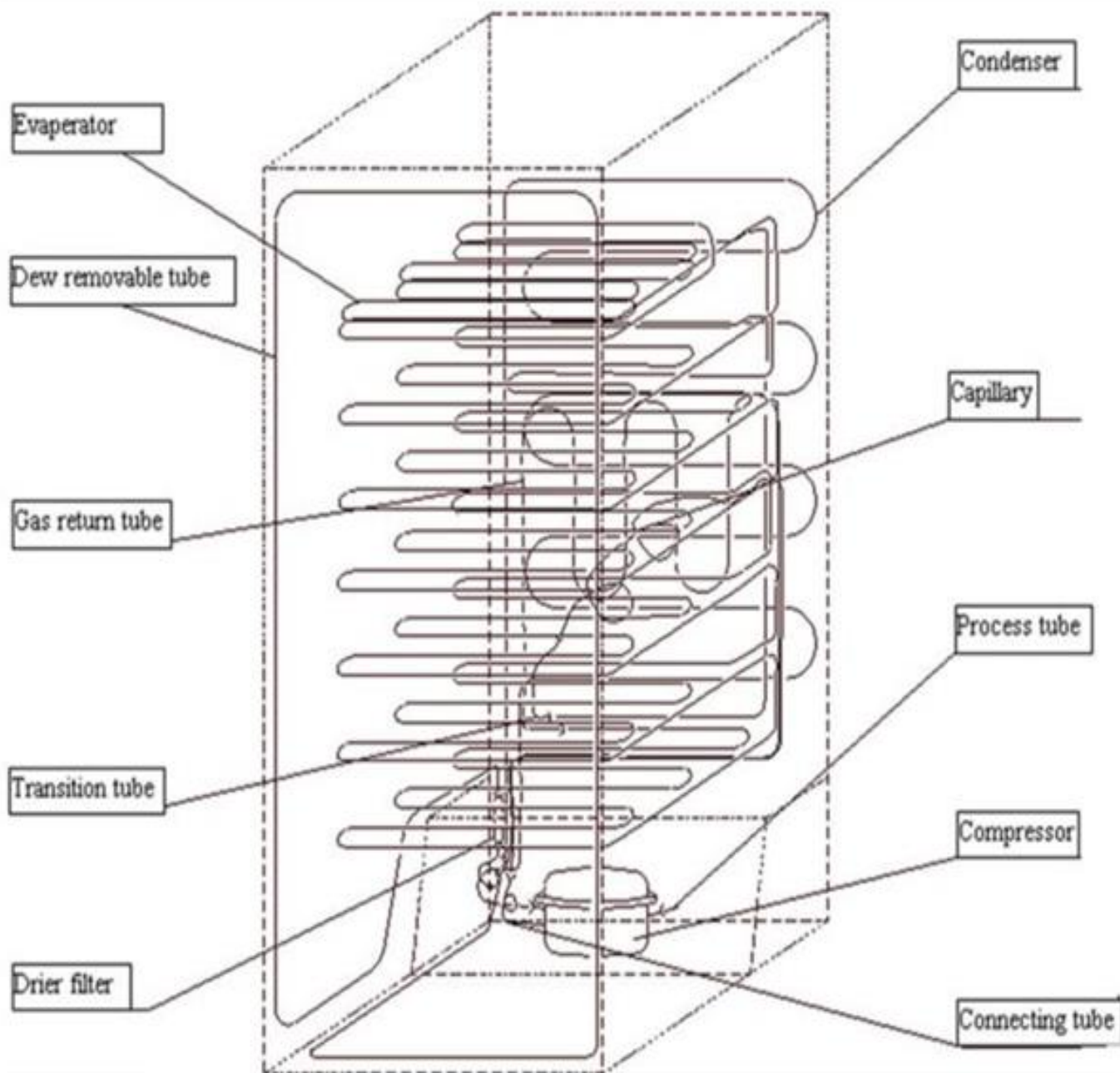

# LISTO

## Congélateur Armoire CAL145-55hob4

### Trouble shooting guide

No	Problem	Possible Cause	What To Do
1	Fan no work, Freezer room temperature no enough cold and refrigerator room temperature Ok and compressor running, but no air in freezer air outlet.	the fan motor is failure and replace it with a new one	open the cover board of air duct in freezer room, check the fan if it no running, then measure the voltage between the red wire and black wire of fan, if the voltage is 12V, the fan motor is failure and replace it with a new one
		the failure of the inner wire to fan connector	measure the voltage between the CN2 red and black wire of PCB, if the voltage is 12V, then check from the inner wire to fan connector
		the PCB failure and change a new PCB	measure the voltage between the CN2 red and black wire of PCB, if the voltage is zero, then the PCB failure and change a new PCB.
2	No defrost. Freezer room temperature no enough cold and refrigerator room OK and open the cover board of are duct and find ice formation on evaporator	the drainpipe contain impurity	disconnect power, and let the ice defrost and inspect the water if it is flow through the drainpipe, if could not flow out, check if it contain impurity and clean the drainpipe
		the sensor failure or PCB failure	check the fuse if it is melt or not. If the fuse is melt, it mean that the sensor failure or PCB

# LISTO

## Congélateur Armoire CAL145-55hob4

			failure, need change the sensor or PCB.
		the defrost heater is break or PCB failure	inspecting the CN4 defrost heater two connector.If the heater is OK then it must be PCB failure and change the PCB.
3	the temperature of freezer and refrigerator are no enough cold and the temperature no change by adjusting the potentiometer (thermostat)	the potentiometer failure	inspect the potentiometer (thermostat), and measure the resistance value by adjusting the potentiometer (thermostat), if the resistance value no change by adjusting the potentiometer (thermostat),
		the sensor failure	When the sensor failure and the compressor will be running like this—if the potentiometer (thermostat) setting below 3 position, the compressor will be running 20 minutes and then stop 30 minutes, if the potentiometer (thermostat) setting more than 3 position, the compressor will be running 30 minutes and then stop 20 minutes. If find the compressor work like above situation, it mean the sensor failure and need open the back of refrigerator and change sensor of refrigerator evaporator

# LISTO

## Congélateur Armoire CAL145-55hob4

4	LED no light	the led failure	Open the refrigerator door and measure the voltage of CN3 in PCB, if the voltage is zero then it mean the connecting wire failure and if the voltage is 12V, it mean the led failure
		the switch circuit is failure	If the CN3 voltage no 12 V and then check the CN4 voltage, if the voltage CN4 no change by close and pen door, it mean the switch circuit is failure.
5	Compressor no starting	no problem	the time between two starting is shorter than 12min; or refrigerator room temperature is lower than the setting temperature, in this case, it is no problem. You need waiting more time.
		PCB failure	PCB had automatic self-examination: open the cover of PCB at the back of product, plug in power and push the SW101 switch 3 seconds and the PCB begin automatic self-examination

# LISTO

## Congélateur Armoire **CAL145-55hob4**

			program, then the led and compressor and fan and defrost heater all work two second and then stop, all wore one time and then quit automatic self-examination program, and the program will return the original setting. If the automatic self-examination program no work, it mean the PCB failure and need change it
		ompressor wire not right or compressor damage	measure the voltage of compressor input connector, if it is OK then check the starting and relay of compressor, also check the wire if it is OK
6	product no any work	the PCB failure	check the power by multimeter, if the input voltage is 220V-240, but the led, compressor, fan, defrost heater are all no work, it mean the PCB failure and need change a new PCB