

Using YOUR TEAPOT

The appliance becomes very hot when it's on and steam escapes through the spout. Never open the lid during the heating cycle and only hold the appliance by the handle.

GETTING STARTED

- Remove all packaging and clean the pot, lids and infuser basket with clean water and washing-up liquid.
- Fill the jug up to the maximum mark and carry out 2 heating cycles with cold water to eliminate any manufacturing residues. Discard the water and rinse.

POSITIONING THE POWER CABLE

Make sure your device is placed on a flat, stable surface, and the power cord is correctly inserted in the rail and the notch under the base of the device.

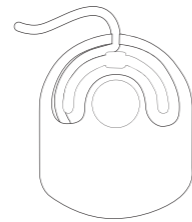

CHOOSING THE COVER

Lid with removable basket for preparing tea: it opens and closes by turning it.



Main lid for heating water: it is inserted above the jug.



1 HEAT SOME WATER

- Remove the lid from the jug and fill it with the desired quantity of water between the "Min" and "Max" marks. Then place the main lid on it.
- Place the jug on its base and plug in the power cord. An audible signal sounds and all the buttons light up for one second and the 100°C light flashes.
- Press the key corresponding to the desired temperature, then press the **⏻** button.
- The heating cycle begins and the temperature button flashes.
- You can interrupt the heating cycle at any point by pressing **⏻**.
- You can also change the required temperature at any time.

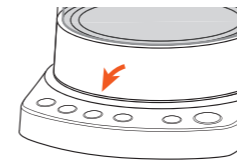

- When the heating cycle is complete, several beeps will sound and the selected temperature button will illuminate continuously.
- Remove the jug from the base and carefully pour out the water.
- **To put the appliance on standby**, completely empty the jug then place it on the base. Press the **⏻** button for approximately 3 seconds until an audible signal is heard and all the indicators go out.
- We recommend you unplug the appliance after use.
- To wake the appliance from standby mode, remove the jug from the base, and a beep sounds.
- Once the jug is placed back on the base, the 100°C light flashes again and the appliance is ready to operate.



Quick start: When the jug is placed on its base and you press the button **⏻** without selecting the temperature, the heating cycle starts automatically until a temperature of 100°C is reached.

2 PREPARING YOUR TEA

- Heat some water as directed in the previous section, depending on the type of tea you want. Make sure not to pour more water than the recommended limit for tea (1 L) indicated on the glass wall, and use the main lid provided to heat the water.



- During the heating cycle, open the infuser basket attached to the tea lid to separate it from its support, then place the desired amount of tea (loose or bags) in it. Reposition the basket on the support.

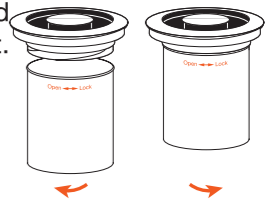

- When the heating cycle is complete, remove the lid from the jug, and place the tea lid with its basket in position. Position the lid so that the basket is submerged in the water. Leave to infuse for the recommended time (see the following table or refer to the recommendations on your tea packaging and/or in our tea guide).



- After infusion, remove the lid and its attached basket to close the jug with the other lid. Empty and unplug the appliance after use, then clean the jug and lid along with the basket quickly.

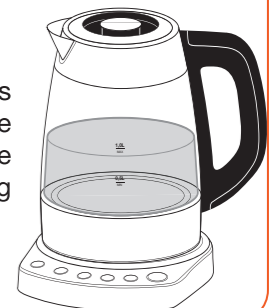

QUANTITIES FOR 1 L OF WATER

WHITE TEA

Not fermented. Low in theine. Facilitates digestion. Sweet, flowery aroma.

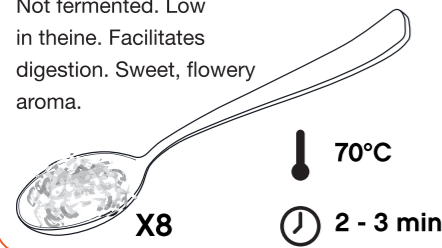

GREEN TEA

Not fermented. Low in theine. Bitter aroma.

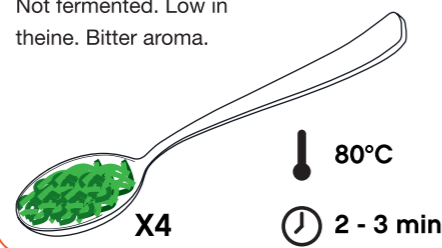

OO LONG TEA

Semi-fermented. Facilitates digestion. Floral aroma without bitterness.

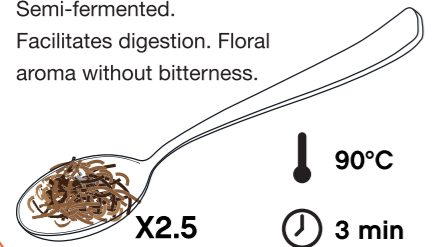

BLACK TEA

Strongly fermented. Strong in theine. Facilitates digestion and blood circulation. Floral, fruity aroma.

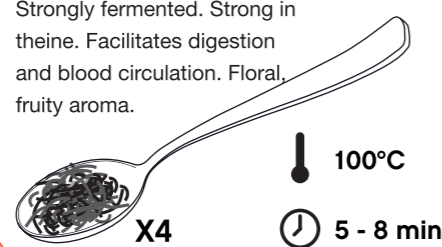

KEEPING IT WARM

- Press and , then the desired temperature to keep the contents of the jug warm for 2 hours. The temperature button flashes, and the and buttons stay lit.
- When the keep-warm temperature is reached, an acoustic signal sounds. The temperature button will flash again.
- Similarly, at the end of the two hours keeping the contents warm, an audible signal sounds.

TEA GUIDE

- You'll find our tea guide* with recipes and advice on our website by following the link below or scanning the QR code: https://boulanger.scene7.com/is/content/Boulanger/3497674181062_n_1



SCAN ME

* Only available in French and Dutch.

Clean AFTER USE



- Always unplug the power cord and allow the appliance to cool down before any cleaning operation.
- Never immerse the jug, base or power cord in water or any other liquid.
- Do not use abrasive detergents or a scouring pad to scrub the inside or outside coating of the appliance.

AFTER USE

- Clean the outside of the jug with a slightly damp sponge.
- Clean the inside of the jug, the lids and infuser basket with hot water and washing-up liquid. Rinse with clear water and allow to dry before placing the jug back on its base.
- Clean the dry base with a soft cloth.

DESCALING

- How often you need to descale will depend on the hardness of the water and frequency of use. Descal your jug regularly to keep it operating smoothly (3 to 4 times a year in normal use).
- Pour 50 cl of water and 40 cl of white vinegar into the jug.
- Boil then leave to act for 15 minutes after the end of the heating cycle.
- Empty the jug then rinse it carefully several times with cold water before using it again. Repeat the descaling cycle if necessary.



Please note: You can also use a specific descaling agent for tea kettles. Follow the manufacturer's instructions, rinse the jug thoroughly then boil water several times after descaling before using the kettle again.



Environmental protection

This symbol on the product means that it is a device whose disposal is subject to the Waste Electrical and Electronic Equipment (WEEE) Regulations. This device cannot therefore be treated as household waste and must be subject to waste collection specific to this type of waste. Collection and recycling services are available through your local council (waste services) and retailers. By disposing of your end-of-life appliance through the appropriate recycling channel, you are helping to protect the environment and will prevent any harmful consequences for your health.



essentiel

Service Relation Clients
Avenue de la Motte
CS 80137
59811 Lesquin cedex

Art. 8010659
Ref. ETE 5
MADE IN PRC
SOURCING & CREATION
Avenue de la Motte
59810 Lesquin - FRANCE



Tested in our laboratories
Warranty valid from the date of purchase (receipt considered proof of purchase). This warranty does not cover defects or damage resulting from incorrect installation, incorrect use, or normal wear and tear of the product.

essentiel



Quick user guide

For easily getting started with your product!

Discovering YOUR ETE 5 TEAPOT

