

essentiel 

Réfrigérateur / Refrigerator

ERLVI180 55miB3



**Vue éclatée / Exploded view**

8011059

# Vue éclatée / Exploded view

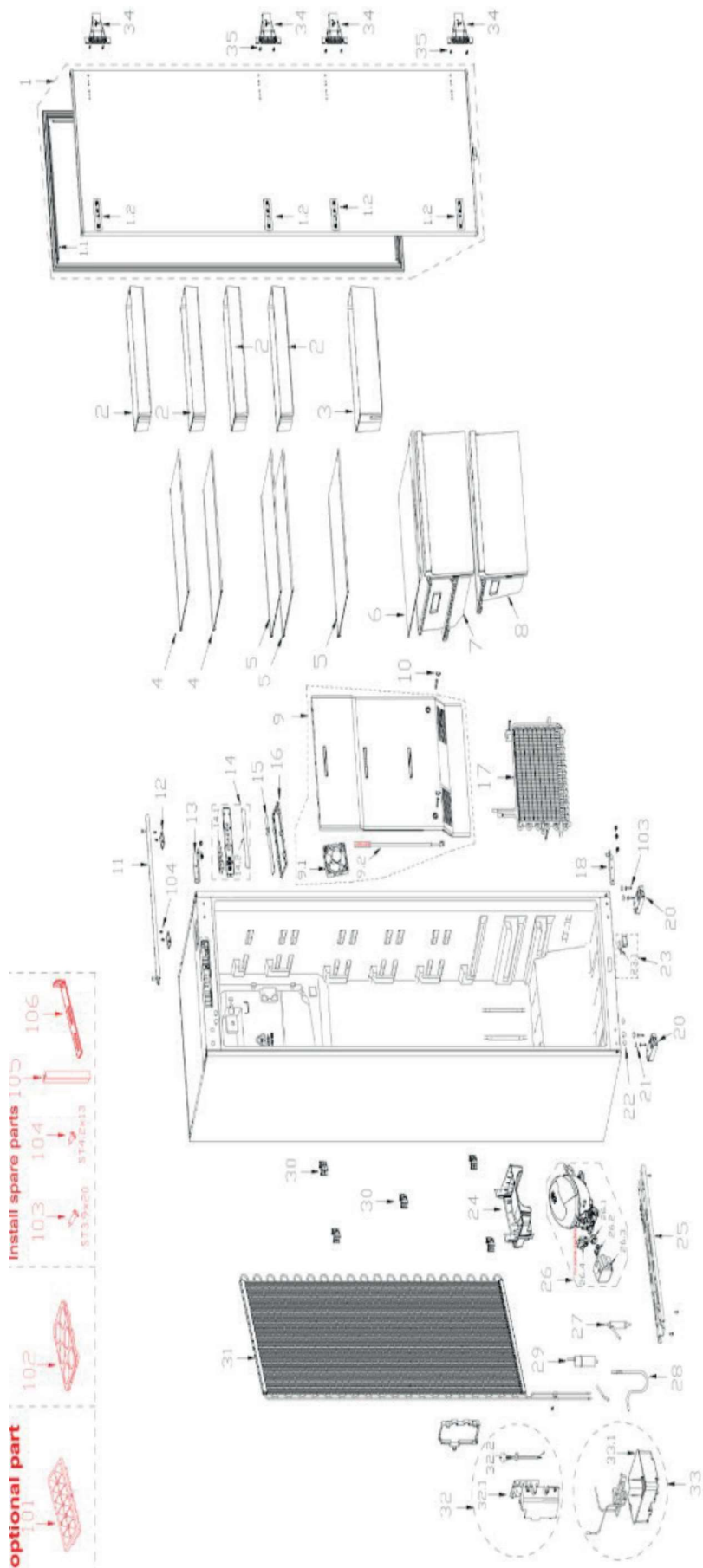

# Liste des pièces détachées / Spare parts list

N° VUE	REFERENCE	DESIGNATION (FR)	DESIGNATION (ENG)	CODE
1	9018770	PORTE (REFRIGERATEUR)	Refrigerator door assembly	1,2831E+13
1.1	9018771	JOINT (PORTE REFRIGERATEUR)	Door gasket assembly of refrigerator	1,2131E+13
1.2	9018710	RAIL CENTRAL	Guide	1,2131E+13
2	9018713	BALCONNET-PETIT	R Small Tray	1,2131E+13
3	9018772	BALCONNET-GRAND	R Large Tray	1,2131E+13
4	9018773	CLAYETTE (REFRIGERATEUR)	Glass shelf assembly of refrigerator	1,2531E+13
5	9018717	CLAYETTE (REFRIGERATEUR)	Glass shelf assembly of refrigerator	1,2531E+13
6	9018774	CLAYETTE (REFRIGERATEUR)	Glass shelf assembly of refrigerator	1,2531E+13
7	9018775	BACA LEGUMES	Fruits and vegetables box component	1,2131E+13
8	9018776	BACA LEGUMES	Fruits and vegetables box component	1,2131E+13
9	9018777	CONDUIT AIR (REFRIGERATEUR)	air duct assembly of refrigerator	1,2131E+13
9.1	9018778	MOTEUR (VENTILATEUR)	Brushless DC Motor	1,1002E+13
9.2	9017513	SONDE (CONDUIT AIR CONGELATEUR)	Temperature Sensor	1,1201E+13
10	9016574	CACHE (VIS)	Screw Cover	1,2131E+13
11	9018763	BUTEE (PORTE)	Limit Block	1,2231E+13
12	9018741	CACHE VIS (CHARNIERE SUPERIEURE)	Screw Cover	1,2131E+13
13	9018721	CHARNIERE SUPERIEURE	Upper Hinge Assembly	1,2231E+13
14	9018779	AFFICHEUR	Display control board mounting box assembly	1,2131E+13
14.1	9018780	CARTE (AFFICHEUR)	Display control panel	1,7131E+13
14.2	9018781	DECO (BANDEAU COMMANDE)	Display control panel surface	1,6031E+13
15	9016798	LAMPE LED	LED lamp	1,7431E+13
16	9016799	CACHE (LAMPE LED SUPERIEURE)	Lamp Cover	1,2131E+13
17	9018782	EVAPORATEUR	Component supplying fin evaporator	1,5831E+13
18	9018743	CHARNIERE INFERIEURE	Lower Hinge Assembly	1,2231E+13
20	9018728	SUPPORT (CHARNIERE INFERIEURE)	Support Assembly	1,2131E+13
21	9018740	CACHE TROU (VIS)	Spout plug	1,2131E+13
22	9007557	CACHE	Insert Pin	1,2131E+13
23	9018783	CACHE LATERAL	Cover assembly	1,2131E+13
23.1	9018784	INTERRUPTEUR MAGNETIQUE	Magnetism switch	1,7431E+13
25	9018739	TRAVERSE (COMPRESSEUR)	Compressor mounting panel assembly	1,2231E+13
26	9018745	COMPRESSEUR	Fixed Speed Reciprocating Compressor	1,1101E+13
26.1	9007563	RELAIS (COMPRESSEUR) QP2-15	Starter	1,2031E+13
26.2	9017476	PROTECTION (COMPRESSEUR)	Protector	1,2031E+13
27	9016169	DESHYDRATEUR	Dry filter	1,5531E+13
28	9011161	TUBE RACCORDEMENT	Suction Connection Tube	1,5531E+13
29	9016568	CONDENSATEUR 2UF-450V	Capacitor	1,7431E+13
30	9018730	PLAQUE FIXATION (EVAPORATEUR)	Fixing Plate	1,2131E+13
31	9018785	EVAPORATEUR	Back hanging wire tube condensor	1,5731E+13
32.1	9018786	CARTE CONTROLE	Main control board	1,7131E+13
32.2	9018733	CABLE ALIMENTATION	European standard power cord	1,7431E+13
34	9018748	CACHE	Plastic cover	1,2131E+13
102	9012702	BACA OEUFS	Egg tray	1,2131E+13
103	9018787	VIS	Screw	1,1303E+13
104	9018742	VIS (PLAQUE FIXATION)	Screw	1,1303E+13
105	9018769	BANDE ETANCHEITE	Sealing Strip	1,2631E+13
32	N/A	PIECES AU DETAIL : 32.1 et/ou 32.2	ORDER 32.1 and/or 32.2	1,7231E+13

Toutes les informations, dessins, croquis et images dans ce document relèvent de la propriété exclusive de SOURCING & CREATION. SOURCING & CREATION se réserve tous les droits relatifs à ses marques, créations et informations. Toute copie ou reproduction, par quelque moyen que ce soit, sera jugée et considérée comme une contrefaçon.

All information, designs, drawings and pictures in this document are the property of SOURCING & CREATION. SOURCING & CREATION reserves all rights to its brands, designs and information. Any copy and reproduction through any means shall be deemed and considered as counterfeiting.