

Congélateur / Freezer

ECAVE185 60mis1



Aide à la réparation / After-sales solutions

8011996

Nomenclature du produit / Bom

Vue éclatée / Exploded view

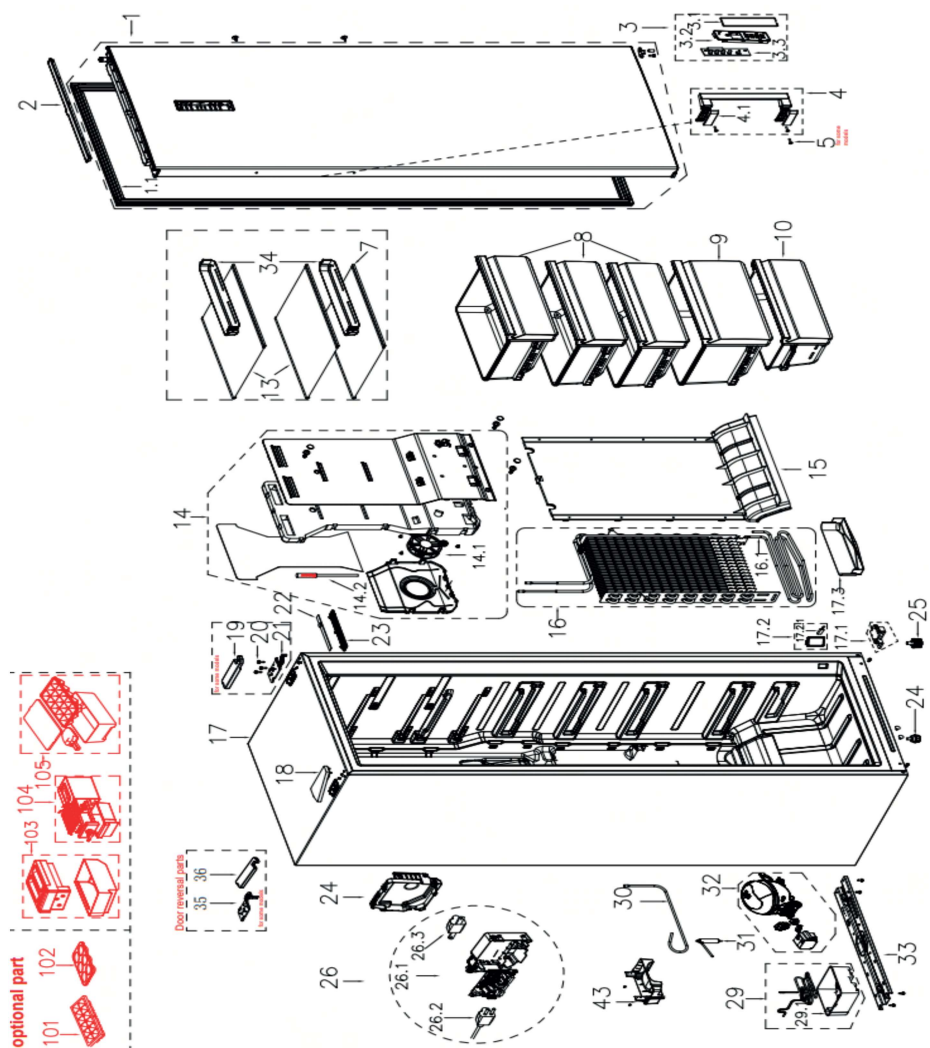

Liste des pièces détachées / Spare parts list

Les pièces détachées, hors liste, repérées sur la vue éclatée, peuvent faire l'objet d'une demande de codification, sous conditions(1)
Spare parts not listed, identified on the exploded view, may be subject to a coding request, under certain conditions(1)
(1) Conditions : productible et livrable par le fabricant / (1) Conditions: producible and deliverable by the manufacturer

N° VUE	REFERENCE	DESIGNATION (FR)	DESIGNATION (ENG)	CODE
1	9028488	PORTE (CONGELATEUR)	Freezer Door Assembly	12831000A16255
1.1	9028489	JOINT (PORTE CONGELATEUR)	Door gasket assembly of refrigerator	12131000086069
2	9016562	CACHE SUPERIEUR (PORTE CONGELATEUR)	End cover plate	12131000033924
3		VOIR/SEE 3.1 ; 3.2 ; 3.3	Display control board mounting box assembly	12131000112832
3.1	9028490	PANNEAU COMMANDE	Display control panel surface	16031000031351
3.2	9028491	BOITIER (AFFICHEUR)	Display control panel	12131000091819
3.3	9028492	CARTE AFFICHEUR	Display control board	17131000020697
4	9028493	POIGNEE	Door handle of freezer compartment	12931000010062
4.1	9028494	DECO (POIGNEE)	Decoration component	12131000082277
7	9028495	CLAYETTE INFERIEURE	Glass shelf	12531000016781
8	9028496	BAC INTERMEDIAIRE	F middle drawer assembly)	12131000086362
9	9028497	BAC SUPERIEUR	F upper drawer assembly	12131000086359
10	9028498	BAC INFERIEUR	F bottom drawer assembly	12131000086361
13	9028499	CLAYETTE SUPERIEURE	Glass shelf	12531000018601
14	9028500	CONDUIT AIR	Air duct assembly of freezer	12131000095498
14.1	9019263	VENTILATEUR ZWF-33-125	Brushless DC Motor	11002015015508
14.2	9006255	SONDE TEMPERATURE	Temperature Sensor	11201007000795
15	9016567	CONDUIT AIR INFERIEUR	Air duct assembly of freezer	12131000085524
16	9028501	EVAPORATEUR	Component supplying fin evaporator	15831000006023
16.1	9028502	RESISTANCE DEGIVRAGE	Defrost Heater	17431000035331
17.1	9028503	CHARNIERE INFERIEURE	Lower hinge assembly	12231000054426
17.2	9014435	CACHE (INTERRUPTEUR MAGNETIQUE)	Cover assembly	12131000058031
17.2.1	9014431	INTERRUPTEUR MAGNETIQUE	Magnetic Switch	17431000000121
17.3	9014103	BAC RECUPERATEUR	Drain tray	12231000021201
18	9011440	Cache (charniere gauche)	Hinge cover	12131000014610
19	9028504	CACHE (HARNIERE SUPERIEURE DROITE)	Hinge cover	12131000033923
20	9011158	VIS GBT6563 M5x16-F 1018A	Screw	11303305000004
21	9014105	CHARNIERE SUPERIEURE DROITE	Upper Hinge	12231000021322
22	9016798	CARTE (LAMPE LED)	LED lamp	17431000009581
23	9016799	COUVERCLE (LAMPE)	Lamp Cover	12131000087220
24	9011410	Pied ajustable	Levelling feet	12131000001014
25	9014106	Pied ajustable	Levelling feet	12131000000986
26	NR	Non référencé / Not referenced	Main control board assembly	17231000009721
26.1	9028505	CARTE COMMANDE	Main Control Board	17131000031903
26.2	9012873	CABLE ALIMENTATION 1.8M NOIR	European standard power cord	17431000033915
26.3	9028482	FILTRE ANTI PARASITE	Power filter	17431000045350
29	9028506	RACCORDEMENT (TUBE)	Component supplying pipe connector	15531000014648
29.1	9011413	BAC RECUPERATEUR	Drain tray	12131000004270
30	9016571	TUBE RACCORDEMENT	Suction connection tube	15531000001361
31	9011162	DESHYDRATEUR	Dry filter	15531000000622
32	9028507	COMPRESSEUR INVERTER HVM58ME	DC Inverter Reciprocating Compressor	11101020010004
33	9011412	Traverse (compresseur)	Compressor mounting panel assembly	12231000005876
34	9028508	BALCONNET	F large tray	12131000087224
35	9014112	CHARNIERE (INVERSION PORTE)	Upper Hinge	12231000021321
36	9028509	CACHE (CHARNIERE INVERSION PORTE)	Hinge cover	12131000033921
43	9011417	BAC RECUPERATEUR	Drip Tray	12131000004386
101	9012703	BAC A GLACONS	Ice box	12131000000170