

# BRAUN

## Series 6

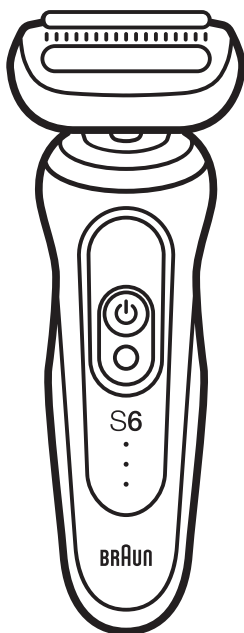

90486798/VII-23



Scan Me!



1 Foil & cutter cassette 64B

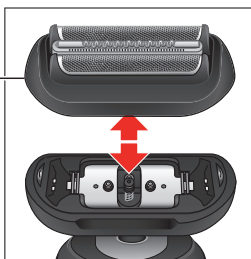

2 On/off button

3 Mode button

4 Display



Turbo mode



Foil replacement



Travel lock



Cleaning station indicator



Low charge / cordless use indicator



Status bar

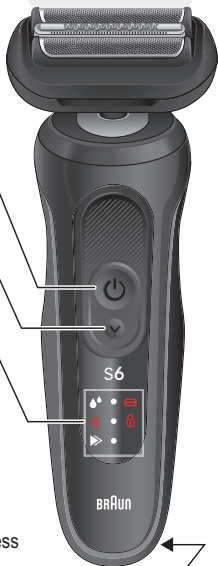

5 Power socket

8\* Protective cap



7\* Pouch



\* dependent on model

6 Power supply



9 Precision trimmer



02 - PT\*

10 Beard trimmer with combs  
(1/2/3/5/7 mm)



05 - BT\*



11 Body trimmer with combs  
(1 mm (sensitive)/3 mm)



06 - BDT\*

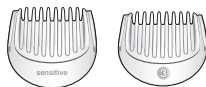

12 3-day beard trimmer  
(0.5 - 2.3 mm)



08 - 3DBT\*

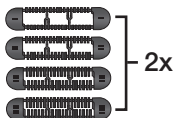

13 Facial cleansing brush  
with protective cap

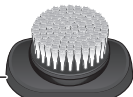

03 - BR\*



\* dependent on model

14\* Charging stand



Type  
5439

15\* Cleaning station



Type  
5434

A.

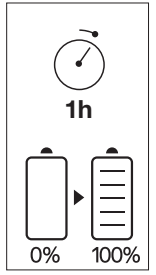
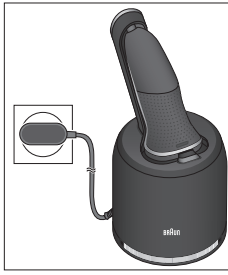
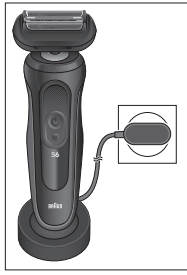
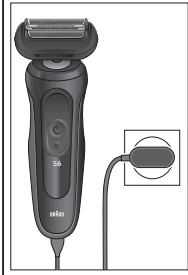

B.

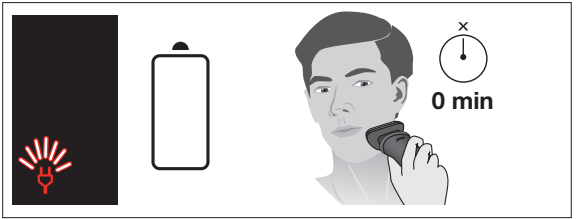
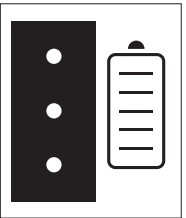
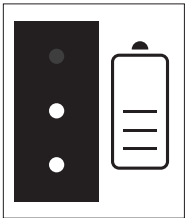
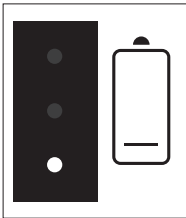

C.



a.

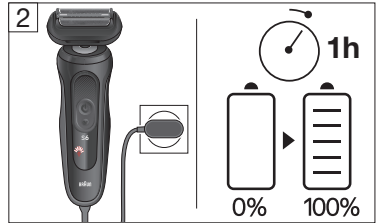
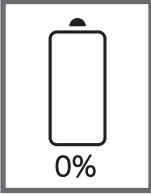

b.

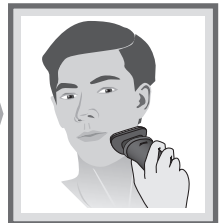
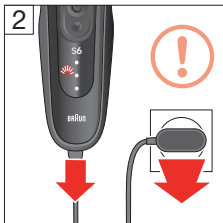
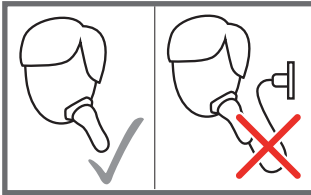

D.

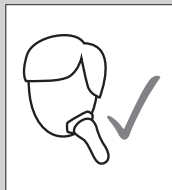

D.I

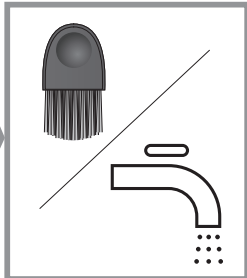
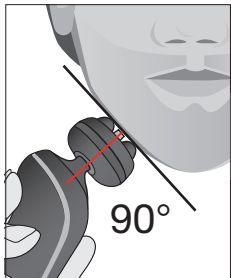
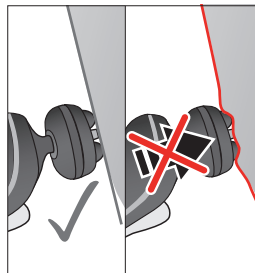
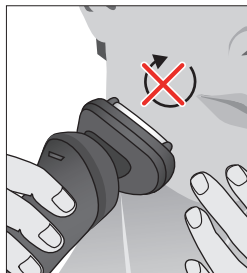
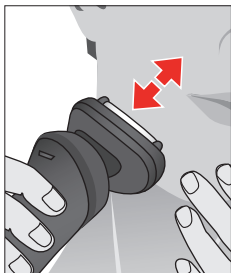
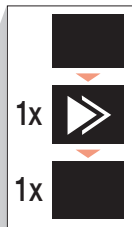
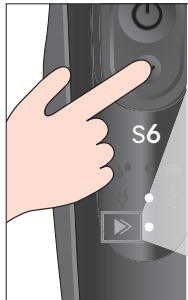

D.II



02 - PT



05 - BT



06 - BDT



08 - 3DBT

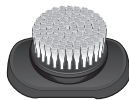

03 - BR

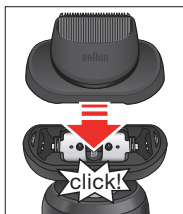
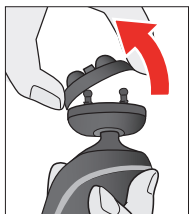

02 - PT



05 - BT

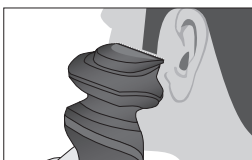

05 - BT



1mm



2mm



3mm



5mm



7mm

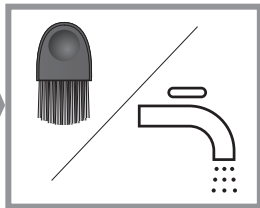
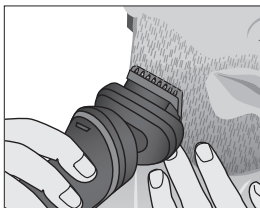
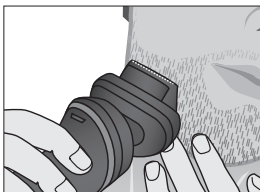



06 - BDT



3 mm



1 mm  
(sensitive)

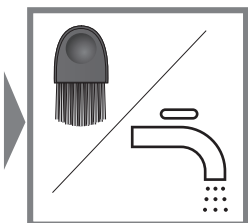
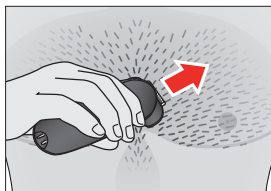

06 - BDT

+



1 mm  
(sensitive)

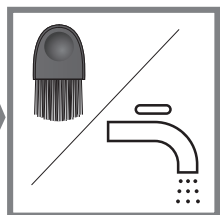
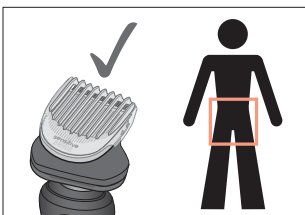
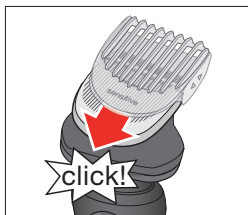





08-3DBT



0,5-2,3 mm

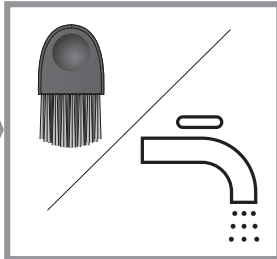
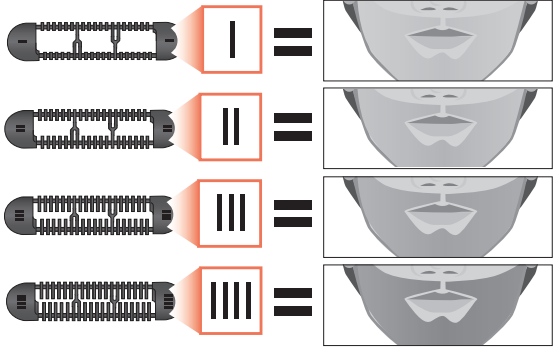

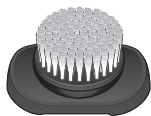

03 - BR

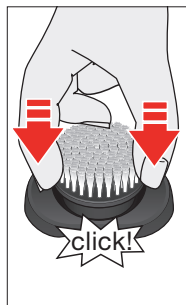
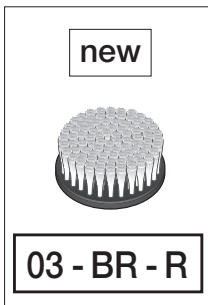
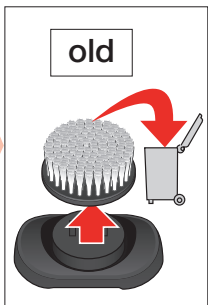
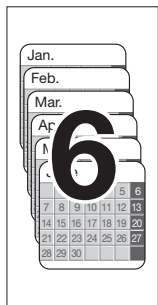
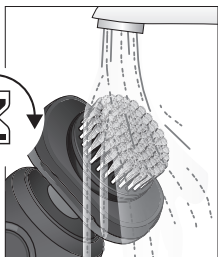
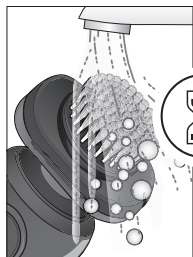
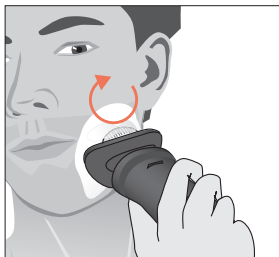
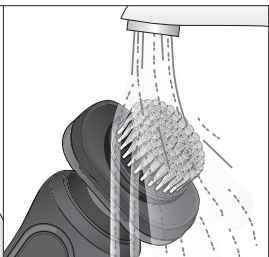
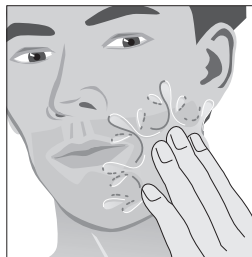

E.

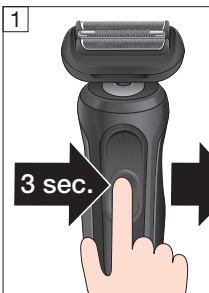

F.

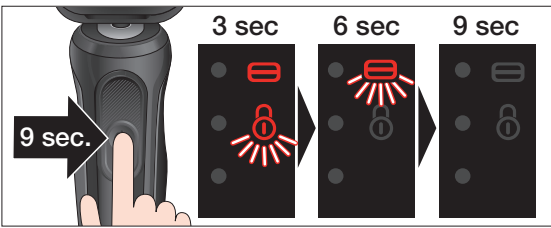
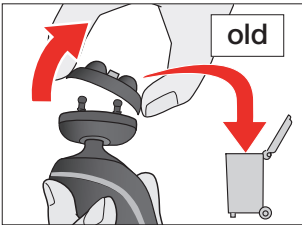

G.

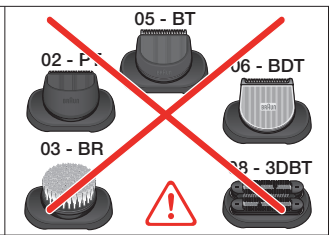

H.

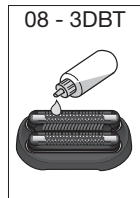
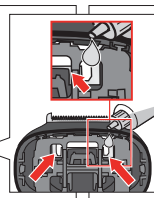
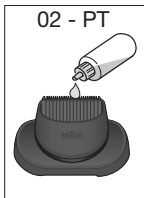
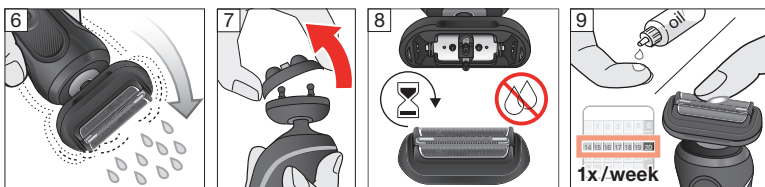
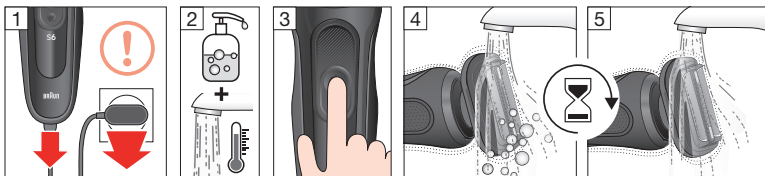

I.

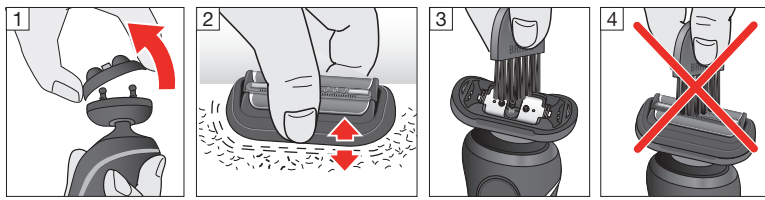
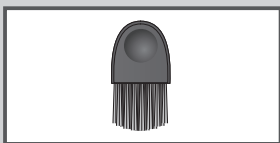

J.



[www.service.braun.com](http://www.service.braun.com)



**BRAUN**  
Service



old



new



## English

Read these instructions completely, they contain safety information. Keep them for future reference.

### Warning



This appliance is suitable for cleaning under running water and use in a bathtub or shower. **For safety reasons, it can only be operated cordless.**

Detach the shaver from the power supply before using it with water.

Keep power supply, charging stand and cleaning station dry.

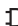
This appliance is provided with a Safety Extra Low Voltage plug-in power supply. To avoid risk of electric shock, do not exchange or tamper with any part of it. Only use the provided Braun power supply type  492.

Do not use if the appliance or any attachment is damaged. Do not open the appliance!

The built-in rechargeable batteries can only be replaced by an authorized Braun Service center.

This appliance can be used by children aged from 8 years and persons with reduced physical, sensory or mental capabilities or lack of experience and knowledge if they have been given supervision

or instruction concerning use of the appliance in a safe way and understand the hazards involved.

If the appliance is provided with a hair clipping attachment, it can be used for hair clipping purpose by children aged from 3 years under supervision.

Children shall not play with the appliance. Cleaning and user maintenance shall not be made by children without supervision.

### Caution

Recommended ambient temperature for charging is 5 °C to 35 °C, for storage and shaving it is 15 °C to 35 °C.

Do not expose the appliance to temperatures higher than 50 °C for extended periods of time. The brush (03-BR) must not be used on damaged or irritated skin or on wounds.

If skin irritation occurs, discontinue use.

Avoid direct contact with eyes and hairline.

The body trimmer (06-BDT) must only be used with comb attachment in delicate areas.

Only use the appliance for its intended purpose. For hygienic reasons, do not share this appliance with other persons.

### How to shave

Position the shaver head at 90° angle to your skin that all shaving elements have full skin contact.

Shave against the direction of your beard growth in straight back and forth movements.

### How to clean

The foil & cutter cassette needs cleaning under hot running water after each foam or gel usage!

Switch the shaver on and rinse until all residues have been removed.

With regular wet cleaning, apply a drop of light machine oil (not included) onto the Foil & Cutter cassette / trimmer head once a week.

The brush (03-BR) needs to be cleaned under cool running water after each usage!

Product contains batteries and / or recyclable electric waste. For environment protection, do not dispose of in household waste, but for recycling take to electric waste collection points provided in your country.



Subject to change without notice.

## Description

- 1 Foil & cutter cassette 64B
- 2 On/off button
- 3 Mode button  
> Shave mode (Shaver on)  
To choose the preferred shave mode:
  - Standard mode
  - Turbo modeThe last selected shave mode is saved.
- 4 Display
  - Turbo mode
  - Foil replacement indicator
  - Travel lock indicator
  - Cleaning station indicator
  - Low charge / cordless use indicator
  - Status LED / Battery indicator
- 5 Power socket
- 6 Power supply
- 7 Pouch
- 8 Protective cap
- 9 Precision trimmer 02-PT
- 10 Beard trimmer 05-BT  
with combs (1/2/3/5/7 mm)
- 11 Body trimmer 06-BDT  
with combs (1 mm = sensitive / 3 mm)
- 12 3-day beard trimmer 08-3DBT for an even 3-day beard look  
with 4 x 2 combs (0,5 – 2,3 mm)
- 13 Facial cleansing brush 03-BR  
with protective cap
- 14 Charging stand
- 15 Cleaning station  
(description in separate UI)

**Note:** Content / availability of attachments may vary by model / country.

## Usage illustrations

- A./B. Charging / Battery
- C. a. Low charge / b. Cordless use
- D. Usage
- D.I Shaving
- D.II Usage of attachments
- E. Travel lock
- F. Foil replacement
- G. Automatic cleaning
- H./I. Manual cleaning
- J. Battery replacement

## Français

**Lire attentivement ces instructions car elles contiennent des informations sur la sécurité. À conserver pour toute consultation ultérieure.**

## AVERTISSEMENTS



Cet appareil peut être nettoyé sous l'eau courante et utilisé dans le bain ou sous la douche. **Pour des raisons de sécurité, l'appareil ne peut être utilisé que sans fil.** Débranchez le rasoir de l'alimentation électrique avant de le nettoyer à l'eau.

Conserver le bloc d'alimentation, la base de recharge et la station de nettoyage au sec.

Cet appareil est fourni avec un bloc d'alimentation électrique à Très Basse Tension de Sécurité à brancher sur secteur. Afin d'éviter tout risque de choc électrique, ne remplacez ou ne modifiez aucune partie du câble. Utilisez uniquement