

Quick Start Guide

Download the **full user manual** at:
www.philips.com/support and register
 your product for further support

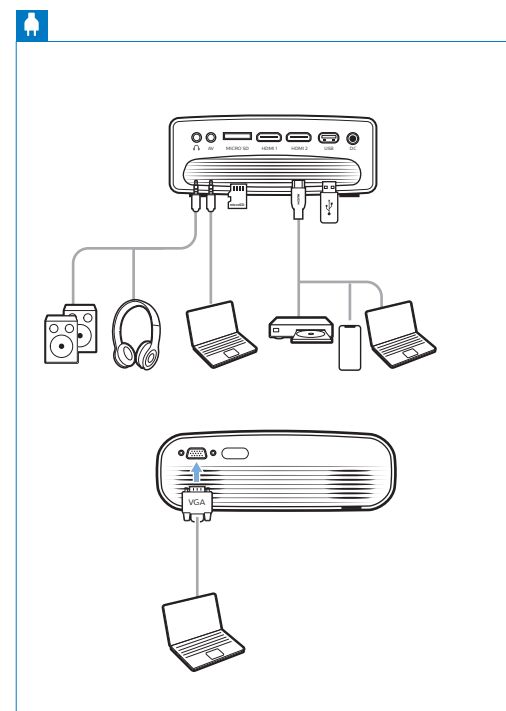

Support Page



Screeneo Innovation SA
 Route de Lully 5C
 1131 - Tolochenaz - Switzerland
www.philips.com/welcome
philips.projector.eu@screeneo.com

Philips and the Philips Shield Emblem are registered trademarks of Koninklijke Philips N.V. and are used under license. Screeneo Innovation SA is the warrantor in relation to the product with which this booklet was packaged.

2021 © Screeneo Innovation SA
 All right reserved

FCC ID 2ASRT-NPX645
 This device complies with part 15 of the FCC Rules. Operation is subject to the following two conditions: (1) This device may not cause harmful interference, and (2) this device must accept any interference received, including interference that may cause undesired operation.

7 ▶ Adjustment knob

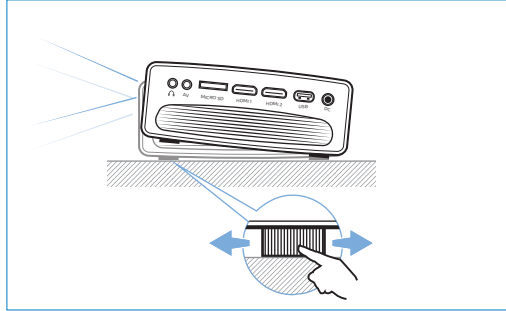

8 ▶ Keys

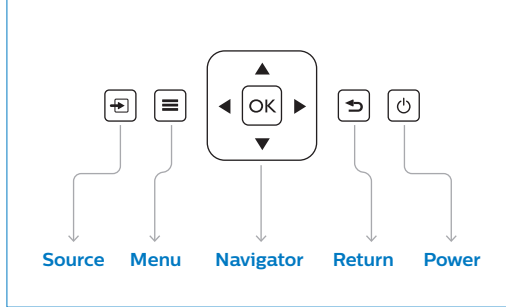

9 ▶ Android TV Dongle remote control

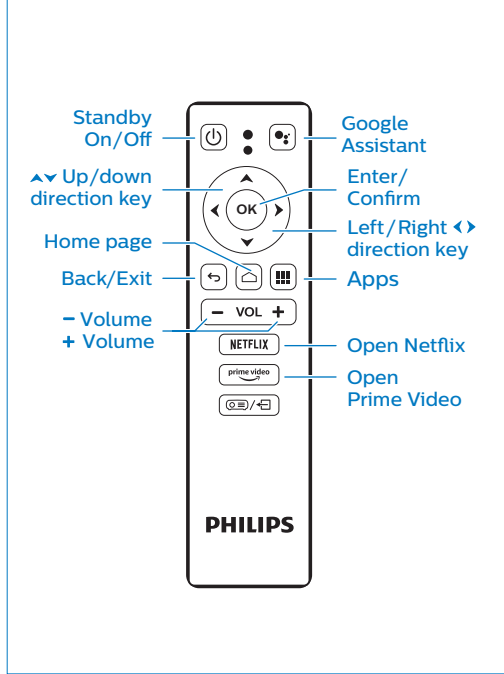

10 ▶ Android TV Navigation

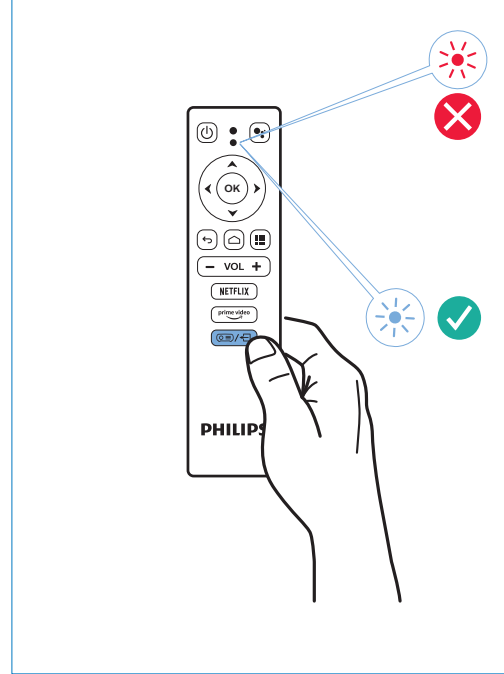

10 ▶ Projector remote control

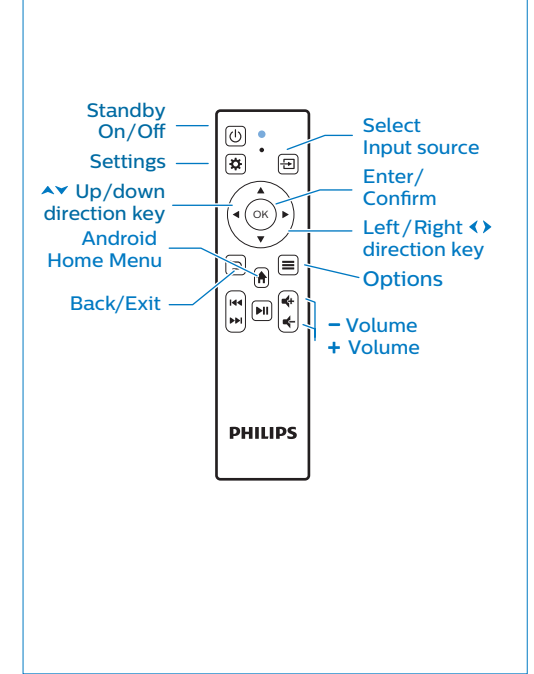

▶ Access to Android TV

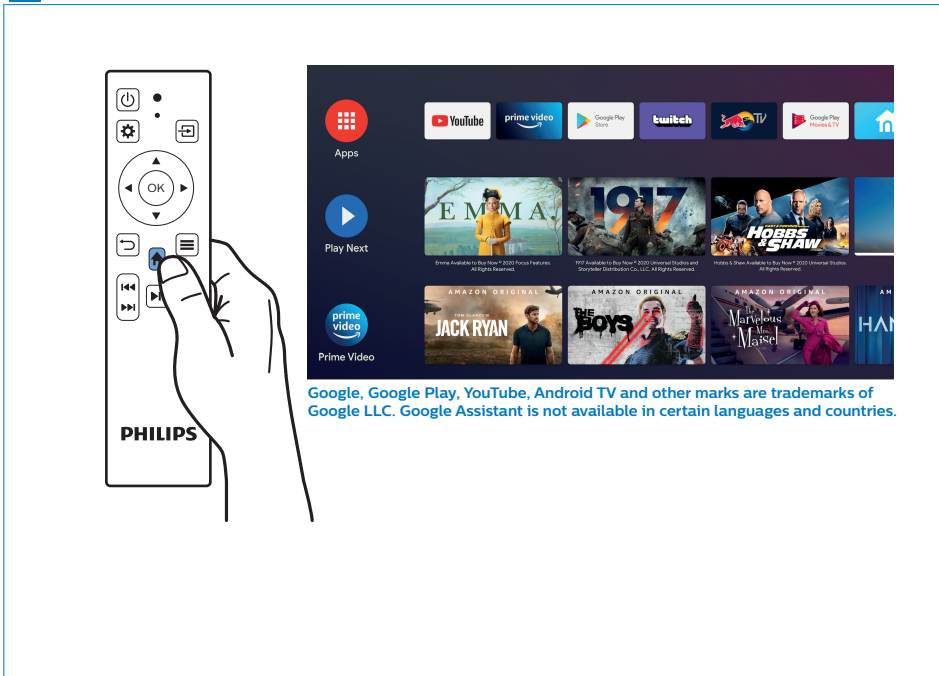

▶ Bluetooth speaker

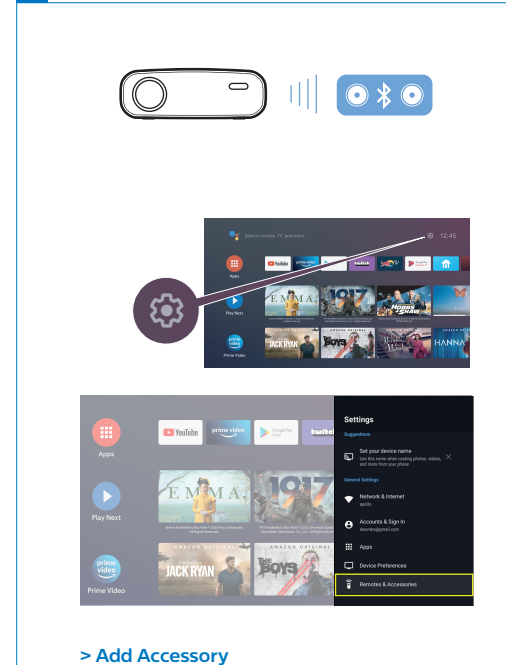

▶ Connecting phones/tablets to HDMI

