

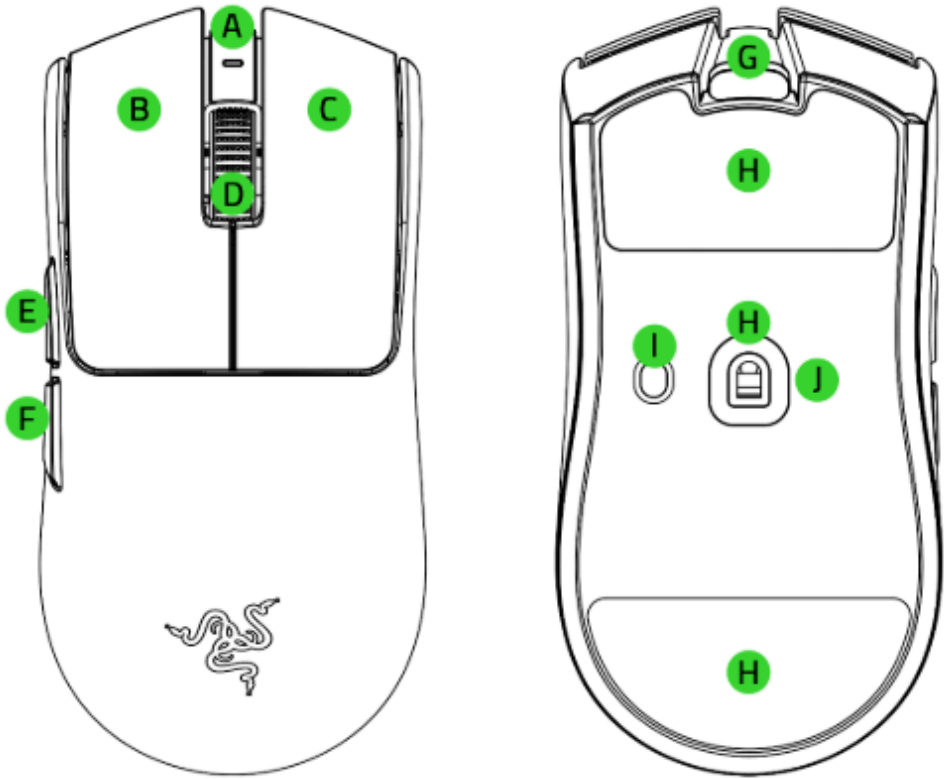

Device Layout



- A. Mouse indicator LED

B. Left mouse button

C. Right mouse button

D. Scroll wheel

E. Mouse button 5
- F. Mouse button 4

G. USB Type C port (mouse)

H. PTFE mouse feet

I. Power / DPI cycle button\*

J. Razer™ Focus Pro 35K Optical Sensor Gen-2

Full Technical Specifications

Category	Specification
Variation	Razer Viper V3 Pro
Sensitivity	35,000 Max Sensitivity (DPI)
Acceleration	Up to 750 inches per second (IPS) / 70 G acceleration
Sensor	Focus Pro Optical Sensor Gen-2
Switch Type	Optical Mouse Switches Gen-3
Razer Synapse Support	Yes
Razer Chroma	No
Polling Rate	HyperPolling 8000 Hz Technology
Connectivity	Wired and 2.4 GHz dongle Wireless usage modes
Form Factor	Right-handed symmetrical
Programmable Controls	8
Dock Compatibility	No
Cable Type	USB Type-A to USB Type-C cable
Mouse Feet	100% PTFE
Battery Life	<div><div>• Up to 95 hours at 1000 Hz</div><div>• Up to 62 hours at 2000 Hz</div><div>• Up to 40 hours at 4000 Hz</div><div>• Up to 17 hours at 8000 Hz</div></div>

Approx. Dimensions	<ul style="list-style-type: none"><li>Length: 127.1 mm / 5.00 in</li><li>Width: 63.9 mm / 2.51 in</li><li>Height: 39.9 mm / 1.57 in</li></ul>
Approx. Weight	54 g (Black) and 55 g (White)
Available Colors	<ul style="list-style-type: none"><li>Black</li><li>White</li><li>Gengar Edition (China only)</li><li>Faker Edition</li></ul>



RAZER INSIDER

Have a question? Ask the Razer Community for help! (English only)

ENTER INSIDER



NEED HELP?

Get support by phone, chat, or email

CONTACT SUPPORT